

Register your product and get support at
www.philips.com/welcome

This product comes with
**Premium
Home Service**
Refer to the inside page for details.



HDR3800
HDR3810

EN	HDD/ DVD Recorder	4
----	-------------------	---

PHILIPS

Premium Home Service

United Kingdom, Ireland

Dear valued customer,

Thank you for buying a Philips DVD Recorder.
Your product comes with the Philips 'Premium Home Service' warranty.

Should you require any assistance in operating your set, Philips offers you professional support via:

Philips Support Center website

www.philips.com/support

or

Philips Consumer Care Helpline *

where our trained representatives will guide you, step-by-step, to solve any issues you have.

If we are unable to provide a solution, Philips will be pleased to pick-up your DVD Recorder from your home; and provide a service replacement set, within 7 days. That's the Philips 'Premium Home Service' commitment to you. This service comes free-of-charge (except for Consumer Care Helpline) and applies to all Philips DVD Recorders during the Philips warranty period.

For more information, please contact a representative via the Philips Consumer Care Helpline.

* Refer to the back page of this manual for the Philips Customer Care phone number in your country.
Please have with you the model number, serial number and purchase date of your product when contacting Philips Customer Care.

Italia
DICHIARAZIONE DI CONFORMITA'

Si dichiara che l'apparecchio HDR3800, HDR3810, Philips risponde alle prescrizioni dell'art. 2 comma 1 del D.M. 28 Agosto 1995 n. 548. Fatto a Eindhoven

Philips Consumer Electronics
Philips, Glaslaan 2
5616 JB Eindhoven,
The Netherlands

Norge

Typeskilt finnes på apparatens underside.

Observer: Nettbryteren er sekundert innkoplet. Den innebygde nettdelen er derfor ikke frakoplet nettet så lenge apparatet er tilsluttet nettkontakten.

For å redusere faren for brann eller elektrisk støt, skal apparatet ikke utsettes for regn eller fuktighet.

Due to the inconsistency of disc formats provided by various disc manufacturers, your DVD system/ player/recorder may require a playability enhancement or upgrade. As DVD technology advances, these enhancement will become common and will be easy to complete. Go to www.philips.com/support for software upgrade.

'CONSUMERS SHOULD NOTE THAT NOT ALL HIGH DEFINITION TELEVISION SETS ARE FULLY COMPATIBLE WITH THIS PRODUCT AND MAY CAUSE ARTIFACTS TO BE DISPLAYED IN THE PICTURE. IN CASE OF 525 OR 625 PROGRESSIVE SCAN PICTURE PROBLEMS, IT IS RECOMMENDED THAT THE USER SWITCH THE CONNECTION TO THE 'STANDARD DEFINITION' OUTPUT. IF THERE ARE QUESTIONS REGARDING OUR TV SET COMPATIBILITY WITH THIS MODEL 525p AND 625p DVD PLAYER, PLEASE CONTACT OUR CUSTOMER SERVICE CENTER.'

Ensure the power outlet is always within reach. If abnormal situations occur, fully disconnect power: unplug the power cord from the power outlet.

LASER

Type	Semiconductor laser InGaAlP (DVD) AlGaAs (CD)
Wave length	658 nm (DVD) 90 nm (CD)
Output Power	30 mW (DVD+RW write) 1.0 mW (DVD read) 1.0 mW (CD read)
Beam divergence	84 degrees (DVD) 61 degrees (CD)

For Customer Use:

Read carefully the information located at the bottom or rear of your DVD Recorder and enter below the Serial No. Retain this information for future reference.

Model No. HDD/ DVD RECORDER
 HDR3800/ HDR3810
Serial No. _____

Contents

1 Important	6
Safety	6
Notice	6

2 Your product	9
Region codes	9
Features highlight	9
Product Overview	11

3 Connect	14
Place the unit	14
Connect antenna or cable	14
Connect video/audio cables	15
Connect other devices	17

4 Get Started	21
Prepare the remote control	21
First Time Settings	22
GUIDE Plus+ Setup	24

5 Watch live TV	26
Watch live TV through your recorder	26
About Time Shift Buffer - temporary	
HDD storage	26
Control live TV	27
Clear the Time Shift Buffer	27

6 Use GUIDE Plus+	28
GUIDE Plus+ menu options	28

7 Record	32
Before you record	32
Record settings	33
Record live TV	35
Schedule a timer recording	36
Record from other devices	40
Simultaneous record and play	42

8 Play	43
Play recorded TV programmes	43
Play from media storage	44
Play from USB	45
Play from disc	46
Play video	47
Play music	51
View photos	53

9 Edit Recordings	55
Edit titles in the hard disk	55
Manage titles by genre	58
Edit titles on a recordable DVD	60
Play your recordings on other players	64

10 Copy Files	65
Copy recorded titles	65
Copy data files	65

11 Adjust Settings	67
Tuner Settings	67
Disc Settings	69
Playback Settings	71
Recording Settings	73
Audio Settings	73
Video Settings	75
System settings	75
Manage Easylink settings	78
Adjust HDMI video and audio	79

12 Additional Information	80
Upgrade software	80
Care	81
About DivX subtitle font	81
TV System Guide	82
Specifications	84
Display panel symbols/ messages	85

13 Troubleshooting	86
---------------------------	-----------

14 Glossary	90
--------------------	-----------

1 Important

Safety

Warning!

Risk of fire or electric shock!

- Ensure that air can circulate freely through the ventilation holes on this unit. Allow at least 5~10 cm clearance around the unit.
- Never expose this unit to direct sunlight, naked flames or heat.
- Never place this unit on another electrical equipment.
- Keep away from this unit during lightning storms.
- Never remove the casing of this unit. Please leave all maintenance work to qualified personnel.
- Keep this unit away from water, moisture and liquid-filled objects.
- This unit employs a laser. Due to possible eye injury, only a qualified service person should remove the cover or attempt to service this device.
- Install this unit near the AC outlet and where the AC power plug can be reached easily.

Caution!

- Remove batteries if they are exhausted or if the remote control is not to be used for a long time.
- Do not mix batteries (old and new or carbon and alkaline, etc.).
- Batteries contain chemical substances, they should be disposed of properly.
- Visible and invisible laser radiation when open. Avoid exposure to beam.
- Use of controls or adjustments on performance of procedures other than herein may result in hazardous radiation exposure or other unsafe operation.

Note

- Refer to the type plate at the rear or bottom of the product for identification and supply ratings.

Notice

Recycle notice



Disposal of your old product. Your product is designed and manufactured with high quality materials and components, which can be recycled and reused. When this crossed-out wheeled bin symbol is attached to a product it means the product is covered by the European Directive 2002/96/EC. Please inform yourself about the local separate collection system for electrical and electronic products.

Please act according to your local rules and do not dispose of your old products with your normal household waste. The correct disposal of your old product will help prevent potential negative consequences for the environment and human health.

Copyright notice

 **Be responsible
Respect copyrights**

The making of unauthorised copies of copy-protected material, including computer programmes, files, broadcasts and sound recordings, may be infringement of copyrights and constitute a criminal offence. This unit should not be used for such purpose.

**CLASS 1
LASER PRODUCT**

Important notes for users in U.K.

Mains plug

This apparatus is fitted with an approved 13 Amp plug. To change a fuse in this type of plug proceed as follows:

- 1 Remove fuse cover and fuse.
- 2 Fix new fuse which should be a BS1362 5 Amp, A.S.T.A. or BSI approved type.
- 3 Refit the fuse cover.

If the fitted plug is not suitable for your socket outlets, it should be cut off and an appropriate plug fitted in its place.

If the mains plug contains a fuse, this should have a value of 5 Amp. If a plug without a fuse is used, the fuse at the distribution board should not be greater than 5 Amp.

Note: The severed plug must be disposed off to avoid a possible shock hazard should it be inserted into a 13 Amp socket elsewhere.

How to connect a plug

The wires in the mains lead are coloured with the following code: blue = neutral (N), brown = live (L).

As these colours may not correspond with the colour markings identifying the terminals in your plug, proceed as follows:

- Connect the blue wire to the terminal marked N or coloured black.
- Connect the brown wire to the terminal marked L or coloured red.
- Do not connect either wire to the earth terminal in the plug, marked E (or e) or coloured green (or green and yellow).

Before replacing the plug cover, make certain that the cord grip is clamped over the sheath of the lead - not simply over the two wires.

Copyright in the U.K.

Recording and playback of material may require consent. See Copyright Act 1956 and The Performer's Protection Acts 1958 to 1972.

Trademark notice



GUIDE Plus+, SHOWVIEW, VIDEO Plus+, G-LINK are (1) registered trademarks or trademarks of, (2) manufactured under license from and (3) subject to various international patents and patents applications owned by, or licensed to, Gemstar-TV Guide International, Inc. and/or its related affiliates.

GEMSTAR-TV GUIDE INTERNATIONAL, INC. AND/OR ITS RELATED AFFILIATES ARE NOT IN ANY WAY LIABLE FOR THE ACCURACY OF THE PROGRAM SCHEDULE INFORMATION PROVIDED BY THE GUIDE PLUS+ SYSTEM. IN NO EVENT SHALL GEMSTAR-TV GUIDE INTERNATIONAL, INC. AND/OR ITS RELATED AFFILIATES BE LIABLE FOR ANY AMOUNTS REPRESENTING LOSS OF PROFITS, LOSS OF BUSINESS, OR INDIRECT, SPECIAL, OR CONSEQUENTIAL DAMAGES IN CONNECTION WITH THE PROVISION OR USE OF ANY INFORMATION, EQUIPMENT OR SERVICES RELATING TO THE GUIDE PLUS+ SYSTEM.

This product incorporates copyright protection technology that is protected by US patents. Use of this copyright protection technology must be authorised by Macrovision, and is intended for home and other limited viewing uses only unless otherwise authorised by Macrovision. Reverse engineering or disassembly is prohibited.



HDMI, and HDMI logo and High-Definition Multimedia Interface are trademarks or registered trademarks of HDMI licensing LLC.



Manufactured under license from Dolby Laboratories. "Dolby" and the double-D symbol are trademarks of Dolby Laboratories.



DivX Ultra Certified products: DivX, DivX Ultra Certified, and associated logos are trademarks of DivX, Inc. and are used under license.



i.Link is also known as 'FireWire' and 'IEEE1394'. This connection is to transfer high bandwidth digital signals used by digital video (DV) camcorders. It carries all audio and video signals through a single cable.



This product complies with the radio interference requirements of the European Community.

This product complies with the requirements of the following directives: 2006/95/EC + 2004/108/EC.

2 Your product

Congratulations on your purchase and welcome to Philips! To benefit from the support that Philips offers, register your product at www.philips.com/welcome.

Recording has never been easier, you can now record up to 135 or 230 hours of video in SLP (Super Long Play) recording mode.

Model	Hard Disk Drive (HDD)	Maximum hours of recording
HDR3800	160 GB	135
HDR3810	250 GB	230



Note

- Ensure the recorder is connected to the power supply unless you do not intend to use this product for a long period of time. Power supply is needed for the recorder to perform tasks like timer recordings and automatic system time and date update.

Region codes

DVD films are usually not released at the same time in all regions of the world, thus all DVD players are keyed to a specific region code.



This device will only play Region 2 DVDs or DVDs manufactured to be played in all regions ('ALL'). DVDs from other regions cannot be played on this recorder.

Features highlight

Pause Live TV

You can pause any live TV programme by pressing the PAUSE LIVE TV button. Resume play by pressing the PAUSE LIVE TV button again. You can now continue watching the remainder of the programme or if you want to return to the live TV programme again, just press the LIVE TV button.

Instant Replay

You can repeat any scene of a live TV programme by pressing the left button on the remote control. To return to live TV programme, press the LIVE TV button.

FlexTime

With FlexTime, you watch a TV programme while it is recorded. You do not need to wait for the recording to finish to watch it. You can also watch a title recorded earlier, play a DVD or DivX movie or even enjoy some music during recording.

Time Shift Buffer (TSB)

Once you turn on the recorder, the Time Shift Buffer stores the TV channel it is tuned to. It can store up to 6 (six) hour of TV programmes and automatically removes anything that is older. You can also mark a section of the TSB and copy it to your hard disk to view later.

Media Jukebox

The Media Jukebox stores media files (video, music and photos). These files are stored according to its media type.

G-LINK transmitter

You can control the external receiver (e.g., satellite receiver, cable box) for timer recording through the GUIDE Plus+ system. Record TV programmes received through the external receiver.

Enhanced USB upgrade

You can get information and upgrade the software from a USB flash drive.

EasyLink

EasyLink uses the HDMI CEC (Consumer Electronics Control) industry standard protocol to share functionality with all HDMI CEC compliant devices over HDMI. It enables the connected devices to control each other with a single remote control.



Note

- Philips does not guarantee 100% interoperability with all HDMI-CEC devices.

One touch play

When you press **PAUSE LIVE TV** to turn on this unit and start disc play (if a video disc is found in the disc compartment), it turns on your TV automatically and switches to the correct viewing channel.

One touch power off



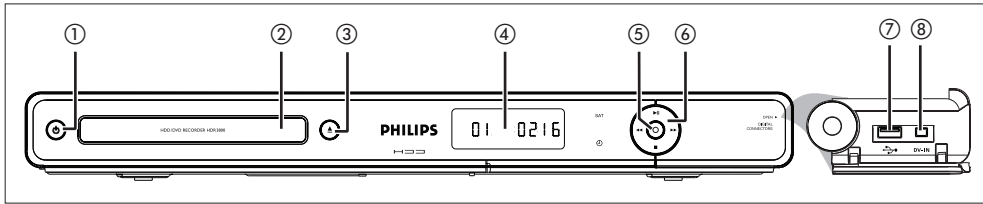

This unit responds to the standby command from other HDMI CEC compliant TV/devices. For example, if you turn off the TV, this unit automatically turns off to standby even during playback.

- To power off this unit, you have to press and hold .

Product Overview



Main Unit

- ①  (Standby-on)
 - Turns on this unit or switches to standby mode.
- ② **Disc tray**
- ③  (Open/Close)
 - Opens or closes the disc tray.
- ④ **System display panel**
 - Displays information about the current status of the recorder.
- ⑤  (Record)
 - Starts recording the current TV channel or the current video source.
 - Press repeatedly to set the recording length in 30-minute increments.
 - Indicator lights up during recording.
- ⑥ 
 - Starts play or resumes recording.
 - Pauses play or recording.



 - Press to make a forward/ reverse search.

 (Stop)

 - Stops play or recording.

Note

- These connections are located under the flap on the right corner of the front panel.

- ⑦  **USB**
 - To connect a USB device, USB card reader or digital camera.
 - To view this source, press **USB**.
 - Only brands and models of digital cameras which support USB Mass Storage Device class standard are supported.
- ⑧ **DV-IN**
 - To connect a digital camcorder or suitable device.

Remote Control

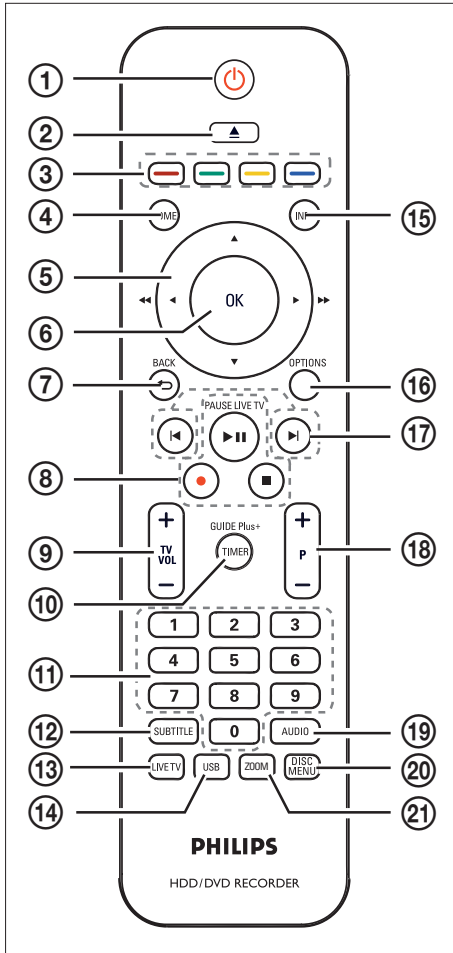

- ① (Standby-On)
 - Turns on the recorder or switches to standby mode.
- ② (Open/Close)
 - Opens or closes the disc tray.
- ③ **Coloured coded buttons**
 - Buttons to select the coloured options available in some menus.
- ④ **HOME**
 - Enters or exits the Home menu.
- ⑤ :
 - Cursor buttons to move left or right.
 - Press and hold to fast reverse or fast forward search.
- :
 - Cursor buttons to move up/ down.
- ⑥ **OK**
 - Confirms an entry or selection.
- ⑦ **BACK**
 - Returns to the previous menu of the on-screen menu, a video CD (VCD) or some DVDs.
- ⑧ (Pause Live TV)
 - Starts play or resumes recording.
 - Pauses play or recording..
- (Record)
 - Starts recording the current TV channel or video source.
 - Press repeatedly to set the recording length in 30-minute increments.
- (Stop)
 - Stops play or recording.
- ⑨ **TV VOL + / -**
 - Adjusts the volume of the TV (Philips TV only).

- ⑩ **GUIDE Plus+/ TIMER**
 - Enters or exits the GUIDE Plus+ TV programme menu.
- ⑪ **Numeric keypad**
 - Selects a chapter/track number.
 - Selects the preset TV channel of the recorder.
- ⑫ **SUBTITLE**
 - Selects a subtitle language during play of a DVD or DivX Ultra Video disc.
- ⑬ **LIVE TV**
 - Switches to view live TV programmes.
- ⑭ **USB**
 - Access the contents of the connected USB device.
- ⑮ **INFO**
 - Displays or hides the on-screen help text.
- ⑯ **OPTIONS**
 - Displays or hides the options menu.
- ⑰ **◀ ▶**
 - Skips to the previous or next chapter/track/ title.
- ⑱ **P + / -**
 - In live TV mode, select the next or previous TV channel.
- ⑲ **AUDIO**
 - Selects an audio language.
- ⑳ **DISC MENU**
 - Access the DVD disc menu.
 - Access the VCD disc menu when PBC is turned on.
- ㉑ **ZOOM**
 - Enlarges a picture during play.

3 Connect

This section describes the basic connections required for this recorder before it can be used. Look for the highest quality connection based on the type of devices you have and make the best connection for this recorder.

Basic connections:

- Connect antenna or cable
- Connect video/audio cables

Optional connections:

- Connect other devices
- Connect to AV amplifier/receiver
- Connect to Cable box/ Satellite receiver
- Connect to VCR or other similar device
- Connect to digital video/digital 8 camcorder
- Connect to analogue camcorder

Place the unit

- Place this unit on a flat, hard and stable surface. Do not place this unit on a carpet.
- Install this unit near the AC outlet where the AC power plug can be easily reached.

Connect antenna or cable

To watch and record TV programmes, connect this recorder to an antenna or a cable box/satellite receiver.

Connect to an off-air antenna or cable TV signal

To get TV reception, connect the recorder directly to an off-air antenna or a cable TV signal.

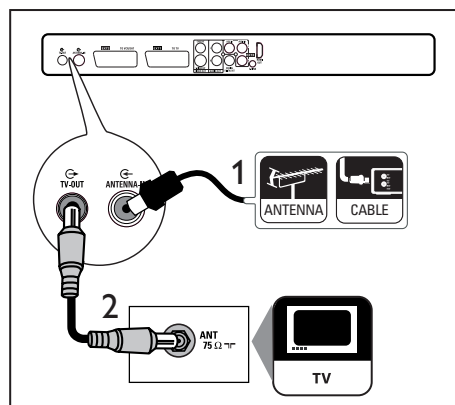

- 1 Unplug the existing antenna cable from your TV.
- 2 Connect the antenna cable to the ANTENNA-IN socket.
- 3 Connect the supplied RF antenna cable from the TV OUT socket to the antenna input on the TV.



Tip

- The antenna input socket on your TV may be labelled as ANT, ANTENNA IN or RF IN.

Connect video/audio cables

To view the playback from this recorder, connect the recorder to the TV.

Before you start, select the best video connection.

- Option 1: Connect to SCART socket (for a standard TV).
- Option 2: Connect to S-video socket (for a standard TV).
- Option 3: Connect to composite video sockets (for a standard TV).
- Option 4: Connect to HDMI socket (for a HDMI, DVI or HDCP-compliant TV).

Notes

- You must connect this recorder directly to a TV.
- If your TV has a digital audio input socket, you can replace the analogue audio connection with digital audio connection in order to enjoy multi-channel surround sound output.

Option 1: Connect to SCART socket

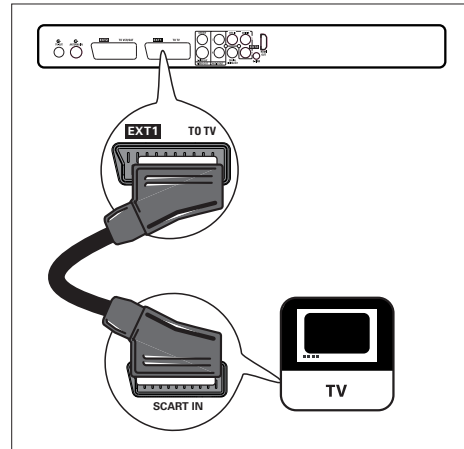

- 1 Connect the supplied scart cable from the **EXT1 TO TV** scart socket to the scart input on the TV.

Tips

- If your TV has several SCART sockets, select the SCART socket for video input.
- To connect to other devices, use the EXT2 TO VCR/ SAT socket on the recorder. See chapter "Connect other devices".

Option 2: Connect to S-Video socket

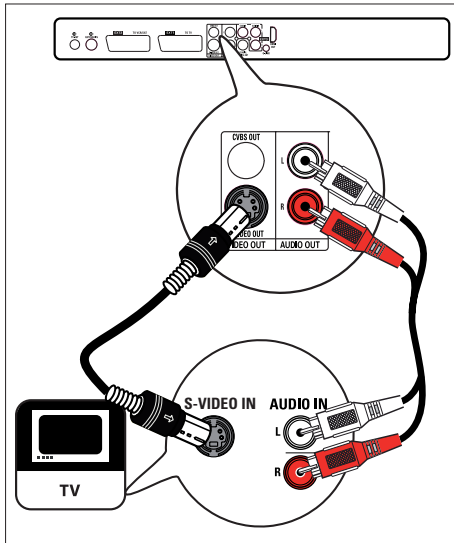

- 1 Connect an S-video cable (not supplied) from the **S-VIDEO OUT** socket to the S-Video input socket on the TV.
- 2 Connect an audio cable (red/white ends - not supplied) from the **AUDIO OUT-L/R** sockets to the matching audio input sockets on the TV.

Tips

- The S-video input socket on your TV may be labelled as Y/C or S-VHS.
- If your TV has a digital audio input socket, you can enjoy multi-channel surround sound output. See chapter "Connect other devices - Connect to AV amplifier/receiver".

Option 3: Connect to VIDEO (CVBS) socket

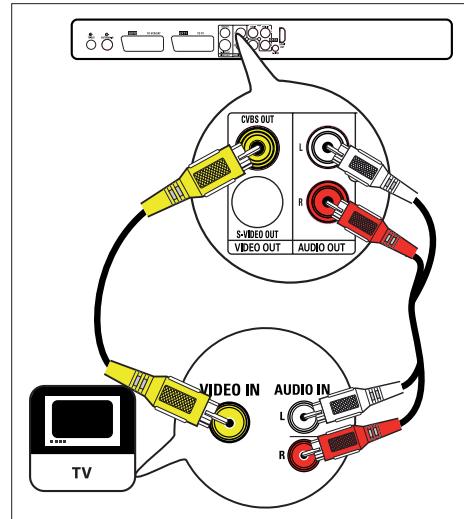

- 1 Connect a composite video cable (yellow end - not supplied) from the **CVBS OUT** socket to the video input socket on the TV.
- 2 Connect an audio cable (red/white ends - not supplied) from the **AUDIO OUT-L/R** sockets to the matching audio input sockets on the TV.

Tips

- The video input socket on your TV may be labelled as A/V IN, VIDEO IN, COMPOSITE or BASEBAND.
- If your TV has a digital audio input socket, you can enjoy multi-channel surround sound output. See chapter "Connect other devices - Connect to AV amplifier/receiver".

Option 4: Connect to HDMI socket

HDMI (High Definition Multimedia Interface) is a digital interface that supports both audio and video transmission through a single cable.

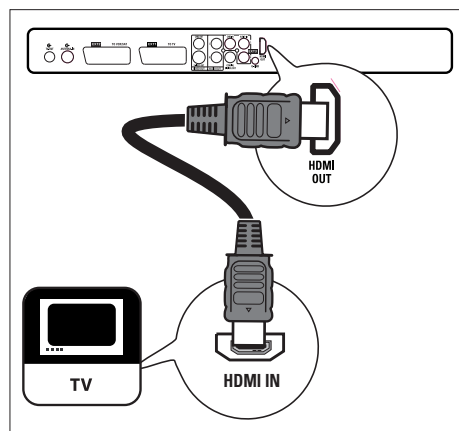

- 1 Connect a HDMI cable (not supplied) from the **HDMI OUT** to the HDMI IN socket on your TV.
 - To adjust HDMI settings (see chapter 'Adjust settings – Adjust HDMI video and audio').

Notes

- Depending on your TV capabilities, audio may not be supported through the HDMI connection. In this case, make an audio connection to your TV and turn off the HDMI audio output (See chapter 'Setup HDMI video and audio').
- HDMI supports HDCP (High-bandwidth Digital Contents Protection). HDCP is a copy protection signal that comes with the HD content (DVD disc or Blu-ray disc).

Tips

- Use a HDMI/DVI adaptor in case your TV has only a DVI connection. An extra audio connection is needed to complete this connection.
- This connection provides the best picture quality.

Connect other devices

To connect this recorder to other devices, you can use these suggested connections for common used cases. Other solutions may be possible, it depends on the capabilities of the devices.

Connect to AV amplifier/receiver

You can enjoy multi-channel surround sound from this recorder when it is connected to a digital audio device.

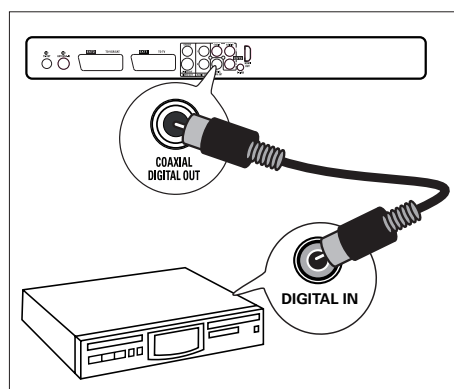

- 1 Connect a coaxial cable (not supplied) from the **COAXIAL DIGITAL OUT** socket to the digital input socket on the amplifier/receiver.
 - Select the digital audio output setting according to the type of audio that the device can output (See chapter 'Audio settings').

Tip

- The digital coaxial input socket on the device may be labelled as COAXIAL IN or DIGITAL IN.

Connect to satellite receiver/ cable box

- 1 Ensure that the device is connected to the TV with an antenna cable.

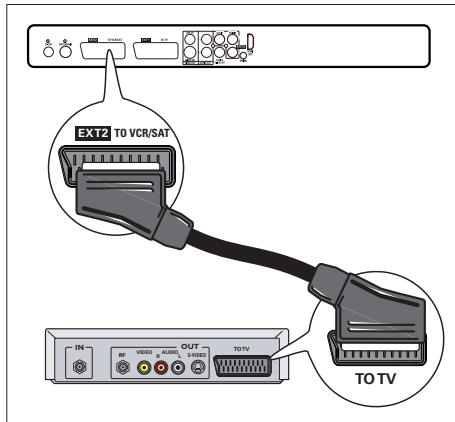

- 2 Connect a scart cable (not supplied) from the **EXT2 TO VCR/SAT** scart socket to the scart output socket on the cable box/ satellite receiver.



Tips

- When using this connection, automatic channel search is not required. Read the chapter "Get started".
- The scart socket on the device may be labelled as TV OUT or TO TV.

Connect the G-Link cable

With the G-link cable, you can control the satellite receiver/ cable box for timer recording through the GUIDE Plus+ system.

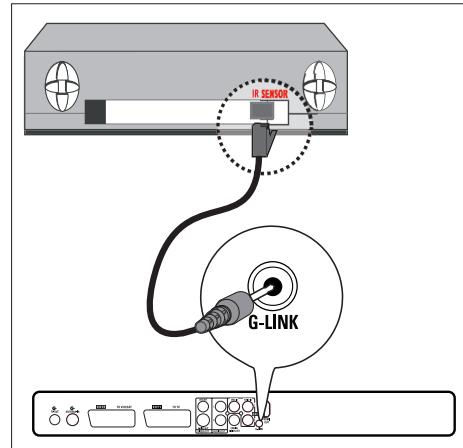

- 1 Connect the supplied G-LINK cable to the **G-LINK** socket on the recorder.
- 2 Place the G-LINK transmitter in front of the cable box/ satellite receiver facing its IR sensor (remote sensor) so that its infrared detector can receive a clear signal.

Connect to VCR or similar device

You can record from a video tape to a recordable DVD or use the VCR when the recorder is turned off.

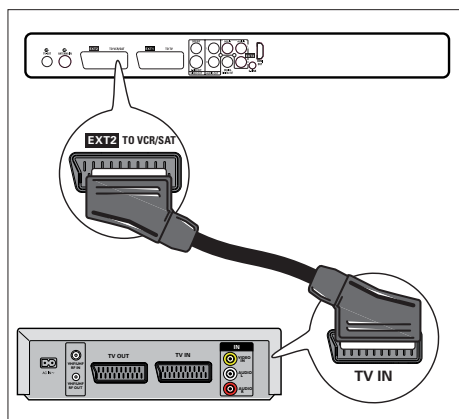

- 1 Connect a scart cable (not supplied) from the **EXT2 TO VCR/SAT** scart socket and to the scart output socket on the device.
 - To view the video input, press **HOME** and select [**EXT2**], then press **OK**.



Notes

- Your recorder replaces the VCR for all your recording needs. Just unplug all the connections to your VCR.
- Most commercial video tapes and DVDs are copy-protected and cannot be recorded.

Connect to digital video/digital 8 camcorder

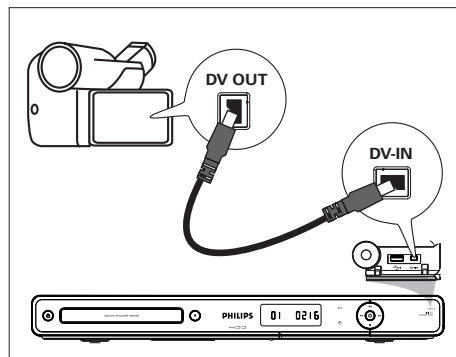

- 1 Flip down the cover on the right hand corner of this recorder.
- 2 Connect an i.LINK 4-pin cable (not supplied) from the **DV-IN** socket on the front panel to the **DV OUT** socket on the camcorder.
 - To view the video input, press **HOME** and select [**DV-IN**], then press **OK**.



Note

- It is not possible to record or copy the titles or files from this recorder to your camcorder.



Tip

- This connection provides the best picture quality.

Connect to an analogue camcorder

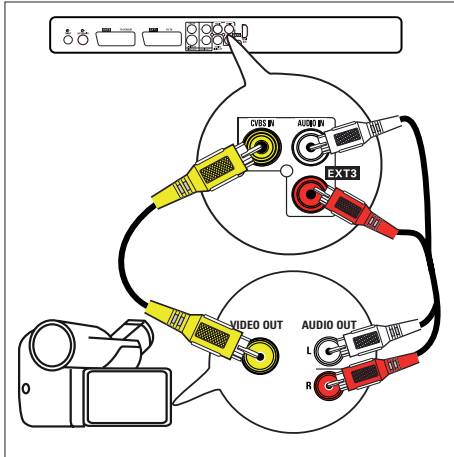



- 1 Connect a video cable (yellow - not supplied) from the **CVBS IN** socket and to the S-VHS or video output socket on the camcorder.
- 2 Connect the audio cable (not supplied) from the **AUDIO IN** sockets and to the audio output sockets on the camcorder.
 - To view the video input, press **HOME** and select [**EXT3**], then press **OK**.

Tip

- To record from this device, see chapter "Record from other devices".

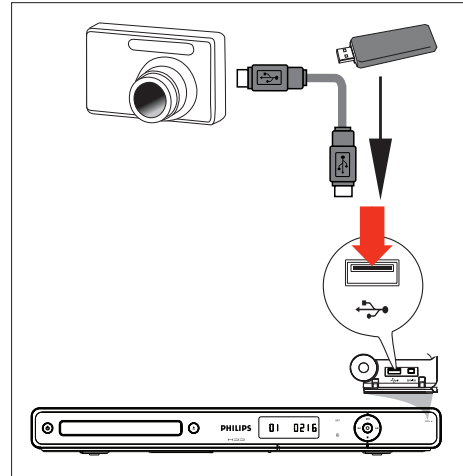
Connect to a USB device or digital camera



- 1 Flip down the cover on the right hand corner of this recorder.
- 2 Connect a USB device or digital camera to the  USB socket.
 - To view the content, press **USB**.

Note

- The USB socket does not support a USB hub device. Only digital cameras which support USB Mass Storage Device class standard are supported.

Tips

- You can copy media files (e.g. jpeg files) from the recorder to your USB device.
- To view the contents of the connected USB device, see chapter "Play – Play from USB".

4 Get Started

Prepare the remote control

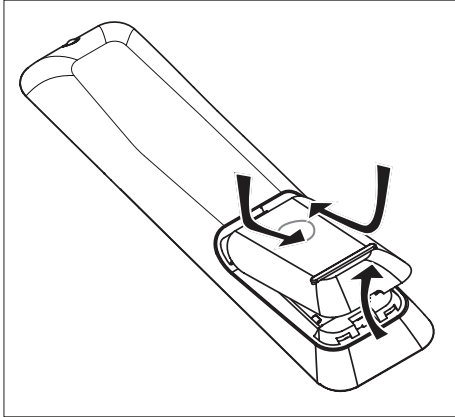

- 1 Open the battery compartment cover.
- 2 Insert two batteries type R03 or AAA. Match the indications (+ -) inside the battery compartment.
- 3 Close the cover.

Note

- If you are not going to use the remote control for a long time, remove the batteries.

Navigate through the menu

- 1 Point the remote control directly at the remote sensor on the front panel and select a function.

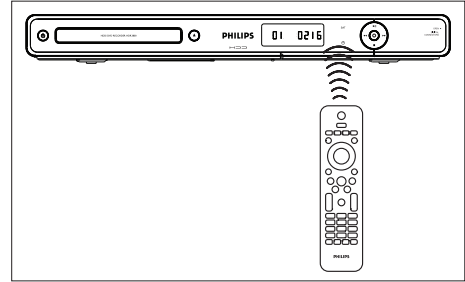

- 2 Use the following buttons on the remote control to navigate through the on-screen menus, enter characters or numbers and confirm your selection.

Action	Button
Move up or down in a menu.	▲▼
Move left or right in the menu.	◀▶
Confirm a selection.	OK

First Time Settings

When you turn on this recorder for the first time, follow the instructions on the TV and complete the initial setup.

Notes

- Before you start, ensure that all the required connections are made.
- If a cable box or satellite receiver is connected, turn it on now.
- Complete this initial setup before you insert a disc for play or recording.

1 Press **Power** to turn on the recorder.

2 Turn on the TV to the correct video-in channel.

Note

- Select a channel on your TV, then press the channel down button on your TV remote control until you see the menu language screen. (The screen options may differ depending on your country of purchase).

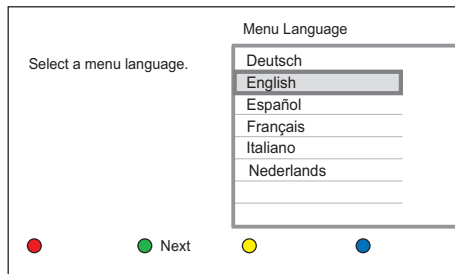

3 Press **Up/Down** to select an on-screen display language, then press the **Green** button [**Next**].

↳ The country selection screen is displayed.

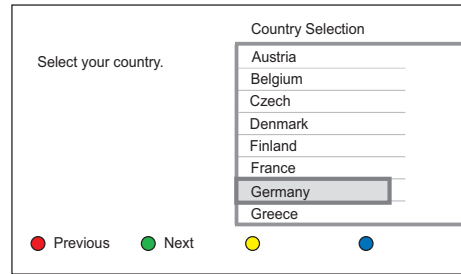

4 Press **Up/Down** to select the country of use, then press the **Green** button [**Next**]. It enables the recorder to find all the TV channels in your area.

↳ The date entry screen is displayed.

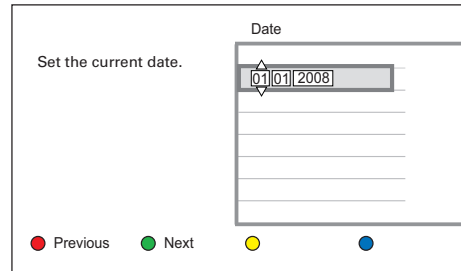

5 Press **Up/Down** (or the numeric keys) to enter the correct date, then press the **Green** button [**Next**].

↳ The time entry screen is displayed.

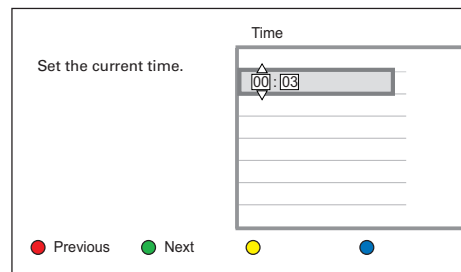

- 6 Press ▲▼ (or the numeric buttons) to enter the correct time, then press the **Green** button [**Next**].

↳ The eco mode selection page is displayed.

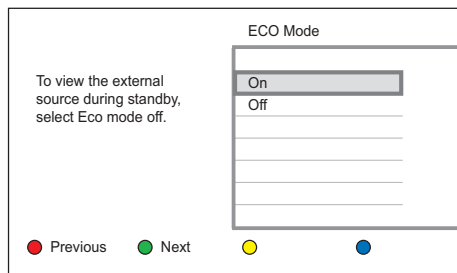

- 7 Select the eco mode setting, then press the **Green** button [**Next**].

- [**On**] : Energy saving mode is enabled. In standby mode, the external device/ source cannot be viewed.
- [**Off**] : Energy saving mode is disabled. In standby mode, the external device/ source can be viewed.

↳ The channel search screen is displayed.

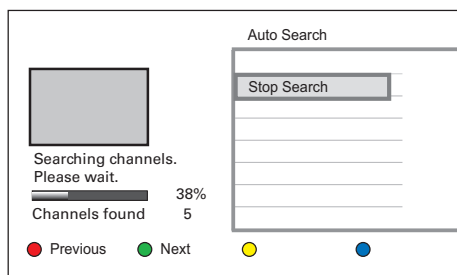

- 8 Store the preset channels:

- **If a cable box or satellite receiver is connected:**
Select [**Stop Search**], then press the **Green** button [**Next**] to skip the channel search.
- **If an off-air antenna is connected:**
Wait for the channel search to complete. This process takes a few minutes.

- 9 Press the **Green** button [**Next**].

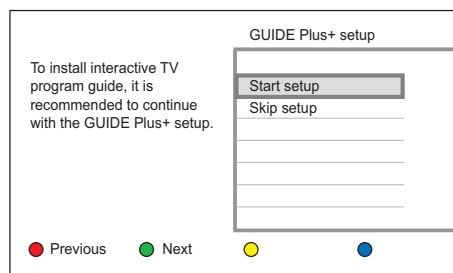

- **To continue with GUIDE Plus setup:**
Select [**Start setup**], then press the **Green** button [**Next**]. (See chapter 'Get started - GUIDE Plus+ Setup')
- **To skip GUIDE Plus setup:**
Select [**Skip setup**], then press **OK**.
↳ The recorder is now ready for use.



Tips

- To re-install or modify the TV channels, see chapter "Adjust Settings - Tuner settings".
- To record from a cable box or satellite receiver, see chapter "Record from other devices".

GUIDE Plus+ Setup

The GUIDE Plus+ system offers a free interactive programme guide that lists all the TV programmes available in your area.

Before you start, define your geographic location and current setup devices to receive the correct GUIDE Plus+ TV listings.

1 If you had selected to continue with the GUIDE Plus+ setup, the basic setup menu is displayed.
↳ Follow the on-screen instructions.

2 Select the option and press **OK**.

[Language]

Select the language for on-screen display.

[Country]

Select the country of your residence.

[Postal code]

Enter your local postal code.

[External Receiver 1], [External Receiver 2] or [External Receiver 3]

Select the source for TV signals.

Notes

- If your country is not in the displayed list or if you are not able to receive TV listings data, you can still use the GUIDE Plus+ system for manual recordings.
- The postal code entered must be valid in the identified country. Otherwise, incorrect TV listings data will be received.
- The [Editor] menu will be updated later when the external receiver is selected as the source for TV signals. See chapter 'Use GUIDE Plus+ – Manage your GUIDE Plus+ channels'.

3 Once complete, press the **Red** button [**Back**] to return to the setup screen.

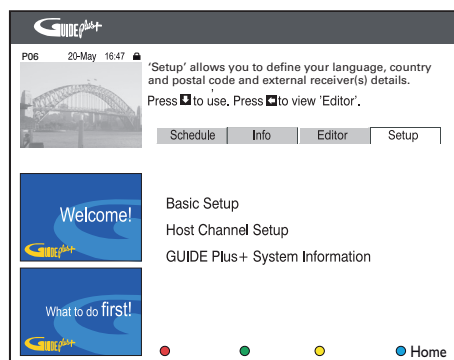

4 To specify the source and programme number of a **GUIDE Plus+** host channel, select [**Host Channel Setup**] and follow the instructions to complete the setup.

- The default host channel setup is set to 'Automatic'.

Visit www.europe.guideplus.com/En/help/countries_hostchannels.html for the latest information on the supporting host channels.

Country/City (Language)	Host Channel (aerial / cable)	Host Channel (SAT)
Austria	Eurosport	Eurosport ASTRA 1C, 1H HOT BIRD 7A
Belgium	RTL-TV1	
France	Canal +	ATLANTIC BIRD3
Germany	Eurosport	Eurosport ASTRA 1C, 1H
Italy	MTV	
Netherlands	Eurosport	Eurosport ASTRA 1C, 1H HOT BIRD 7A
Luxembourg	RTL-TV1	
Spain	Tele 5	
Switzerland(Deutsch)	Eurosport	Eurosport ASTRA 1C, 1H
United Kingdom	ITV (terrestrial) Eurosport	Eurosport UK ASTRA 2A

- 5 Once complete, press **GUIDE Plus+** to exit the menu.
- 6 Switch the recorder to standby mode during the night to load the TV listing data.



Notes

- In standby mode, some noise and heat will be generated during the download of EPG information.
- Check your TV listings on the [Grid] screen for the following day to ensure that the data downloaded is completed.
- If a problem occurs during the GUIDE Plus+ system setup, visit the website at www.europe.guideplus.com for further assistance.

5 Watch live TV

Watch live TV through your recorder

Once you switch to live TV, this recorder stores whatever you watch into the Time Shift Buffer. You can now control the live TV broadcast. For example, pause live TV and resume play at any time or replay the live TV programme.

- 1 Turn on the TV to the correct viewing channel for this recorder.
- 2 Press **⏻** to turn on this recorder.
- 3 Press **LIVE TV**.
- 4 Press **P +/-** to select a channel.

About Time Shift Buffer - temporary HDD storage

Time Shift Buffer (TSB) is a temporary hard disk storage in your recorder. It stores up to the last 6 (six) hours of TV programmes since the recorder was turned on.

The Time Shift video bar displays the status and time of the stored TV programmes.

Press **INFO** to display or hide the information bar.

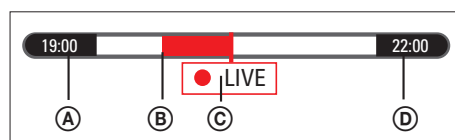





- (A) Start time of the TV programme. Once it has exceeded 6 (six) hours, the start time will be changed accordingly.
- (B) Sections selected to record onto the hard disk (red bar).
- (C) Current position of the broadcast TV programme.
- (D) Current time of the TV programme.

Tip

- To save the TSB contents to the hard disk, see chapter 'Record a TV programme'. Otherwise, it is cleared once you switch the recorder to standby.

Control live TV

To control live TV, switch the recorder to LIVE TV mode.

Action	Button
Pause live TV or resume play.	
<ul style="list-style-type: none">Press to skip backward (instant replay).Press and hold to fast rewind a programme.	
<ul style="list-style-type: none">Press to skip forward (skip ahead).Press and hold to fast forward a programme.	
Go to live TV broadcast.	LIVE TV
Display the information bar and colour keys options.	INFO
Cancel the marked recording on the time shift buffer.	 (Red button)

Change audio language

This option is available only if the TV programme broadcasts more than one audio language.

- 1 Press **AUDIO** repeatedly to select an audio language.
 - 'I' is the original broadcast language and 'II' is the additional broadcast language.

Clear the Time Shift Buffer



Note

- If you access DV-IN mode, the Time Shift Buffer will be cleared.

- 1 Press **HOME**.
- 2 Select [**Settings**], then press **OK**.
- 3 Select [**Recording**] > [**Reset TSB**], then press **OK**.
 - ↳ A confirmation message is displayed.
 - To cancel, select [**Cancel**], then press **OK**.
- 4 To proceed, select [**OK**], then press **OK**.
 - ↳ The time shift buffer is cleared.
- 5 To exit the setup menu, press the **Blue** button [**Exit**].

6 Use GUIDE Plus+

GUIDE Plus+ menu options

The menu bar is displayed at the top panel of the screen. It provides access to different options in the GUIDE Plus+ menu.

- 1 Press **GUIDE Plus+**.
↳ The GUIDE Plus+ screen is displayed.
- 2 Press **▲** to access the options in the menu.

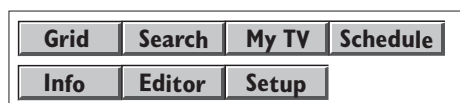

- 3 Select an option and press **▼** to access.
↳ The information on the menu bar is described in the following pages.
- 4 Use these **◀▶▲▼** keys to navigate in the menu.

For other actions, use the following keys:

Action	Button
Go to GUIDE Plus+ Home menu.	 (Blue button)
View the programme listing of a selected channel.	OK
Press to scroll up a page.	P +
Press to scroll down a page.	P -
Go to the previous day's TV listings.	◀
Go to the next day's TV listings.	▶

- 5 Select a TV programme and press **OK** to view.

Note

- If certain channels are missing, go to the [Editor] menu bar to check and adjust the channels.

View GUIDE Plus+ TV listing

The Grid screen is the main TV listings screen of the GUIDE Plus+ system. You can view TV listings for the next seven days.

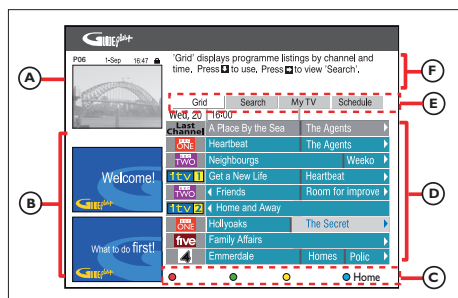

The GUIDE Plus+ menu consists of the following:

A Video window

Displays the picture of the current TV programme.

B Information panels

Displays instructions on the GUIDE Plus+ system, programme promotions and advertisements.

C Action key

Displays the available functions. To activate the feature, press the respective colour coded buttons on the remote control.

D Grid/Tiles

Displays the TV listings by channel and time, 7 days in advance.

E Menu bar

Displays the GUIDE Plus+ menu options and your current selection.

F Information box

Displays brief programme descriptions or help menus.

Search TV listings

The Search screen helps you to locate programme listings by category. You can easily search for programmes to watch or record.

- 1 Press **GUIDE Plus+**.
- 2 Press **▲**, then **▶** to select **[Search]**.
- 3 Press **▼** to access the options.

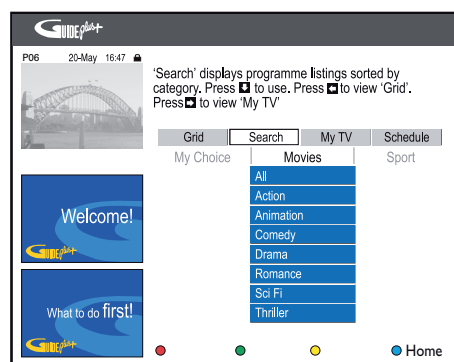

- 4 Select an option and press **OK**.

Setup personal profile

Define your preferred settings by channels, categories and/or by keywords. You can easily find programmes of your interest to watch or record.

- 1 Press **GUIDE Plus+**.
- 2 Press **▲**, then **▶** to select **[My TV]**.
- 3 Press **▼** to access the option.

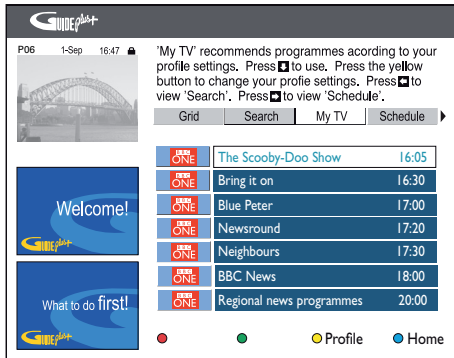

- 4 Select the **Yellow** button **[Profile]**.

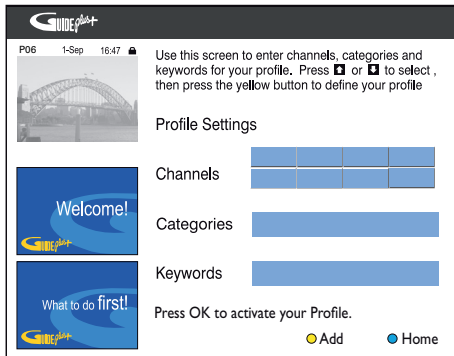

- 5 Enter the settings and press the **Yellow** button **[Add]**.

View more information

The **[Info]** screen displays additional information such as news, weather reports, stock quotes, etc. The information may be broadcast in the same way as the TV listings and may vary according to the region.

- 1 Press **GUIDE Plus+**.
- 2 Press **▲**, then **▶** to select **[Info]**.
- 3 Press **▼** to access the option.

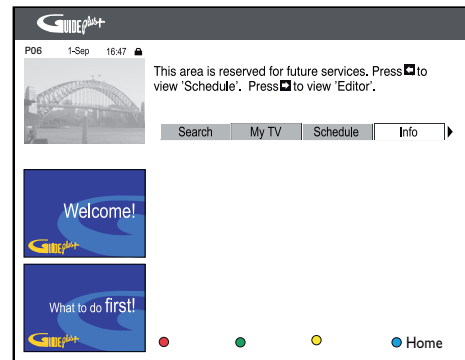

Manage your GUIDE Plus+ channels

You can assign programme numbers to the TV channels, switch a channel on or off and select a channel source (Tuner, External Receiver). The changes made will be applied in the [**Grid**] screen.

- 1 Press **GUIDE Plus+**.
- 2 Press **▲**, then **▶** to select [**Editor**].
- 3 Press **▼** to access the option.

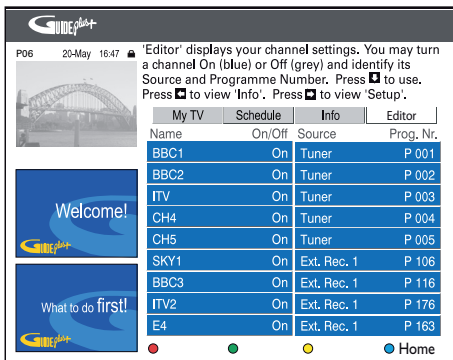

- 4 Make the changes and press the **Blue** button [**Home**].

Adjust GUIDE Plus+ settings

Set the GUIDE Plus+ system according to your preference (Region, TV reception). You can also set up your [**Host Channel Setup**] and view the GUIDE Plus+ system information screen.

- 1 Press **GUIDE Plus+**.
- 2 Press **▲**, then **▶** to select [**Setup**].
- 3 Press **▼** to access the option.

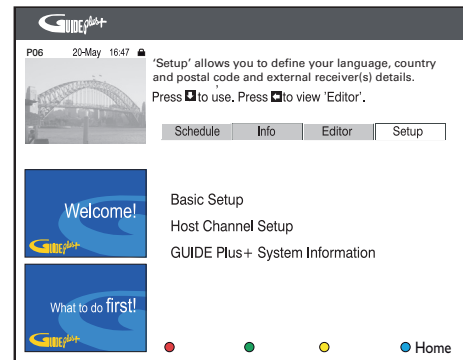

- 4 Press **▼** to select [**Host Channel Setup**] and press **OK**.
- 5 Make the changes and press the **Blue** button [**Home**].

7 Record

Before you record

Record media

The recording media for this recorder are internal hard disk drive (HDD), DVD±R, DVD±RW or DVD+R DL.



Note

- Copy-protected programmes cannot be recorded.
- If power failure occurs during copying the titles from hard disk, the disc may be damaged.
- Cannot record or copy both PAL and NTSC video format on a same recordable DVD.

Supported disc types and media speeds

Disc	Media speeds
DVD+R/-R	1x ~ 16x
DVD+RW	2.4x ~ 8x
DVD-RW	1x ~ 6x
DVD+R DL	2.4x ~ 8x



- High storage capacity.
- TV programmes are recorded to the hard disk before it can be copied to a recordable DVD. (except for manual recording)



DVD±RW

- Recordings can be erased and the space can be used for new recordings.



DVD±R

- Recordings can be erased, but the space cannot be used for new recordings.
- Recordings can be edited or added on the disc before it is finalised.
- A DVD±R must be finalised before it can be played on another DVD players.



DVD+R DL (DVD+R Double Layer)

- Similar to the DVD±R, but with a higher storage capacity at 8.5 GB.
- The disc contains two recording layers and can be accessed from the same side, which makes recording uninterrupted.

Record settings

Select the recording quality

Before you record, select the record mode. The selected picture quality determines the amount of space for recording.

1 Press **HOME**.

Live TV
Recorded Titles
Media Jukebox
Disc
USB
DV-IN
EXT2
EXT3
Settings

2 Select [**Settings**], then press **OK**.

3 Select [**Recording**] > [**Rec. Mode**], then press **▶**.

Setup	Recording	Rec Mode
Tuner	Rec. Mode	HQ
Disc	Rec. Language	✓ SP
Playback	SAT Record	SPP
Recording	Auto Chapter	LP
Video	Reset TSB	EP
Audio		SLP
System		
Misc		

4 Press **▲▼** to select a setting, then press **OK**.

- To return to the previous menu, press **BACK**.

5 To exit the setup menu, press the **Blue** button [**Exit**].

Number of hours that can be recorded (HDR3800)

Record Mode	Hours of recordings can be stored on the HDD or an empty DVD recordable disc.		
	HDD (160 GB)	DVD±R/ DVD±RW	DVD+R Double Layer
HQ (high quality)	20	1	1 hr 55 mins
SP (standard play)	40	2	3 hrs 40 mins
SPP (standard play plus)	55	2.5	4 hrs 35 mins
LP (long play)	65	3	5 hrs 30 mins
EP (extended play)	85	4	7 hrs 20 mins
SLP (super long play)	135	6	11 hrs 5 mins

Number of hours that can be recorded (HDR3810)

Record Mode	Hours of recordings can be stored on the HDD or an empty DVD recordable disc.		
	HDD (250GB)	DVD±R/ DVD±RW	DVD+R Double Layer
HQ (high quality)	35	1	1 hr 55 mins
SP (standard play)	70	2	3 hrs 40 mins
SPP (standard play plus)	95	2.5	4 hrs 35 mins
LP (long play)	110	3	5 hrs 30 mins
EP (extended play)	145	4	7 hrs 20 mins
SLP (super long play)	230	6	11 hrs 5 mins

Note

- Recording time values are estimates only. Parts of the HDD storage capacity will be reserved for the operations of this recorder and time shift buffer.
- The default factory setting is SP record mode.
- When copying recorded titles from the hard disk to a recordable DVD, it is not possible to change the record mode.
- If the size of a title is too large to a recordable DVD, split the title or remove the unwanted sections (see 'Edit recordings - Edit video').

Select the recording language

Some TV programmes are broadcast with an additional language. To ensure the correct language is recorded, select the default language before recording.

- 1 Press **HOME**.
- 2 Select [**Settings**], then press **OK**.
- 3 Select [**Recording**] > [**Rec. Language**], then press **▶**.

Setup	Recording	Rec. Language
Tuner	Rec. Mode	✓ Language 1
Disc	Rec. Language	Language 2
Playback	SAT Record	
Recording	Auto Chapter	
Video	Reset TSB	
Audio		
System		
Misc		

- 4 Select an option, then press **OK**.

[**Language 1**]
Original broadcast audio language.

[**Language 2**]
Additional audio language.
- 5 To exit the setup menu, press the **Blue** button [**Exit**].



Tip

- For other recording settings, see chapter "Adjust Settings – Recording settings".

Set chapter markers



Note

- For DVD+R DL discs, select the option of [10 mins] or longer.

- 1 Press **HOME**.
- 2 Select [**Settings**], then press **OK**.
- 3 Select [**Recording**] > [**Auto Chapter**], then press **▶**.

Setup	Recording	Auto Chapter
Tuner	Rec. Mode	✓ 5 min
Disc	Rec. Language	10 min
Playback	SAT Record	15 min
Recording	Auto Chapter	20 min
Video	Reset TSB	Off
Audio		
System		
Misc		

- 4 Select an option, then press **OK**.

[**5 min**], [**10 min**], [**15 min**] or [**20 min**]
Chapter markers are inserted during recording after every interval of the selected time.

[**Off**]
Auto chapter markers are disabled.
- 5 To exit the setup menu, press the **Blue** button [**Exit**].

Record live TV

Each recording can contain up to 6 (six) hours of a TV programme. If a recording exceeds six hours, it is recorded as another new title.

- 1 Turn on the recorder to live TV mode.
- 2 Use the remote control to record the current TV programme.

Action	Button
Start recording.	●
Set the length of recording. <ul style="list-style-type: none"> • Press this button to add 30 minutes increment at each press, up to 6 hours. 	●
Stop recording at the current position.	■
Cancel recording.	 (Red button)

Record a TV programme that you have watched

Once you switch to live TV, the programme will be stored in the Time Shift Buffer. You can record the programme you have watched by marking the section in the Time Shift Buffer to record.

- 1 Press **INFO**.

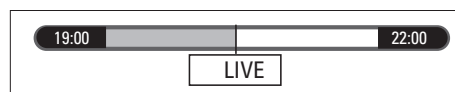

- 2 Use the remote control to search and mark the section for recording.

Action	Button
Press to fast rewind within a programme that is stored on the TSB.	◀
Press to fast forward within a programme that is stored on the TSB.	▶
Mark the start point.	●
Mark the stop point.	■
Cancel the marked section.	 (Red button)



Tips

- A red mark appears indicating the marked section. When the recorder is switched to standby, the marked section appears in the HDD as a recorded title.
- Marking of section can be done forward or backward within the Time Shift Buffer.

Schedule a timer recording

Schedule your recordings in advance and you can watch your favourite programmes at your convenience.

Note

- Copy-protected programmes cannot be recorded.
- If a recording is more than 6 hours long, it splits into two or more titles.
- Maximum **14 recordings** can be scheduled in advance.
- When timer recording is active, changing of recorder's channel is not possible.
- In UK and Ireland, the **SHOWVIEW** system is known as **VIDEO Plus+** system and **SHOWVIEW** Programming Number is known as the **PlusCode** Programming Number.





There are several ways to schedule a timer recording:

- Use **GUIDE Plus+** system
- Use **VIDEO Plus+ / SHOWVIEW** recording
- Use manual timer recording

Schedule a **GUIDE Plus+** recording

- 1 Press **GUIDE Plus+**.
- 2 Press the **Blue** button [**Home**].
- 3 Select [**Grid**], then press **▼**.



Action	Button
View all the available channels in your area	 (Yellow button)
Go to GUIDE Plus+ Home Menu	 (Blue button)
To view the programme listing of a selected channel.	OK
To scroll up a page	P +
To scroll down a page	P -
View TV listings from the previous day	
View TV listings for the next day	

- 4 Select a programme and press the **Red** button [**Record**].
 - ↳ The new recording is displayed in the [**Schedule**] list.

Schedule a VIDEO Plus+ / SHOWVIEW recording

- 1 Press **GUIDE Plus+**.
- 2 Press the **Blue** button [Home].
- 3 Press **▲**, then press **▶** to select [Schedule].

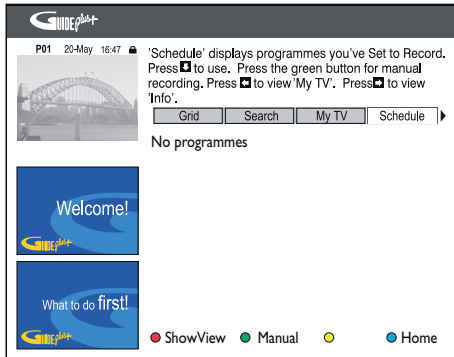

- 4 Press the **Red** button for [VIDEO Plus+] or [ShowView].

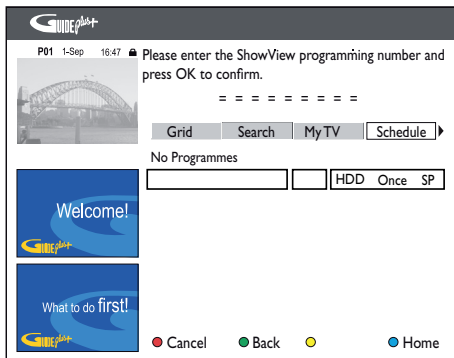

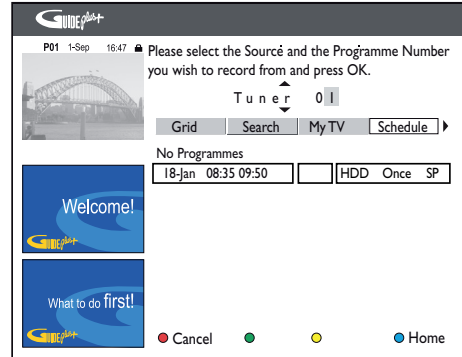

- 5 Use the numeric buttons to enter the SHOWVIEW / PlusCode programme number (e.g. 5-312-4 or 5,312 4, key in '53124'), then press **OK**.

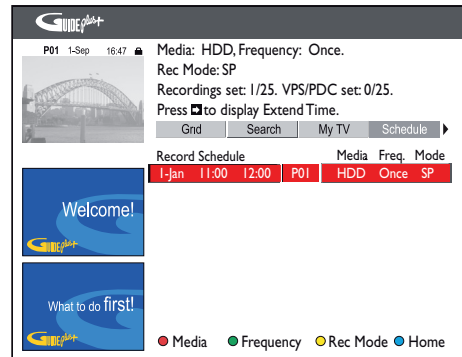

- 6 Select the channel to record from and press **OK**.



To change the default record settings:

Action	Button
[Frequency] : Select the repeat recording setting (Once, Weekly, Mon~Fri, Weekend).	 (Red button)
[Media] : Select the destination for recording (HDD or DVD).	 (Green button)
[Mode] : Select the recording quality. <ul style="list-style-type: none"> [HQ] ~ [SLP] – See chapter 'Before you record – Select the recording quality'. 	 (Yellow button)

- To exit, press **GUIDE Plus+**.
↳ The '⊕' icon lights up on the display panel if a timer recording is set.

Note

- If the recorder is not in standby mode, a notification message appears before the timer recording begins. If you ignore the message, the recorder automatically switches to standby mode. Recording begins at the scheduled time.
- 'VPS' (Video Programming System) or 'PDC' (Programme Delivery Control) is used to control the start and duration of TV channel recordings. If a TV programme starts earlier or ends later than was scheduled, this recorder will then turn on and off at the correct time.

Schedule a manual recording

- Press **GUIDE Plus+**.
- Press the **Blue** button [**Home**].
- Press **▲**, then press **▶** to select [**Schedule**].

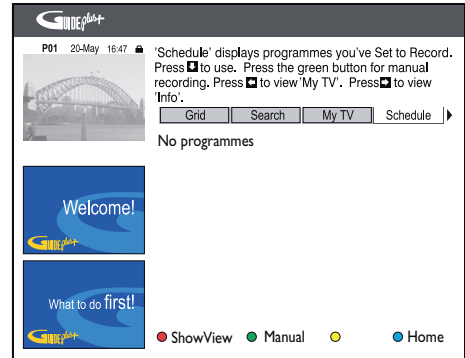

- Press the **Green** button [**Manual**].
↳ The timer entry screen is displayed.

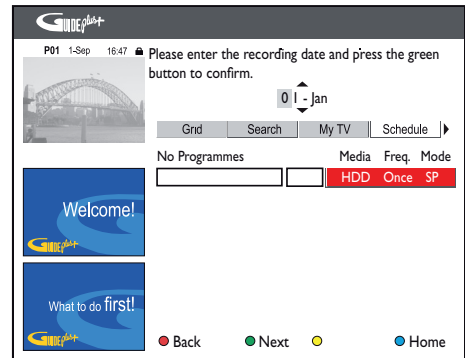

- Follow the instructions on the screen and enter the recording information (date, start time, end time) and press the **Green** button [**Next**] to confirm each entry.

6 When 'TUNER 01' is displayed, select the input source and enter a channel.



- To select an external input channel, highlight 'TUNER' in the menu and select [**EXT2**] or [**EXT3**].
- To select a TV channel, highlight '01' in the menu and use the numeric keypad 0-9 to enter the channel number.

7 Press the **Green** button [**Save**].

- ↳ The programme title entry menu is displayed.

8 Follow the on-screen instructions to make the entry and press the **Green** button [**Save**].

- To change default record settings.

Action	Button
[Media] : Select the destination for recording (HDD or DVD).	 (Red button)
[Frequency] : Select the repeat recording setting (Once, Weekly, Mon~Fri, Weekend).	 (Green button)
[Mode] : Select the recording quality. • [HQ] ~ [SLP] – See chapter 'Before you record – Select the recording quality'.	 (Yellow button)

9 To exit, press **GUIDE Plus+**.

- ↳ The 'Ⓜ' icon lights up on the display panel if a timer recording is set.

Note



- If the recorder is not in standby mode, a notification message appears before the timer recording begins. If you ignore the message, the recorder automatically switches to standby mode. Recording begins at the scheduled time.
- 'VPS' (Video Programming System) or 'PDC' (Programme Delivery Control) controls the start and end of a TV programme recording. If a TV programme starts earlier or ends later than scheduled, the timer recording begins at the correct time.

Edit a scheduled recording

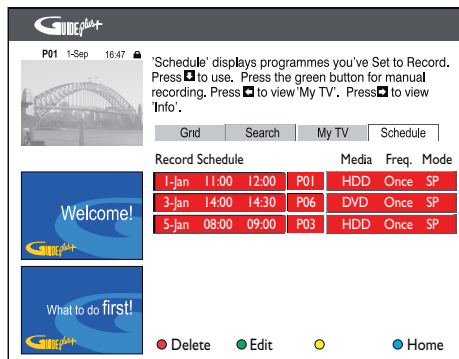
- 1 Press **GUIDE Plus+**.
- 2 Press the **Blue** button [**Home**].
- 3 Press **▲**, then press **▶** to select [**Schedule**].



- 4 Press **▼** to select a scheduled recording which you want to delete or edit.

Action	Button
[Delete] : Delete the selected recording.	 (Red button)
[Edit] : Edit record settings.	 (Green button)

- 5 Follow the on-screen instructions to make the necessary changes.
- 6 To exit, press **GUIDE Plus+**.

Record from other devices

Record from a digital video camcorder

You can record the content from a digital video camcorder when you connect it to the DV-IN socket.

- 1 Turn on the TV to the correct viewing channel for the recorder.
- 2 Connect the digital video camcorder to the **DV-IN** socket on the recorder.
- 3 Press **HOME**.
- 4 Select [**DV-IN**], then press **OK**.

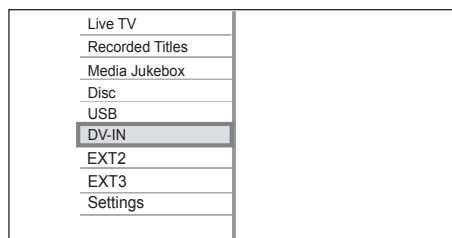

- 5 Start play on the digital video camcorder.
- 6 Press **●** at the point you want to start recording.
- 7 Select a destination for recording: [**DVD**] or [**HDD**], then press **OK**.
 - ↳ Recording begins.
 - To pause recording, press **▶||**.
 - To continue recording, press **▶||** again.
- 8 To stop the recording, press **■**.
 - ↳ A new HDD title is saved.
- 9 To exit, press **HOME**.



Tip

- To view the recording, see chapter "Play – Play video".

Record from an external device (Analogue Camcorder/ Satellite Receiver/ VCR/ DVD Player)

You can record from the external device to a recordable DVD. Copy-protected material cannot be recorded on this recorder.

- 1 Turn on the TV to the correct viewing channel for the recorder.
- 2 Connect the external device (e.g. analogue camcorder, VCR, DVD player) to this recorder.
- 3 Press **HOME**,
- 4 Select a recording source, then press **OK**.
[EXT2]
the device connected to the EXT2 scart socket on the recorder.
[EXT3]
the device connected to the EXT3 (VIDEO IN and AUDIO L/R) sockets on the recorder.
- 5 Start play on the external device and locate the content to record.
- 6 Press **●** at the point you want to start recording.
 - To pause recording, press **▶||**.
 - To continue recording, press **▶||** again.
- 7 To stop the recording, press **■**.
↳ A new HDD title will be saved.
- 8 To exit, press **HOME**.



Tip

- Chapter markers are created at each break in the time code on the DV tape.

Synchronise recording from a satellite receiver

This feature is only applicable to the satellite receiver (or any similar devices) with timer function. Connect the satellite receiver to the EXT2-TO VCR/SAT scart socket of this recorder.

Enable the satellite recording

It allows the recorder to start and stop recording when a signal is received from the satellite receiver.

- 1 Press **HOME**.
- 2 Select [**Settings**], then press **OK**.
- 3 Select [**Recording**] > [**SAT Record**] > [**On**], then press **OK**.
 - To disable this option, select [**Off**], then press **OK**.
- 4 To exit, press the **Blue** button [**Exit**].

Programme the satellite receiver

- 1 Programme the timer recording on your satellite receiver (refer to the satellite receiver user manual).
- 2 Turn off the recorder to standby.
 - ↳ The recording starts once the recorder detects a signal from the satellite receiver.
 - Each recording can be programmed up to 6 hours.



Note

- Switch the recorder in standby mode for timer recording.
- If a timer recording is scheduled during recording from the satellite receiver, the recording from the satellite receiver stops and timer recording begins.

Simultaneous record and play

Navigate the programme during recording

- 1 During recording, press ◀ on the remote control to go to the beginning of the recorded programme.

Play another programme or media during recording

Play from HDD

- 1 Press **HOME**.
- 2 Select [**Recorded Titles**], then press **OK**.
- 3 Select a title to play, then press ▶||.

Playback from DVD

- 1 Press ▲ on the front panel of the recorder.
- 2 Insert a disc, then press ▲ to close the tray.
 - If play does not start, press **DISC MENU** to display the disc content. Select a title and press ▶||.

Playback from USB

- 1 Insert a USB device to the USB socket.
- 2 Press **USB**.
- 3 Select a file to play, then press ▶||.

Watch other TV programme

- 1 Use the TV remote control to select a TV channel.
- 2 To view play from the recorder, switch the TV back to its correct viewing channel for recorder.

8 Play

Play recorded TV programmes

- 1 Press **HOME**.
- 2 Select [**Recorded Titles**], then press **OK**.

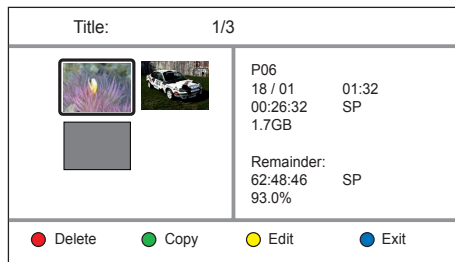

- 3 Select a title and press **▶||**.

Symbols at the content menu

Symbol	Description
	Title is protected.

Control play

When you watch a recorded title, control play with the following options:

Action	Button
• Skip to the previous/ next chapter.	◀▶
• Press and hold for fast backward search.	◀
• Press and hold for fast forward search. Press the button again to increase the search speed.	▶
Pause/ resume play.	▶
Display or hide the information bar.	INFO
Stop play.	■
Return to live TV.	LIVE TV
During play, press to go to [Recorded Titles].	BACK

Play from media storage

The Home menu provides access to the various play media supported by this recorder.

- 1 Press **HOME**.

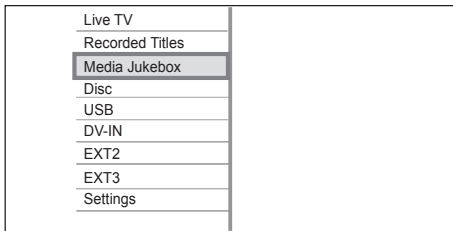

- 2 Select [**Media Jukebox**], then press **OK**.
 - This is a media jukebox where you can store your video, music and photos.

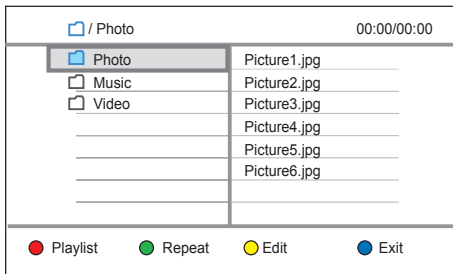

Each media folders stores these file formats:

[**Photo**] :

JPEG digital camera photos (.jpg, .jpeg).

[**Music**] :

MP3 and Windows Media Audio (.mp3 and .wma).

[**Video**] :

DivX movies (.avi and .divx).

- 3 Select a file to play, then press **▶▶**.
 - To return to the previous menu, press **BACK**.
 - To exit the menu, press **HOME**.

Create your playlist

- 1 Press **HOME**.
- 2 Select [**Media Jukebox**], then press **OK**.
- 3 Select the media folder and press **▶**.
- 4 Select a file, then press the **Red** button [**Playlist**].
 - ↳ The file is added to the playlist.

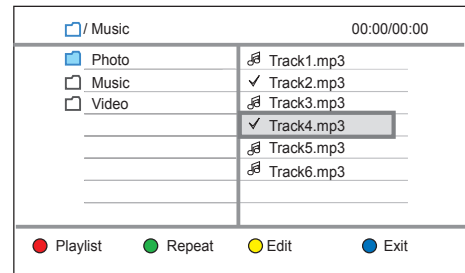

Tip

- You can mark several files to add to the playlist. To mark or unmark a file, select the file and press the **▶** button.

Play the playlist

- 1 Press **HOME**.
- 2 Select [**Media Jukebox**], then press **OK**.
- 3 Select the media folder and press **▶**.
- 4 Select [**Playlist**], then press **▶▶**.

Edit from playlist

Remove from playlist

- 1 Select the playlist and press **▶**
- 2 Select the file to remove and press the **Red** button [**Remove**].
 - ↳ The file is removed.

Play from USB

View the contents of a USB drive, USB memory card reader or digital camera through this recorder. The USB socket supports the playback of JPEG, MP3, WMA and DivX files.

Note

- The USB socket does not support a USB hub device. Only digital cameras which support USB Mass Storage Device class standard are supported.

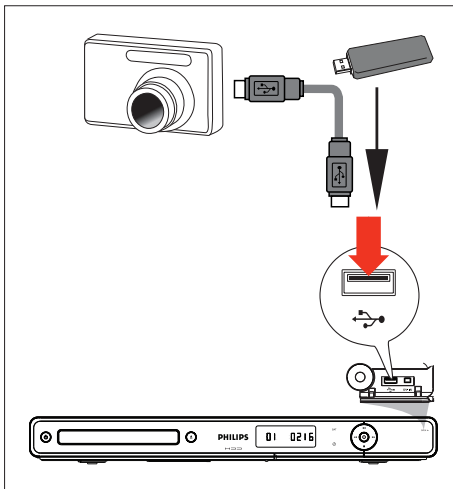

- 1 Flip down the flap on the front panel.
- 2 Connect the USB flash drive to the USB socket.
- 3 Press **USB**.
↳ The content menu is displayed.
- 4 Select a file, then press **▶||**.

Tip

- For more play options, see chapter 'Play – Play from USB'.

Play from a USB card reader











- 1 Flip down the flap on the front panel.
- 2 Connect the USB device to the USB socket.
- 3 Press **USB**.
↳ The content menu is displayed.
 - To select another card in the reader, press **USB** to repeatedly to select the source.
- 4 Select a file, then press **▶||** to start.

Tip

- During play, when you select another card in the reader, play stops.

Play from disc

Playable discs

	DVD Video (Digital Versatile Disc) <ul style="list-style-type: none">• Region 2/ ALL
	DVD±RW (DVD Rewritable)
	
	DVD±R (DVD Recordable)
	
	DVD+R DL (DVD+R Double Layer)
	CD-RW (CD-Rewritable) <ul style="list-style-type: none">• MP3/WMA/JPEG/DivX
	CD-R (CD-Recordable) <ul style="list-style-type: none">• MP3/WMA/JPEG/DivX
	Audio CD (Compact Disc Digital Audio)
	Video CD
	Super Video CD



Notes

- DVDs and DVD players are designed with regional restrictions. Before you play a disc, make sure it is for the same region zone as your device (indicated on its rear).
- If the inhibit icon (X) is displayed when a key is pressed, it means the function is not available.
- Do not push on the disc tray or put any objects other than discs on the disc tray. It may cause the disc player to malfunction.

Play a disc

! Caution!

- Never place any objects other than discs into the disc tray.
- Never look into the laser beam inside the recorder.

- 1 Press .
- 2 Turn on the TV to the correct viewing channel for the recorder.
- 3 Press .
↳ The disc tray opens.
- 4 Place the disc on to the tray and press .
 - Ensure that the label is facing up.
 - For double-sided discs, load the side which you want to play as indicated on the disc.
- 5 Play starts automatically.
 - If play does not start, press **DISC MENU** to display the disc content. Select a track and press **▶II**.

* Tip

- For more playback options, see chapter "Play".

Play video

Play a recorded title

- 1 Press **DISC MENU**.
↳ The content menu is displayed.

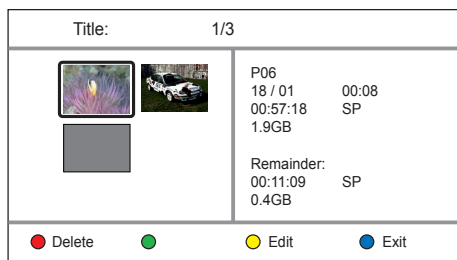

- 2 Select a title to play and press **▶||**.

Play a DivX file

Play the DivX files which you have copied from your computer onto a CD-R/RW, recordable DVD or USB device.

- 1 Press **HOME**.
- 2 Select the media source ([Media Jukebox], [Disc] or [USB]) where the files are stored, then press **OK**.
- 3 Select [**Video**] and navigate to the file you want to play, then press **▶||**.
- 4 Use **▲▼** buttons to navigate within the menu and press **OK**.
 - If the disc contains many files, use **◀▶** to view the previous/ next page of file names.
 - To return to the previous level, press **BACK**.
- 5 Select the file to play and press **OK**.
- 6 To stop play, press **■**.

If multilingual subtitles are available on the DivX disc,

- 1 During playback, press **SUBTITLE** to select another subtitle language.
 - To select another character set for the subtitle file, see chapter "Adjust Settings – Playback settings - Set DivX(R) subtitle font".
- 2 To stop playback, press **■**.



Notes

- Subtitle files with the following filename extensions (.srt, .smi, .sub, .sami) are also supported.
- Due to poor clarity of digital contents during internet downloading, it is normal to experience an occasional pixelation during DivX playback

Control video play

Select a chapter

When a disc contains more than one title or chapter, follow the options below to select a specific title or chapter.

During play, use the remote control:

Action	Button												
To go to the next chapter.	▶												
To go to the start of the previous chapter.	◀												
To select by a chapter number.	<table border="1"><tr><td>1</td><td>2</td><td>3</td></tr><tr><td>4</td><td>5</td><td>6</td></tr><tr><td>7</td><td>8</td><td>9</td></tr><tr><td>0</td><td></td><td></td></tr></table>	1	2	3	4	5	6	7	8	9	0		
1	2	3											
4	5	6											
7	8	9											
0													

Select a title

- 1 During play, press **OPTIONS**.
- 2 Select the title icon, then press ▶.



- 3 Use the numeric buttons to enter a title number.
↳ Play skips to the selected title.
- 4 To exit the menu, press **OPTIONS**.

Select a subtitle language

For DVDs and DivX® Ultra discs with multiple subtitle languages.

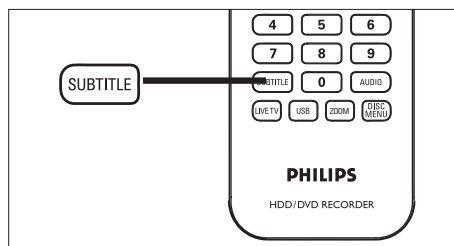

- 1 During disc playback, press **SUBTITLE**.
↳ The subtitle options appear. If the option selected is not available, the default disc subtitle option will be used.

Select an audio language

For DVDs with multiple soundtrack language or VCDs with multiple audio channel.

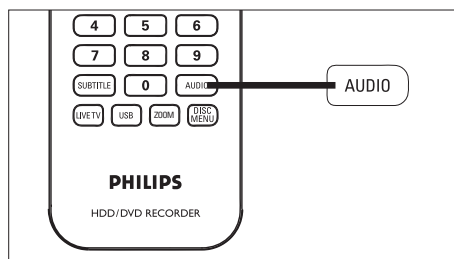

- 1 During disc play, press **AUDIO**.
↳ The audio options appear. If the audio channel is not available, the default disc audio channel will be used.



Tip

- Some DVDs discs allow audio and subtitle language selections only from the DVD disc menu. To access the disc menu, press **DISC MENU**.

Search by time

Skip to a specific point on the disc.

- 1 During play, press **OPTIONS**.
↳ The elapsed play time is displayed.
- 2 Select the time search icon, then press **OK**.
↳ The elapsed play time is displayed.



- 3 Use the **numeric keypad (0-9)** to enter the 6-digit time.
↳ Play skips to the entered time.

Search forward/ backwards

Fast forward search or fast reverse search the video content during play.

- 1 During play, press and hold **◀** or **▶**.
↳ The search speed is displayed and the sound is muted.
- 2 Press **◀** or **▶** repeatedly to cycle through the different speed options.
 - To resume normal play, press **▶||**.

Switch camera angles

For DVDs that contain sequences recorded from different camera angles. You can view the scene from different angles.



Note

- If multiple angles function is supported, the  icon will appear.

- 1 During play, press **OPTIONS**.
↳ The options menu is displayed.
- 2 Select  [**Angle**], then press **▶**.
- 3 Select a camera angle on the disc.

Slow motion play

- 1 To pause during play, press **▶||**.
↳ Play pauses and displays a still picture.

Action	Button
To move the picture forward frame by frame. (Not applicable to DivX files, VCD, SVCD discs).	▶
To move the picture back frame by frame. (Not applicable to DivX files, VCD, SVCD discs).	◀
To cycle through the different slow motion speed, press the button repeatedly.	▶

- 2 To resume normal play, press **▶||**.

Select repeat play options

Select various repeat functions during play. The repeat play options vary depending on the disc type.

- 1 During playback, press **OPTIONS**.
- 2 Select the repeat icon  and press **▶**.
- 3 Select a repeat option, then press **OK**.

[All]

Repeat play of all files and tracks.

[Chapter] - DVD, DVD±R, DVD±RW only

Repeat play of the current chapter.

[Track]/ [Title]

Repeat play of the current track/ title.

[Off]

Cancel repeat function.

- 4 To exit, press **OPTIONS**.

Repeat a specific scene (A-B)

You can repeat play of a specific segment within a title or chapter. To do so, you must mark the start and end of the segment you want.

- 1 During playback, press **OPTIONS**.
- 2 Select the repeat icon  and press **▶**.
- 3 Select [A -] at the point to mark the start point for repeat play.
- 4 Select [A - B] at the end point.
 - ↳ Play skips to the start of the marked segment. The segment is repeated until repeat mode is cancelled.
- 5 To cancel play, repeat steps 1 and 2, then select [A - B Off].
- 6 To exit, press **OPTIONS**.

Resume play from the last stopped point

This option is available during play of DVDs/ VCDs. The recorder is able to resume disc playback from its last stopped point.

Before you start...

Ensure that you have enabled the function before playing the disc or title.

- 1 Press **HOME**.
- 2 Select [Settings], then press **OK**.
- 3 Select [Playback] > [Resume], then press **▶**.
- 4 Select [On], then press **OK**.
 - ↳ The resume play function is enabled.





For DVD discs: Resume playback after you have stopped play

- 1 Press **▲** on the front panel of the recorder.
- 2 Insert a disc, then press **▲** to close the tray.
 - ↳ Playback starts from the last stopped point.
 - If play does not start, press **DISC MENU** to display the disc content and press **▶||**.

For HDD titles: Resume playback after you have stopped play

- 1 Press **HOME**.
- 2 Select [Recorded Titles], then press **OK**.
- 3 Select a title, then press the **Yellow** button [Edit].
- 4 Select [Resume Play], then press **OK**.
 - ↳ Playback starts from the last stopped point.

To start playback from the beginning

- 1 Press  on the front panel of the recorder.
- 2 Insert a disc, then press  to close the tray.
 - ↳ Playback starts from the last stopped point.
 - If play does not start, press **DISC MENU** to display the disc content and press .
- 3 Press .
 - ↳ Playback starts from the first title/track.

Set playback control - PBC







Some (Super) Video CDs feature 'PBC' (Play Back Control). You can play video CDs interactively by following the on-screen menu.

- 1 Insert a (Super) Video CD.
 - If the disc menu is displayed, select an option and press **OK**.
- 2 During disc play, press **OPTIONS**.
- 3 Select [**PBC**] and press **OK**.
- 4 Select an option, then press **OK**.
 - [**On**]
Enable playback control.
 - [**Off**]
Disable playback control.
- 5 To stop playback, press .

Play music

Play an audio disc

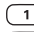
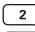
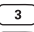
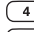
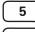
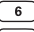
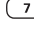
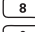
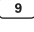
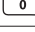
- 1 Play a track.
- 2 Use the remote control to control the track.

Action	Button
Pause/ resume play.	
Stop play.	
Jump to the next track.	
Return to the beginning of the current track or jump to the previous track.	
Enter the track number.	         
Search forward (press and hold the button).	
Search backward (press and hold the button).	

Play MP3/ WMA files

This recorder can play most MP3/ WMA audio files recorded on a recordable DVD, commercial discs or USB flash drive.

- 1 Press **HOME**.
- 2 Select the media source ([Media Jukebox], [Disc] or [USB]), then press **OK**.
- 3 Select [**Music**] and navigate to the track you want to play, then press **▶||**.
↳ Audio playback begins.

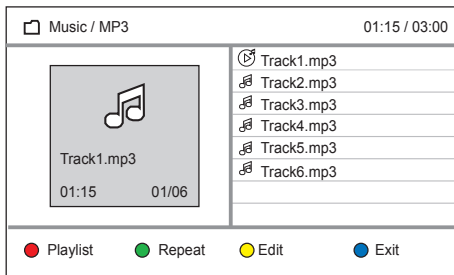

Note

- CDs recorded in multiple sessions, only the first session is played.
- This recorder does not support MP3PRO audio format.
- If any special characters are present in the MP3 track name (ID3) or album name, it might not be displayed correctly on the screen because these characters are not supported.

Control audio play

Shuffle play audio

Play CD tracks or audio files in random order.

- 1 During play, press the **Green** button [**Repeat**] repeatedly to select [**Shuffle**].
- 2 To cancel shuffle play, press the **Green** button to select [**Off**].

Repeat play audio

Repeat play options vary depending on the disc type.

- 1 To cycle through various repeat options during play, press the **Green** button.

[**Once**]

Play only once.

[**Repeat Track**]

Repeat play of the current track/ title.

[**Repeat All**]

Repeat play of all files and tracks. To repeat a folder or entire disc, select the folder then select [**Repeat All**] option.

[**Shuffle**]

Files or tracks are played randomly.

- 2 To cancel repeat play, press the **Green** button repeatedly to select [**Off**].

View photos

Play a picture disc (slideshow)

You can view JPEG pictures as a slideshow.

- 1 Press **HOME**.
- 2 Select the media source ([Media Jukebox], [Disc] or [USB]), then press **OK**.
- 3 Select [**Photo**] and navigate to the file you want to play, then press **▶||**.
↳ The slideshow begins.

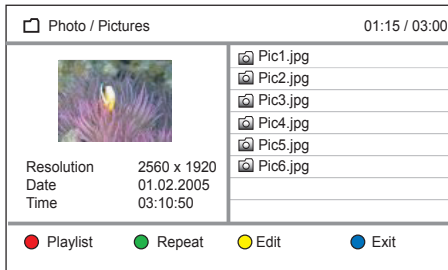







Control photo playback

- 1 During playback, press **INFO**.
↳ The control options are displayed at the bottom of the screen.



- 2 Use the remote control to control the photo slideshow.

Action	Button
Pause/ resume play.	
Stop play.	
Zoom in or out on a picture. • Play will pause while in zoom mode.	ZOOM
Display the index of all pictures.	 (Red button)
Press repeatedly to access repeat and shuffle play options.	 (Green button)
Press repeatedly to access transition options.	 (Yellow button)
Press repeatedly to rotate the picture.	 (Blue button)

Tip

- You can view a customised series of photos from different photo folders by organising the photos from existing photo folders into a photo playlist.



Notes

- It may require a longer time for the recorder to display the disc content on the TV due to the large number of songs/photos compiled onto one disc.
- Some types of JPEG file cannot be played on this recorder.
- Unreadable disc or disc with no name will be displayed as 'Unknown Disc'.
- If the JPEG photo is not recorded with an 'exif' type file, the actual thumbnail picture will not be shown on the display.
- This recorder can only display digital camera pictures according to the JPEG-EXIF format, typically used by almost all digital cameras. It cannot display Motion JPEG, progressive JPEG and other JPEG formats, or pictures in formats other than JPEG, or sound clips associated with pictures.

Play musical slideshow

Play MP3/WMA audio files and JPEG photo files simultaneously to create musical slideshow. The MP3/WMA and JPEG files must be stored on the same disc, USB device or hard disk.

- 1 Press **HOME**.
- 2 Select the media source ([Media Jukebox], [Disc] or [USB]), then press **OK**.

To start music play

- 1 Select [**Music**], then press **▶**.
- 2 Select a track and press **▶||**.
↳ The audio file is played.
- 3 Press **◀** to go to the media folders.

To start photo slideshow

- 1 Select [**Photo**], then press **▶**.
- 2 Select a picture file or playlist and press **▶||**.
↳ Slideshow begins.
↳ Audio continues to play until the end of the disc or playlist.

To stop the musical slideshow

- 1 To stop slideshow play, press **■**.
 - If the audio file is still playing, press **■**.

9 Edit Recordings

Edit titles in the hard disk



You can:

- Edit title name
- Erase an unwanted scene
- Divide a title
- Protect/ Unprotect title
- Delete title
- Manage titles by genre

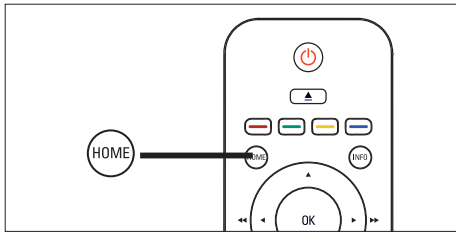
To access the HDD edit menu:



- 1 Press **HOME**.
- 2 Select [**Recorded Titles**], then press **OK**.
↳ The list of recorded titles is displayed.

Title:	1/3
 	P06 18 / 01 01:32 00:26:32 SP 1.7GB
	Remainder: 62:48:46 SP 93.0%
● Delete ● Copy ● Edit ● Exit	



- 3 Select a title, then press the **Yellow** button [**Edit**].
↳ The HDD edit menu is displayed.

Edit title name

- 1 Press **HOME**.
- 2 Select [**Recorded Titles**], then press **OK**.
- 3 Select a title, then press the **Yellow** button [**Edit**].
↳ The HDD edit menu is displayed.

Edit	Edit Title	
Play	Rename	 P06 10 / 01 10:08 00:30:21 SP 1.0GB
Erase	Divide	
Edit Title	A-B Erase	
Set Genre	Protect	
Sort Format		
● Back ● ● ● Exit		

- 4 Select [**Edit Title**] > [**Rename**], then press **OK**.
↳ A keyboard screen is displayed.
- 5 Select the key to enter, then press **OK**.
 - Use the following options to edit.

Option	Action
Insert a space between the characters.	[Space]
Remove the character to the left of the cursor.	
Toggle between upper, lower case characters or symbols	 (Green button)
Clear all entries.	 (Yellow button)

- 6 To confirm, select [**Confirm**], then press **OK**.
↳ The title is renamed.

Hide an unwanted scene in a title



Note

- Once a scene is hidden, the scene is removed permanently.

- 1 Press **HOME**.
- 2 Select [**Recorded Titles**], then press **OK**.
- 3 Select a title, then press the **Yellow** button [**Edit**].
↳ The HDD edit menu is displayed..
- 4 Select [**Edit Title**] > [**A-B Erase**], then press **OK**.
↳ The title screen is displayed in pause mode.

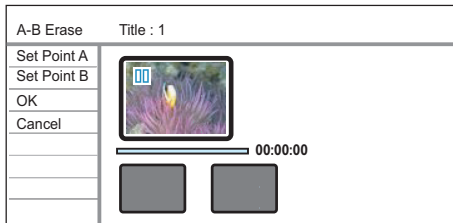

- 5 Press **▶||**.
↳ Playback begins.
 - To make a fast forward or reverse search, press and hold the **◀▶** buttons.
 - In pause mode, to move frame by frame, press the **◀▶** buttons.
- 6 To set the start point, select [**Set Point A**], then press **OK**.
- 7 Locate the end point, select [**Set Point B**], then press **OK**.
↳ The scene to erase is marked.
 - To cancel, select [**Cancel**], then press **OK**.
- 8 To proceed, select [**OK**], then press **OK**.
↳ This scene is removed.

Divide a title

- 1 Press **HOME**.
- 2 Select [**Recorded Titles**], then press **OK**.
- 3 Select a title, then press the **Yellow** button [**Edit**].
↳ The HDD edit menu is displayed..
- 4 Select [**Edit Title**] > [**Divide**], then press **OK**.
↳ The title screen is displayed in pause mode.

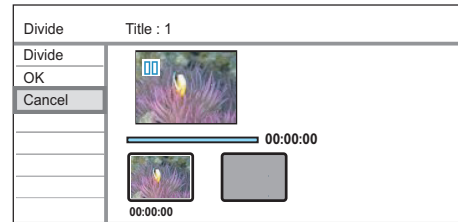

- 5 Press **▶||**.
↳ Playback begins.
 - To make a fast forward or reverse search, press and hold the **◀▶** buttons.
 - In pause mode, to move frame by frame, press the **◀▶** buttons.
- 6 Select [**Divide**], then press **OK**.
↳ The title divide point is marked.
 - To cancel, select [**Cancel**], then press **OK**.
- 7 To proceed, select [**OK**], then press **OK**.
↳ A new title is created and is displayed in the list of HDD titles.

Protect/ Unprotect a title

You can protect the recorded title to prevent any accidental loss of recordings.

- 1 Press **HOME**.
- 2 Select [**Recorded Titles**], then press **OK**.
- 3 Select a title, then press the **Yellow** button [**Edit**].
↳ The HDD edit menu is displayed.
- 4 Select [**Edit Title**] > [**Protect**], then press **OK**.
↳ A confirmation message is displayed.
 - To cancel, select [**Cancel**], then press **OK**.
- 5 To proceed, select [**OK**], then press **OK**.
↳ The title is protected. It cannot be erased or edited.

To unprotect a title,

- 1 Repeat steps 1 - 3, select [**Edit Title**] > [**Unprotect**], then press **OK**.
↳ A confirmation message is displayed.
 - To cancel, select [**Cancel**], then press **OK**.
- 2 To proceed, select [**OK**], then press **OK**.
↳ The title is unprotected.

Delete a title

- 1 Press **HOME**.
- 2 Select [**Recorded Titles**], then press **OK**.

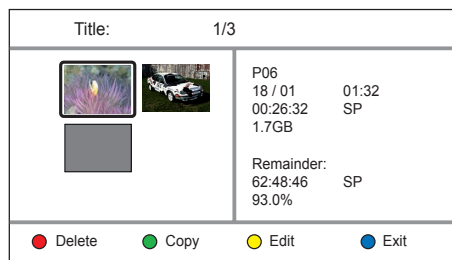

- 3 Select a title, then press the **Red** button [**Delete**].
↳ A confirmation message is displayed.
 - To cancel, select [**Cancel**], then press **OK**.
- 4 To proceed, select [**OK**], then press **OK**.
↳ The title is deleted.

Manage titles by genre

You can assign each HDD title to a genre group and search for it by its genre later. You can also create your personal genre groups.

Assign a genre

- 1 Press **HOME**.
- 2 Select [**Recorded Titles**], then press **OK**.
- 3 Select a title, then press the **Yellow** button [**Edit**].
↳ The HDD edit menu is displayed.
- 4 Select [**Set Genre**], then press **▶**.

Edit	Set Genre	
Play	No Genre	
Erase	Movies	
Edit Title	Sport	
Set Genre	Children	
Sort Format	Other	
	Pre-defined 1	P06 10 / 01 10:08
	Pre-defined 2	00:30:21 SP
	Pre-defined 3	1.0GB

● Back ● ● ● Exit

- 5 Select a genre, then press **OK**.
↳ The title is tagged to this genre.

Display format

To set sort format

- 1 Press **HOME**.
- 2 Select [**Recorded Titles**], then press **OK**.
- 3 Select a title, then press the **Yellow** button [**Edit**].
↳ The HDD edit menu is displayed..
- 4 Select [**Sort Format**] > [**Sort**], then press **OK**.

Edit	Sort Format	
Play	Sort	
Erase	Sort by Genre	
Edit Title	Create Genre	
Set Genre		
Sort Format		
		P06 10 / 01 10:08
		00:30:21 SP
		1.0GB

● Back ● ● ● Exit



- 5 Select an option and press **OK**.
 - [**Recent First**]
The most recent recording is displayed first.
 - [**Oldest First**]
The oldest recording is displayed first.
 - [**Name Ascending**]
The recordings are listed alphabetically from A - Z.
 - [**Name Descending**]
The recordings are listed alphabetically from Z to A.

To sort by genre

- 1 Press **HOME**.
- 2 Select [**Recorded Titles**], then press **OK**.
- 3 Select a title, then press the **Yellow** button [**Edit**].
- 4 Select [**Sort Format**] > [**Sort by Genre**], then press **OK**.
- 5 Select an option and press **OK**.
↳ The HDD titles in the genre group is displayed.

Create a new genre

- 1 Press **HOME**.
- 2 Select [**Recorded Titles**], then press **OK**.
↳ The list of recorded titles is displayed.
- 3 Select a title, then press the **Yellow** button [**Edit**].
↳ The HDD edit menu is displayed.
- 4 Select [**Sort Format**] > [**Create Genre**], then press **OK**.
- 5 Press the **Yellow** button [**Edit**].
↳ A keyboard screen is displayed.
- 6 Select the key to enter, then press **OK**.
 - Use the following options to edit.

Option	Action
Insert a space between the characters.	[Space]
Remove the character to the left of the cursor.	[]
Toggle between upper, lowercase characters or symbols.	 (Green button)
Clear all entries.	 (Yellow button)

- 7 To confirm, select [**Confirm**], then press **OK**.
↳ The new genre is created.

Edit a genre name



Note

- Only genre names beginning with [Pre-defined _] can be edited.

- 1 Press **HOME**.
- 2 Select [**Recorded Titles**], then press **OK**.
- 3 Select a title and press the **Yellow** button [**Edit**].
- 4 Select [**Sort Format**] > [**Create Genre**], then press **OK**.
- 5 Select the genre to rename and press **OK**.
↳ A keyboard screen is displayed.
- 6 Select the key to enter, then press **OK**.
 - Use the following options to edit.

Option	Action
Insert a space between the characters.	[Space]
Remove the character to the left of the cursor.	[]
Toggle between upper, lowercase characters or symbols.	 (Green button)
Clear all entries.	 (Yellow button)

- 7 To confirm, select [**Confirm**], then press **OK**.
↳ The genre name is edited.

Edit titles on a recordable DVD



Note

- If a DVDR has been finalised, it cannot be edited.

The disc edit menu provides to disc editing functions:

- Edit title name
- Edit disc name
- Hide/ unhide a scene
- Divide a title (DVDRWs only)
- Protect/ unprotect a title
- Delete a title
- Erase a disc

Edit the title name



The title name is automatically generated by the recorder. You can edit the title name.

- 1 Press **DISC MENU**.
- 2 Select a title and press the **Yellow** button [**Edit**].

Edit	Title	
Play	Erase	 P06 10 / 01 10:08 00:30:21 SP 1.0GB
Title	A-B Hide	
Disc	Unhide	
	Rename	
	Divide	
	Protect	
Back		
		Exit

- 3 Select [**Title**] > [**Rename**], then press **OK**.
↳ A keyboard screen is displayed.

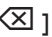
- 4 Select the key to enter, then press **OK**.
- Use the following options to edit.



Option	Action
Insert a space between the characters.	[Space]
Remove the character to the left of the cursor.	[]
Toggle between upper, lowercase characters or symbols.	 (Green button)
Clear all entries.	 (Yellow button)

- 5 To confirm, select [**Confirm**], then press **OK**.
- ↳ The title name is edited.

Edit the disc name

The disc name is automatically generated by the recorder. You can edit the disc name.

- Press **DISC MENU**.
↳ The disc menu is displayed.
- Select a title and press the **Yellow** button [**Edit**].
- Select [**Disc**] > [**Label**], then press **OK**.
↳ A keyboard screen is displayed.
- Select the key to enter, then press **OK**.
 - Use the following options to edit.

Option	Action
Insert a space between the characters.	[Space]
Remove the character to the left of the cursor.	[]
Toggle between uppercase, lowercase characters or symbols.	 (Green button)
Clear all entries.	 (Yellow button)

- 5 To confirm, select [**Confirm**], then press **OK**.
- ↳ The disc name is edited.

Hide an unwanted scene in a title (DVDRW only)

- 1 Press **DISC MENU**.
- 2 Select a title and press the **Yellow** button [**Edit**].
- 3 Select [**Title**] > [**A-B Hide**], then press **OK**.
↳ The title is displayed in pause mode.



- 4 Press **▶||**.
↳ Playback begins.
 - To make a fast forward or reverse search, press and hold the **◀▶** buttons.
 - In pause mode, to move frame by frame, press the **◀▶** buttons.
- 5 To set the start point, select [**Set Point A**], then press **OK**.
- 6 Locate the end point, select [**Set Point B**], then press **OK**.
↳ The scene to be erased is marked.
 - To cancel, select [**Cancel**], then press **OK**.
- 7 To proceed, select [**OK**], then press **OK**.
↳ This scene is hidden during play.

To unhide a hidden scene (DVDRW only)

- 1 Press **DISC MENU**.
- 2 Select the title and press the **Yellow** button [**Edit**].
- 3 Select [**Title**] > [**Unhide**], then press **OK**.
↳ The hidden scene is revealed.



Tip

- If the [**Unhide**] option is not available, there are no hidden scenes in the title.

Divide a title (DVDRW only)

Divide a title into two or more titles. The title length must be more than 6 (six) seconds.



Warning!

- Once a title is divided, it cannot be merged.

- 1 Press **DISC MENU**.
- 2 Select a title and press the **Yellow** button [**Edit**].
- 3 Select [**Title**] > [**Divide**], then press **OK**.
↳ The title is displayed in pause mode.

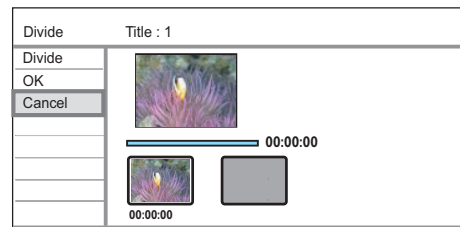

- 4 Press **▶||** to start play.
 - To make a fast forward or reverse search, press the **◀▶** buttons.
 - In pause mode, to move frame by frame, press the **◀▶** buttons.
- 5 Select **[Divide]**, then press **OK**.
 - ↳ The title divide point is marked.
 - To cancel, select **[Cancel]**, then press **OK**.
- 6 To proceed, select **[OK]**, then press **OK**.
 - ↳ A new title is created and is displayed in the disc menu index.

Protect/ Unprotect a title

You can protect the recorded title to prevent accidental loss of recordings.

- 1 Press **DISC MENU**.
- 2 Select a title and press the **Yellow** button **[Edit]**.
- 3 Select **[Title] > [Protect]**, then press **OK**.
 - ↳ A confirmation message is displayed.
 - To cancel, select **[Cancel]**, then press **OK**.
- 4 To proceed, select **[OK]**, then press **OK**.
 - ↳ The title is now protected. It cannot be erased or edited.

To unprotect a title,

- 1 Repeat steps 1 - 3, select **[Unprotect]**, then press **OK**.
 - ↳ A confirmation message is displayed.

Delete a title

- 1 Press **DISC MENU**.
- 2 Select a title and press the **Red** button **[Delete]**.
 - ↳ A confirmation message is displayed.
 - To cancel, select **[Cancel]**, then press **OK**.
- 4 To proceed, select **[OK]**, then press **OK**.
 - ↳ The title is deleted.

Erase a disc

- 1 Press **DISC MENU**.
- 2 Select a title, then press the **Yellow** button **[Edit]**.
 - ↳ The disc edit menu is displayed..

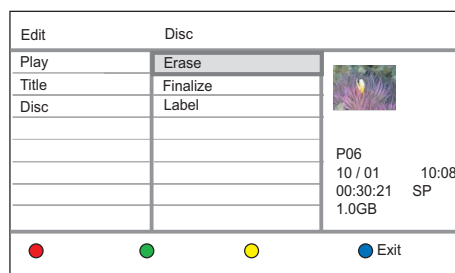

- 3 Select **[Disc] > [Erase]**, then press **OK**.
 - ↳ A confirmation message is displayed.
 - To cancel, select **[Cancel]**, then press **OK**.
- 4 To proceed, select **[OK]**, then press **OK**.
 - ↳ All unprotected titles on the disc are erased.

Play your recordings on other players

To play this recorded DVDR or DVDRW on another DVD player, you have to either finalise the disc or make it compatible.

Prepare a DVDR for playback

Note

- Once a DVDR disc is finalised, no further recordings or editing can be made to it. Ensure that you have completed all recording and editing before finalising the disc.

- 1 Press **DISC MENU**.
- 2 Select a title and press the **Yellow** button [**Edit**].
- 3 Select [**Disc**] > [**Finalize**], then press **OK**.
 - ↳ A warning message is displayed.
 - To cancel, select [**Cancel**], then press **OK**.
- 4 To proceed, select [**OK**], then press **OK**.
 - ↳ Finalisation begins. The process takes a few minutes depending on the length of recordings. Do not open the disc tray or switch off the power as this may render the disc unusable.

Prepare a DVDRW for playback

- 1 Press **HOME**.
- 2 Select [**Settings**], then press **OK**.
- 3 Select [**Disc**] > [**Make Compatible**], then press **OK**.
 - ↳ A confirmation message is displayed.
 - To cancel, select [**Cancel**], then press **OK**.
- 4 To proceed, select [**OK**], then press **OK**.
 - The process takes a few minutes depending on the length of recordings. Do not open the disc tray or switch off the power as this may render the disc unusable.

Tip

- If the option [**Make Compatible**] is not available, the disc is already compatible for playback.

10 Copy Files

Copy recorded titles

Copy your HDD titles onto a recordable DVD for future viewing.

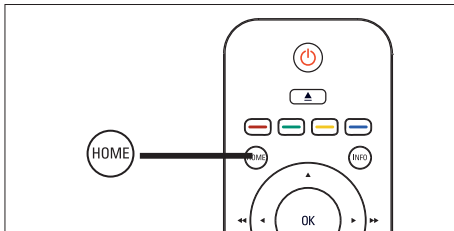

- 1 Press **HOME**.
- 2 Select [**Recorded Titles**], then press **OK**.

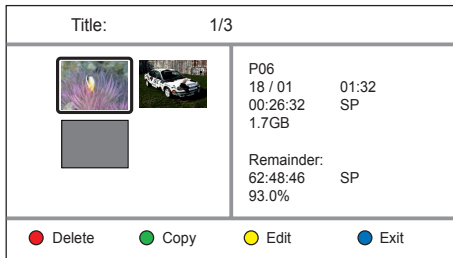

- 3 Select a title, then press the **Green** button [**Copy**].
↳ A confirmation message is displayed.
 - To cancel, select [**Cancel**], then press **OK**.
- 4 To proceed, select [**OK**], then press **OK**.
↳ The copying begins.

Tip

- If the disc does not have enough space, the HDD title is too large for copy. You have to edit or divide your HDD title before copy. See chapter 'Edit Recordings – Edit titles in the hard disk'.

Copy data files

Copy data files to Media Jukebox

Copy your media files (MP3, WMA, DivX and jpeg files) to the hard disk recorder. These files are stored in the Media Jukebox.

- 1 Insert a disc or connect a USB device.
- 2 Select a source:
 - **For discs:** press **DISC MENU**.
 - **For USB devices:** press **USB**.
↳ The content menu is displayed.
- 3 Select the media folder and press **▶**.
- 4 Select a file and press the **Yellow** button [**Edit**].
- 5 Select [**Copy**], then press **OK**.
↳ A message box is displayed. Follow the on-screen instructions.

To copy several files at once:

Tip

- You can mark several files before adding to the copylist. To mark or unmark a file, select the file and press the **▶** button.

- 1 Insert a disc or connect a USB device.
- 2 Select a source:
 - **For discs:** press **DISC MENU**.
 - **For USB devices:** press **USB**.
↳ The content menu is displayed.
- 3 Select the media folder and press **▶**.
- 4 Select a file and press the **Yellow** button [**Edit**].
- 5 Select [**Select**], then press **OK**.
↳ The file is selected for copy.p

- 6 Repeat steps 4 and 5 until you have finished your selection.
- 7 Select a title and press the **Yellow** button [**Edit**].
- 8 Select [**Copy**], then press **OK**.
 - ↳ A message box is displayed. Follow the on-screen instructions.

Copy data files to USB

You can copy your media files (MP3, WMA, DivX and jpeg files) stored in the hard disk recorder to your USB flash device.

- 1 Press **HOME**.

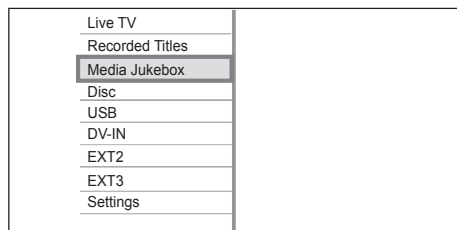

- 2 Select [**Media Jukebox**], then press **OK**.
 - This is a media jukebox where you can store your video, music and photos.
- 3 Select the media folder and press **▶**.
- 4 Select a file and press the **Yellow** button [**Edit**].
- 5 Select [**Copy**], then press **OK**.
 - ↳ A message box is displayed. Follow the on-screen instructions.

To copy several files at once:



Tip

- You can mark several files before adding to the copylist. To mark or unmark a file, select the file and press the **▶** button.

- 1 Press **HOME**.
- 2 Select [**Media Jukebox**], then press **OK**.
- 3 Select the media folder and press **▶**.
- 4 Select a file and press the **Yellow** button [**Edit**].
- 5 Select [**Select**], then press **OK**.
 - ↳ The file is selected for copy.
- 6 Repeat steps 4 and 5 until you have finished your selection.
- 7 Select a title and press the **Yellow** button [**Edit**].
- 8 Select [**Copy**], then press **OK**.
 - ↳ A message box is displayed. Follow the on-screen instructions.

11 Adjust Settings

Tuner Settings

Sort preset channels

- 1 Press **HOME**.
- 2 Select [**Settings**], then press **OK**.
- 3 Select [**Tuner**] > [**Manage Presets**] and press **OK**.
- 4 Select a channel and press **◀**.

	PR	Station	Fine	NICAM	Decoder	CH
Move Up	1	P01	0	On	Off	C01
Move Down	2	P02	0	On	Off	S08
NICAM	3	P03	0	On	Off	C05
Decoder	4	P04	0	On	On	C09
Rename	5	P05	0	Off	On	C21
Manual Setting	6	P06	0	On	On	C25
	7	P07	0	Off	Off	C27

- 5 Select [**Move Up**] or [**Move Down**].
- 6 Press **OK** repeatedly until the channel reaches the preferred position.
- 7 To return to the setup menu, press **BACK**.

Enable NICAM sound

NICAM is a digital sound transmission system. It transmits either one stereo channel or two separate mono channels.

- 1 Press **HOME**.
- 2 Select [**Settings**], then press **OK**.

- 3 Select [**Tuner**] > [**Manage Presets**] and press **OK**.
- 4 Select a channel and press **◀**.
- 5 Select [**NICAM**], then press **OK** repeatedly to toggle between:

[**On**]
Enable NICAM mode.

[**Off**]
Disable NICAM mode.
- 6 To return to the setup menu, press **BACK**.

Receive TV channels through the decoder

Note

- These instructions apply only if the TV channel is transmitted through a decoder connected to the EXT2 socket on the recorder.



- 1 Press **HOME**.
- 2 Select [**Settings**], then press **OK**.
- 3 Select [**Tuner**] > [**Manage Presets**] and press **OK**.
- 4 Select a channel and press **◀**.
- 5 Select [**Decoder**], then press **OK** repeatedly to toggle between:

[**On**]
Enable reception from the decoder.

[**Off**]
Disable reception from the decoder.
- 6 To return to the setup menu, press **BACK**.

Rename a channel

- 1 Press **HOME**.
- 2 Select [**Settings**], then press **OK**.
- 3 Select [**Tuner**] > [**Manage Presets**] and press **OK**.
- 4 Select a channel and press **◀**.
- 5 Select [**Rename**], then press **OK**.
↳ The keyboard screen is displayed.
- 6 Select the key to enter, then press **OK**.
 - Use the following options to edit.

Option	Action
Insert a space between the characters.	[Space]
Remove the character to the left of the cursor.	[⏪]
Toggle between upper, lowercase characters or symbols.	 (Green button)
Clear all entries.	 (Yellow button)

- 7 Once complete, select [**Confirm**], then press **OK**.
- 8 To return to the setup menu, press **BACK**.

Tune/ Modify a channel manually

- 1 Press **HOME**.
- 2 Select [**Settings**], then press **OK**.
- 3 Select [**Tuner**] > [**Manage Presets**] and press **OK**.
- 4 Select a channel and press **◀**.
- 5 Select [**Manual Setting**], then press **OK**.

Manual Setting				
PR	Seek(MHz)	CH	Fine	Standard
3	95.25	C21	0	PAL B/G
● Back ● Confirm				

- 6 Use **▲▼** keys to change the setting and **◀▶** keys to select the previous/next entry field.

[**PR**]

Displays the programme preset number.

[**Seek (MHz)**]

Use **▲▼** keys to search for a valid frequency transmission.

[**CH**]

Use **▲▼** keys to select a TV channel.

[**Fine**]

Use **▲▼** keys to increase/decrease the frequency by 0.06~0.07 MHz.

[**Standard**]

Use **▲▼** keys to select a TV system standard that produces the least distortion of picture and sound.

- 7 Once complete, press the **Green** button [**Confirm**].
- 8 To return to the setup menu, press **BACK**.

Change country of residence

- 1 Press **HOME**.
- 2 Select [**Settings**], then press **OK**.
- 3 Select [**Tuner**] > [**Country Setting**], then press **▶**.
- 4 Select an option and press **OK**.
- 5 To exit, press the **Blue** button [**Exit**].

Re-install all channels

Note

- All channels stored on the recorder will be reset.

- 1 Press **HOME**.
- 2 Select [**Settings**], then press **OK**.
- 3 Select [**Tuner**] > [**Auto Search**], then press **OK**.
 - ↳ A confirmation message is displayed.
 - To cancel, select [**Cancel**], then press **OK**.
- 4 To proceed, select [**OK**], then press **OK**.
 - ↳ Automatic channel tuning begins.
- 5 To exit the setup menu, press the **Blue** button [**Exit**].

Disc Settings

Format a recordable DVD disc

Some DVD VR, DVDR SL/DL and DVDRW discs need to be formatted before it can be used for recording on this recorder.

Note

- This option is required when you are using a rewritable DVD data disc (e.g. MP3, JPEG files) for video recording.
- Once the disc is formatted, all the contents on it will be removed.

- 1 Press **HOME**.
- 2 Select [**Settings**], then press **OK**.
- 3 Select [**Disc**] > [**Format**], then press **OK**.
 - ↳ A confirmation message is displayed.
 - To cancel, select [**Cancel**], then press **OK**.
- 4 To proceed, select [**OK**], then press **OK**.
 - ↳ This disc is formatted.
- 5 To exit the setup menu, press the **Blue** button [**Exit**].

Lock/ Unlock a disc

Prevent recordings from being accidentally erased or edited by locking the recordable DVD.



Note

- If the disc is locked, this option will change to [Unlock].

- 1 Press **HOME**.
- 2 Select [**Settings**], then press **OK**.
- 3 Select [**Disc**] > [**Lock**], then press **OK**.
 - ↳ A confirmation message is displayed.
 - To cancel, select [**Cancel**], then press **OK**.
- 4 To proceed, select [**OK**], then press **OK**.
 - ↳ The disc is locked.

To unlock a disc

- 1 Press **HOME**.
- 2 Select [**Settings**], then press **OK**.
- 3 Select [**Disc**] > [**Unlock**], then press **OK**.
 - ↳ A confirmation message is displayed.
 - To cancel, select [**Cancel**], then press **OK**.
- 4 To proceed, select [**OK**], then press **OK**.
 - ↳ The disc is unlocked.
- 5 To exit the setup menu, press the **Blue** button [**Exit**].

Prepare a DVDRW for playback

See chapter 'Edit Recordings – Play your recordings on other players'.

View disc information

Displays the current disc information.

- 1 Press **HOME**.
- 2 Select [**Settings**], then press **OK**.
- 3 Select [**Disc**] > [**Disc Info**], then press **OK**.
 - ↳ The disc information is displayed.

[Label]

Name of the disc.

[Title No.]

Total number of titles on the disc.

[Media]

Disc type.

[Status]

The status of the disc (recordable, blank, finalised or full).

[Space]

The capacity of the disc used for recording.

[Remainder]

The remaining time available for recording on the disc. It is dependent on the selected mode of recording quality.

- 4 To return to the setup menu, press **BACK**.
- 5 To exit the setup menu, press the **Blue** button [**Exit**].

Playback Settings

Select language options

Notes

- If the selected language is not available on the disc, the default disc language will be used instead.
- For some DVDs, the language can only be changed through the DVD disc menu. Press DISC MENU to access the menu.

- 1 Press **HOME**.
- 2 Select [**Settings**], then press **OK**.
- 3 Select [**Playback**], then press **▶**.
- 4 Select an option and press **▶**.
 - [**Audio Language**]
Select an audio language for DVD play.
 - [**Subtitle Language**]
Select a subtitle language for DVD play.
- 5 Select a setting and press **OK**.
- 6 To exit the setup menu, press the **Blue** button [**Exit**].

Set TV display format

The TV format refers to the aspect ratio of display according to the type of TV you have connected.

- 1 Press **HOME**.
- 2 Select [**Settings**], then press **OK**.
- 3 Select [**Playback**] > [**TV Shape**], then press **▶**.
- 4 Select an option and press **OK**.

[4:3 PS]



Select this for a full-height picture with both sides trimmed.

[4:3 LB]



Select this for a 'wide screen' display with black bands on the upper and lower portions of the TV screen.

[16:9]



Select this for a wide screen TV (frame ratio 16:9).

- 5 To exit the setup menu, press the **Blue** button [**Exit**].

Resume play from the last stopped point

See chapter 'Play – Play Video'.

View DivX(R) VOD registration code

Select to view the DivX® VOD (Video On Demand) registration code that allows you to rent or purchase videos using DivX® VOD services. For more information, visit www.divx.com/vod.

- 1 Press **HOME**.
- 2 Select [**Settings**], then press **OK**.
- 3 Select [**Playback**] > [**DivX® VOD DRM**], then press **OK**.
 - ↳ The registration code is displayed. Use this code to purchase or rent videos from DivX® VOD service at www.divx.com/vod.
- 4 To return to the setup menu, press **BACK**.
- 5 To exit the setup menu, press the **Blue** button [**Exit**].

Set DivX(R) subtitle font

- 1 Press **HOME**.
- 2 Select [**Settings**], then press **OK**.
- 3 Select [**Playback**] > [**DivX Subtitle Font**], then press **▶**.
- 4 Select an option and press **OK**.
 - [**Standard**]
Display a standard list of Roman subtitle fonts supported on this recorder.
 - [**Central Eur.**]
Display Central European fonts.
 - [**Cyrillic**]
Display Cyrillic fonts.
 - [**Greek**]
Display Greek fonts.
- 5 To exit the setup menu, press the **Blue** button [**Exit**].

Recording Settings

Select the recording quality

See chapter 'Record – Before you record'.

Select the recording language

See chapter 'Record – Before you record'.

Synchronise recording from a satellite receiver

See chapter 'Record – Record from other devices'.

Set chapter markers

See chapter 'Record – Record settings'.

Clear the Time Shift Buffer (TSB)

See chapter 'Watch live TV – Clear the Time Shift Buffer'.

Audio Settings

Set audio downmix

Select a suitable audio downmix when you are playing a DVD recorded in Dolby Digital format.

- 1 Press **HOME**.
- 2 Select [**Settings**], then press **OK**.
- 3 Select [**Audio**] > [**Downmix**], then press **▶**.
- 4 Select an option and press **OK**.

[**LT/RT**]

Select this if the recorder is connected to a Dolby Pro Logic decoder.

[**Stereo**]

Select this to downmix the multi-channel audio signals to two channels which delivers sound from only the two front speakers.

- 5 To exit the setup menu, press the **Blue** button [**Exit**].

Set digital output

Select a suitable setting if you have connected an audio/video device to the COAXIAL socket on the recorder.

- 1 Press **HOME**.
- 2 Select [**Settings**], then press **OK**.
- 3 Select [**Audio**] > [**Digital Output**], then press **▶**.
- 4 Select an option and press **OK**.

[**PCM**]

Select this if the connected device cannot decode multi-channel audio. The recorder converts Dolby Digital and MPEG-2 multi-channel signals to PCM (Pulse Code Modulation).

[**All**]

Select this if the connected device supports multi-channel audio format. The audio output is played according to the audio stream on the disc.

- 5 To exit the setup menu, press the **Blue** button [**Exit**].

Set HDMI audio

See the chapter 'Adjust Settings – Adjust HDMI video and audio'.

Enable night mode

Night mode optimises playback of sound at low volumes

- 1 Press **HOME**.
- 2 Select [**Settings**], then press **OK**.
- 3 Select [**Audio**] > [**Night Mode**], then press **▶**.
- 4 Select an option and press **OK**.

[**On**]

Enable night mode. High volume outputs are softened and low volume outputs are increased to an audible level.

[**Off**]

Disable night mode. Enjoy surround sound with its full dynamic range.

- 5 To exit the setup menu, press the **Blue** button [**Exit**].

Video Settings

Set HDMI video

See the chapter 'Adjust Settings – Adjust HDMI video and audio'.

Select SCART video input

This option enhances the video display of the device connected to the EXT2 socket.

- 1 Press **HOME**.
- 2 Select [**Settings**], then press **OK**.
- 3 Select [**Video**] > [**SCART Input**], then press **▶**.
- 4 Select an option and press **OK**.

[**CVBS**]

Recommended for most external devices.

[**RGB**]

Select this if the external device supports RGB output.

- 5 To exit the setup menu, press the **Blue** button [**Exit**].

System settings

Change system menu language

- 1 Press **HOME**.
- 2 Select [**Settings**], then press **OK**.
- 3 Select [**System**] > [**Menu Language**], then press **▶**.
- 4 Select an option and press **OK**.
- 5 To exit the setup menu, press the **Blue** button [**Exit**].

Adjust time and date



Notes

- Automatic time date download occurs only when the recorder is in standby mode.
- During update in standby mode, the recorder behaves as follows:
 - 1) The message on the front panel display switches from the current time to 'PHILIPS'.
 - 2) Once the update completes, the recorder switches back to standby and the current time is displayed.

- 1 Press **HOME**.
- 2 Select [**Settings**], then press **OK**.
- 3 Select [**System**] > [**Clock Setting**], then press **▶**.
- 4 Select an option and press **OK**.

[**Manual**]

Set the time and date.

- Enter the correct time and date, then press **OK** to confirm.

[**Auto**]

Enable/ disable automatic time/date setting.

- Select an option, then press **OK**.
- [**On**]
Enable automatic time/date update. The time and date are set according to the first preset channel which transmits time and date signals. Updates occur daily.
- [**Off**]
Disable automatic time/date update.

- 5 To exit the setup menu, press the **Blue** button [**Exit**].

Set screen saver

The screen saver protects the TV screen from damage due to prolong exposure to a static image. It is enabled by default.

- 1 Press **HOME**.
- 2 Select [**Settings**], then press **OK**.
- 3 Select [**System**] > [**Screen Saver**], then press **▶**.
- 4 Select an option and press **OK**.

[**On**]

The screen saver is activated. The screen saver is displayed after 5 minutes of inactivity.

[**Off**]

The screen saver is disabled.

- 5 To exit the setup menu, press the **Blue** button [**Exit**].

Set energy saving mode

This an energy saving mode.

- 1 Press **HOME**.
- 2 Select [**Settings**], then press **OK**.
- 3 Select [**System**] > [**Eco mode**], then press **▶**.
- 4 Select an option and press **OK**.

[**On**]
Enable energy saving mode. In standby mode, the front panel display is switched off.

[**Off**]
Disable energy saving mode.
- 5 To exit the setup menu, press the **Blue** button [**Exit**].

View hard disc information

Displays the hard disk information.

- 1 Press **HOME**.
- 2 Select [**Settings**], then press **OK**.
- 3 Select [**System**] > [**HDD Info**], then press **OK**.
↳ The hard disk information is displayed.

[**Recorded Titles Space**]
The capacity of the hard disk used for recorded titles.

[**Media Jukebox Space**]
The capacity of the hard disk used for the Media Jukebox.
- 4 To return to the setup menu, press **BACK**.
- 5 To exit the setup menu, press the **Blue** button [**Exit**].

Format hard disk

The hard disk stores all the HDD title recordings and media files. These content are removed when your format the hard disk.

- 1 Press **HOME**.
- 2 Select [**Settings**], then press **OK**.
- 3 Select [**System**] > [**Format HDD**], then press **OK**.
↳ A confirmation message is displayed.
 - To cancel, select [**Cancel**], then press **OK**.
- 4 To proceed, select [**OK**], then press **OK**.
↳ The hard disk is formatted. All HDD titles are deleted.

Restore default settings

This setting resets the recorder to factory default settings.



Note

- After the reset, the initial setup is required.

- 1 Press **HOME**.
- 2 Select [**Settings**], then press **OK**.
- 3 Select [**System**] > [**Restore default**], then press **OK**.
 - ↳ A confirmation message is displayed.
 - To cancel, select [**Cancel**], then press **OK**.
- 4 To proceed, select [**OK**], then press **OK**.
 - ↳ Once complete, the recorder switches off, then restarts. (See chapter 'Get Started - First Time settings').

Manage Easylink settings



Notes

- Your TV and other connected devices must be compliant with HDMI CEC.
- Philips does not guarantee 100% interoperability with all HDMI-CEC devices.

Enable Easylink

Before you start...

You must switch on the HDMI CEC operations on your TV/devices to enjoy the EasyLink controls. See your TV/devices manual for details.

- 1 Press **HOME**.
- 2 Select [**Settings**], then press **OK**.
- 3 Select [**Misc**] > [**Easylink**], then press **▶**.
- 4 Select an option and press **OK**.

[**On**]

Enable HDMI CEC compliant TV/devices to control each other with a single remote control.

[**Off**]

Disable the feature.

- 5 To exit the setup menu, press the **Blue** button [**Exit**].

Adjust HDMI video and audio

Before you start...

Ensure that the recorder is connected to a HDMI TV. (See chapter "Connect – Connect video/audio cables – Option 4").

Adjust HDMI video

- 1 Turn on the TV to the correct viewing channel for the recorder.
- 2 Press **HOME**.
- 3 Select [**Settings**], then press **OK**.
- 4 Select [**Video**] > [**HDMI Resolution**], then press **▶**.

Setup	Video	HDMI Resolution
Tuner	HDMI Resolution	✓ Auto
Disc	SCART Input	Native
Playback		480i
Recording		480p
Video		576i
Audio		576p
System		720p
Misc		1080i

- 5 Select an option and press **OK**.

[**Auto**]

Display follows the best supported video resolution of the connected HDMI TV.

[**Native**]

Display follows the video resolution of the connected HDMI TV.

[**480i**], [**480p**], [**576i**], [**576p**],
[**720p**], [**1080i**] or [**1080p**]

Select a suitable video resolution according to the capability of the connected TV: "i" denotes interlace and "p" denotes progressive.

- 6 To exit the setup menu, press the **Blue** button [**Exit**].

Adjust HDMI audio



Note

- Ensure that you have alternative audio connection from the recorder to your TV or the display device for the sound output.
- It is not possible to listen to SACDs or copy-controlled DVD-Audio CPPM (Content Protection for Playable Media) sources using the HDMI connection.

- 1 Press **HOME**.
- 2 Select [**Settings**], then press **OK**.
- 3 Select [**Audio**] > [**HDMI Audio**], then press **▶**.

Setup	Audio	HDMI Audio
Tuner	Downmix	✓ Auto
Disc	Digital Output	Disable
Playback	HDMI Audio	
Recording	Night Mode	
Video		
Audio		
System		
Misc		

- 4 Select an option and press **OK**.

[**Auto**]

Select to enjoy the multi-channel audio output through your HDMI connection.

[**Disable**]

Select this if the connected device is unable to output the sound through the HDMI connection or the playback audio format is not supported by HDMI connection (e.g., projector, SACD).

- 5 To exit the setup menu, press the **Blue** button [**Exit**].

12 Additional Information

Upgrade software

The software installed in your recorder is continuously being refined for greater stability and compatibility of the set. Periodically, Philips issues upgrades for the software which you can copy onto your USB flash drive to install on your recorder.



Caution!

- Power supply must not be interrupted during upgrade!

Check the software version

- 1 Press **HOME**.
- 2 Select [**Settings**], then press **OK**.
- 3 Select [**Misc**] > [**Version Info**], then press **OK**.
 - ↳ The software version of the recorder is displayed.
- 4 To return to the setup menu, press **BACK**.

Copy upgrade information



Note

- When checking for the latest software upgrade, please also check for any accompanying instructions on installing the software.

- 1 Insert a USB flash drive to the USB socket on the front panel of the recorder.
- 2 Press **HOME**.
- 3 Select [**Settings**], then press **OK**.
- 4 Select [**Misc**] > [**Product Support**], then press **▶**.
- 5 Select [**Copy to USB**], then press **OK**.
 - ↳ A confirmation message is displayed.
 - To cancel, select [**Cancel**], then press **OK**.
- 6 To proceed, select [**OK**], then press **OK**.
 - ↳ The information is copied to the USB flash drive.
- 7 Once copying completes, press **OK** and remove the USB flash drive.
- 8 Plug the USB flash drive to a personal computer with internet access.
 - ↳ Select the html file and you will be directed to a web page to download the latest software.
- 9 Follow the on-screen instructions and download the required software.

Care

Energy saving

In order to minimise the power consumption in standby mode, we recommend you to enable Eco mode. See chapter 'Adjust settings - [Video] settings – Set energy saving mode'.

Clean discs



Caution!

- Never use solvents such as benzene, thinner, cleaners available commercially, or anti-static sprays intended for discs.

Wipe the disc with a micro fibre cleaning cloth from the centre to the edge in a straight line movement.

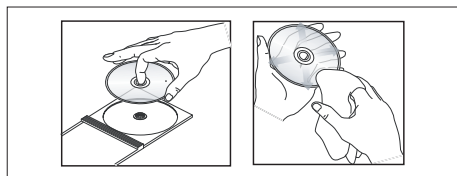

About DivX subtitle font

Most of the DivX® videos embedded with multiple subtitles. In order to display the subtitle correctly on the screen, you may need to change the character set to which supports the selected DivX® subtitle.

To access the font options during play of a DivX® video, press **OPTIONS** on the remote control.

Character set /DivX Subtitle	Subtitle language
Standard	Albanian, Danish, Dutch, English, Faeroese, Finnish, French, German, Irish, Italian, Norwegian (Bokmål and Nynorsk), Portuguese, Rhaeto-Romanic, Scottish Gaelic, Spanish, Swedish, Turkish, as well as the African languages Afrikaans and Swahili
Central Europe	Albanian, Bosnian, Croatian, Czech, Hungarian, Italian, Polish, Romanian, Slovak, Slovenian, and Irish Gaelic
Cyrillic	Belarusian, Bulgarian, Macedonian, Russian, Serbian, and Ukrainian
Greek	Greek



Note

- Ensure that the subtitle file has the exact same file name as the movie file. If for example the filename of the movie is 'Movie.avi', then you will need to name the text file 'Movie.sub' or 'Movie.srt'.

TV System Guide

COUNTRY	VHF	UHF	DVD REGIONS
AFGHANISTAN	PAL/SECAM B		5
ALBANIA	PAL B	PAL G	2
ALGERIA	PAL B	PAL G	5
ANGOLA	PAL I		5
ARGENTINA	PAL N	PAL N	4
AUSTRALIA	PAL B	PAL H	4
AUSTRIA	PAL B	PAL G	2
AZORES	PAL B		
BAHAMAS	NTSC M		4
BAHRAIN	PAL B	PAL G	2
BANGLADESH	PAL B		5
BARBADOS	NTSC M		4
BELGIUM	PAL B	PAL H	2
BERMUDA	NTSC M		
BOLIVIA	NTSC M	NTSC M	4
BOTSWANA	PAL I		5
BRAZIL	PAL M	PAL M	4
BRUNEI	PAL B	PAL B	
BULGARIA	SECAM D	SECAM K	2
BURKINA FASO	SECAM K1		5
BURMA	NTSC M		
BURUNDI	SECAM K1		5
CAMBODIA	NTSC M		3
CAMEROON	PAL B	PAL G	5
CANADA	NTSC M	NTSC M	1
CANARY ISLANDS	PAL B		2
CHAD	SECAM K1		5
CHILE	NTSC M	NTSC M	4
CHINA	PAL D		6
COLOMBIA	NTSC M	NTSC M	4
COSTA RICA	NTSC M	NTSC M	4
CROATIA	PAL B	PAL G	2
CUBA	NTSC M	NTSC M	4
CYPRUS	PAL B	PAL G	
CZECH REPUBLIC	PAL D	PAL K	2
DAHOMY	SECAM K1		
DENMARK	PAL B	PAL G	2
DJIBOUTI	SECAM B	SECAM G	5
DOMINICAN REP	NTSC M	NTSC M	4
ECUADOR	NTSC M	NTSC M	4
EGYPT	SECAM B/PAL B	SECAM G/PAL G	2
EL SALVADOR	NTSC M	NTSC M	4
EQUAT. GUINEA	PAL B		5
ESTONIA	PAL B (was SECAM)	PAL D	5
ETHIOPIA	PAL B	PAL G	5
FIJI	PAL B		
FINLAND	PAL B	PAL G	2
FRANCE	SECAM L	SECAM L	2
FRENCH POLYNESIA	SECAM K1		
GABON	SECAM K1		5
GAMBIA	PAL I		5
GERMANY	PAL B	PAL G	2
GHANA	PAL B	PAL G	5
GIBRALTAR	PAL B	PAL H	2
GREECE	PAL B (was SECAM)	PAL G	2
GREENLAND	NTSC/PAL B		2
GUADELOUPE	SECAM K1		
GUAM	NTSC M		1
GUATEMALA	NTSC M	NTSC M	4
GUINEA	PAL K		5
GUYANA (FRENCH)	SECAM K1		4
HONDURAS	NTSC M	NTSC M	4

COUNTRY	VHF	UHF	DVD REGIONS
LIBYA	SECAM B	SECAM G	5
LITHUANIA	PAL D (was SECAM)	PAL K	5
LUXEMBOURG	PAL B/SECAM L	PAL G/SEC L	2
MADAGASCAR	SECAM K1		5
MADEIRA	PAL B		
MALAGASY	SECAM K1		
MALAWI	PAL B	PAL G	5
MALAYSIA	PAL B		3
MALI	SECAM K1		5
MALTA	PAL B	PAL H	2
MARTINIQUE	SECAM K1		
MAURITANIA	SECAM B		5
MAURITIUS	SECAM B		5
MEXICO	NTSC M	NTSC M	4
MONACO	SECAM L		2
MONGOLIA	SECAM D		5
MOROCCO	SECAM B		5
MOZAMBIQUE	PAL B		5
NAMIBIA	PAL I		5
NEPAL	PAL B		
NETHERLANDS	PAL B	PAL G	2
NETH. ANTILLES	NTSC M	NTSC M	
NEW CALEDONIA	SECAM K1		
NEW GUINEA	PAL B	PAL G	4
NEW ZEALAND	PAL B	PAL G	4
NICARAGUA	NTSC M	NTSC M	4
NIGER	SECAM K1		5
NIGERIA	PAL B	PAL G	5
NORWAY	PAL B	PAL G	2
OMAN	PAL B	PAL G	2
PAKISTAN	PAL B		5
PANAMA	NTSC M	NTSC M	4
PARAGUAY	PAL N	PAL N	4
PERU	NTSC M	NTSC M	4
PHILIPPINES	NTSC M	NTSC M	3
POLAND	PAL D	PAL K	2
PORTUGAL	PAL B	PAL G(was SECAM D)	2
PUERTO RICO	NTSC M	NTSC M	1
QATAR	PAL B		2
REUNION	SECAM K1		
RUMANIA	PAL D	PAL K	2
RUSSIA	SECAM D	SECAM K	5
RWANDA	SECAM K1		5
SABAH/SAWARA	PAL B		
ST. KITTS	NTSC M	NTSC M	
SAMOA (US)	NTSC M		1
SAUDI ARABIA	SECAM-B/PAL-B	SECAM G	2
SENEGAL	PAL		5
SEYCHELLES	PAL B	PAL G	5
SIERRA LEONE	PAL B	PAL G	5
SINGAPORE	PAL B	PAL G	
SLOVAK REPUBLIC	PAL		2
SOMALIA	PAL B	PAL G	5
SOUTH AFRICA	PAL I	PAL I	2
SPAIN	PAL B	PAL G	2
SRI LANKA	PAL B		5
SUDAN	PAL B	PAL G	5
SURINAM	NTSC M	NTSC M	4
SWAZILAND	PAL B	PAL G	
SWEDEN	PAL B	PAL G	2
SWITZERLAND	PAL B	PAL G	2
SYRIA	SECAM B		2

Specifications



Note

- Specification and design are subject to change without notice.

Accessories supplied

- Remote control and batteries
- RF antenna cable
- SCART cable
- Quick Start Guide

Recording Media

- Recording media: HDD, DVD±R, DVD±RW, DVDR+DL

Playback Media

- DVD-Video, Video CD/SVCD, Audio CD, CD-R/CD-RW, DVD+R/+RW, DVD-R/-RW, Picture CD, MP3-CD, MP3-DVD, WMA-CD, USB flash drive
- Compression formats: MPEG2, MPEG1, DivX
- Video disc playback system: PAL, NTSC

Storage Media

- Hard Disk capacity:
 - HDR3800 - 160 GB
 - HDR3810 - 250 GB

Tuner/Reception/Transmission

- TV system: PAL
- Aerial Input: 75 Ohm coaxial (IEC75)

Picture/Display

- D/A converter: 10 bit, 54 MHz
- A/D converter: 10 bit, 27 MHz
- Picture enhancement: HDMI

Sound

- D/A converter: 24 bit, 192 kHz
- A/D converter: 24 bit, 96 kHz
- Signal to noise ratio: 102 dB
- Crosstalk (1kHz): 105 dB
- Dynamic Range (1kHz): 90 dB

Video Recording

- Recording system: PAL
- Compression formats: MPEG2
- Recording modes: High Quality (HQ), Standard Play (SP), Standard Play Plus (SPP), Long Play (LP), Extended Play (EP), Super Long Play (SLP)
- Audio compression: Dolby Digital, PCM

Audio Playback

- Compression formats: Dolby Digital, MPEG2 Multichannel, PCM, MP3, WMA
- MP3 bit rates: 32~256 kbps and VBR

Still Picture Playback

- Disc formats: Picture CD, DVD±R, DVD±RW, DVDR+DL
- Picture compression formats: JPEG
- Picture enhancement: Rotate, Zoom

Convenience

- Programming/Timer Enhancements: Electronic Programme Guide, Daily/Weekly, Repeat Programme, Manual Timer, One Touch Recording
- Programmable events: 14

Power

- Power supply: 230 - 240V; 50 Hz
- Consumption: 30 W (typical)
- Standby power consumption: < 4W
- Eco standby power consumption < 2.2 W

Cabinet

- Dimensions (W x H x D) : 435 x 49.8 x 323 mm
- Net Weight : 3.5 kg

Display panel symbols/ messages

The following symbols/ messages may appear on your recorder display:

00:00:00

Multifunction display/ text line

- Title/ track number
- Total/ elapsed/ remaining title/ track time
- Additional information regarding the disc
- TV channel number or source of video
- Clock (This is displayed in standby mode. It is switched off in eco mode).
- TV programme title

BUSY

- The recorder is writing to the disc.

ERR

- The software update was not successful.
- The disc tray is blocked from opening.

FULL

- Disc is full. There is no more space for new recordings.

PHILIPS

- The recorder has been turned on.

LOAD

- Disc is being recognised by the recorder.

NO DISC MENU

- No disc has been inserted. If a disc has been inserted, then it is possible that the disc cannot be read.

NO COPY

- During recording, the recorder has detected a copy protected video source. No recording will be made.

OPEN

- Disc tray is opened or opening.

REGION

- The region code of the DVD is different from the recorder.

MENU

- The home menu or timer menu is displayed.

STOP

- When playback/ recording is stopped.

TIMER

- A timer recording has been programmed or is active.

13 Troubleshooting



Warning!

- Risk of electric shock. Never remove the casing of this recorder.

To keep the warranty valid, never try to repair the system yourself.

If you encounter problems when using this recorder, check the following points before requesting service. If the problem remains unsolved, register your product and get support at www.philips.com/welcome.

Main Unit

No power.

- Press  button on the front of the recorder to turn on the system.
- Ensure that the AC outlet has power.



Remote control does not work.

- Aim the remote control directly at the sensor on the front of the recorder (not towards TV).
- Remove any obstacles between the recorder and the remote control.
- Batteries are weak, replace the batteries.

No TV signal received from the recorder.

- Check the connection to the antenna or cable TV signal.
- Manually tune and store the TV channel. See chapter "Adjust Settings – Tune/ Modify a channel manually".

Unable to eject tray.

- Exit from any on-screen menu.
- Press  to stop any playback or recording, then press .

Picture

No picture

- Check the video connections. See chapter "Connect".
- Turn on the TV to the Video In channel.
- Use the TV remote control to select the channel until you see the DVD screen. See chapter "Get Started".
- Check that the video cable (HDMI, CVBS or SCART) connecting the recorder to the TV is not damaged.

The picture is distorted or black and white during playback.

- The disc does not match with the TV colour system standard (PAL/NTSC).
- The disc is dirty, clean the disc.
- At times, some picture distortion may occur. This is not a malfunction.
- If you have connected the recorder to a HDMI TV:
 - Check if your TV supports the selected HDMI video resolution. Select a lower HDMI video resolution. (See chapter "Adjust settings - Setup HDMI video and audio").
 - Change to a better quality HDMI cable (e.g. Category 2 cable).

There is picture or sound interference with the TV reception.

- Check the connection to the antenna or cable TV signal.
- Fine-tune your TV channel. Read chapter "Adjust Settings".

Unable to display JPEG pictures.

- This unit only supports pictures in JPEG-Exif file format with a resolution not exceeding 4096 x 4096 (horizontal/vertical). JPEG pictures that are downloaded from the internet or have been modified using the computer may not be displayed properly.

Sound

No sound.

- Check the audio connections. See chapter "Connect".
- Depending on the audio device you have connected to the recorder, set the digital output accordingly. See chapter "Adjust Settings - Audio settings".

The connected amplifier produces distorted sound

- Do not connect any cables from the recorder to the 'Phono' input of your amplifier.
 - If you are playing a DTS CD, connect the Hi-Fi system or amplifier to the COAXIAL socket of this recorder.
-

No surround sound output on HDMI connection.

- It depends on your TV audio capabilities. In this case, connect COAXIAL DIGITAL OUT of this recorder to your TV or AV amplifier receiver. Disable the HDMI audio output.

Play

Disc does not play.

- Insert the disc with the label facing up.
- Wrong region code. The DVD must be coded for ALL regions or Region 2 for playback on this recorder.
- There is no recording on the disc or it is a wrong disc type. See chapter "Play - Play video".
- Ensure that the disc is not scratched or warped. Clean the disc or replace a new one.
- Check if the disc is defective by trying another disc.

Unable to play DivX movies

- Check that the DivX file is encoded according to the 'Home Theatre Profile' mode with DivX encoder.
- Check that the DivX movie downloaded is a complete file.

A DVDR/ DVDRW recorded on this DVD recorder does not play on a DVD player.

- If a recording is too short, it is possible that a DVD player cannot detect it. Please follow the minimum recording times for each recording mode : [HQ] – 5 mins, [SP] – 10 mins, [SPP] – 13 mins, [LP] - 15 mins, [EP] – 20 mins, [SLP] – 30 mins.
- You have to finalise the DVDR. See chapter "Edit Recordings - Play your recordings on other DVD Players".

The message 'UNKNOWN DISC' is displayed.

- This message may appear if you insert a disc that may have encountered one of the following:
 - Error during recording: the title may be missing.
 - Error while changing the title/ index picture: the original title/ index picture may be visible.
 - Error during the finalisation of the disc or the disc has not been finalised.

Recording

A TV channel installed during the DVD recorder's automatic TV channel search is fuzzy or distorted.

- Check the video connection between the DVD recorder and the TV.
- Press P + / - to search for the same TV channel which may have a clearer picture.
- You can fine-tune the signal of the TV channel. See chapter on "Adjust Settings – Tune/ Modify a channel manually".

Picture is fuzzy and brightness varies when copying DVD Video discs or pre-recorded video cassettes.

- This happens if you try to copy DVDs or video cassettes that are copy-protected. Even though the picture on the TV is fine, the recording on the recordable DVD disc appears distorted. This interference is unavoidable with copy-protected DVDs or video cassettes.
- The recordable DVD disc has a limited recording lifetime, please change to a new disc for recording.

Recordings are not occurring as scheduled. New recordings cannot be made.

- The TV channel you want is not stored or the wrong program number was selected. Check the TV channels stored.
- In the timer recording list, one of the following messages may be displayed in the [Status] column:
 - [Overlap] : the timer recording has coincided with another timer recording.
 - [Failed] : A power cut had occurred at the time of the scheduled recording.
 - [Overdue] : The clock setting was adjusted after setting the timer recording.
 - [To HDD] : The scheduled recording was recorded to the hard disk. The recordable DVD disc may be damaged or it may not have sufficient space for recording.

14 Glossary

Analogue sound

Sound that has not been converted into numbers. Analogue sound varies, while digital sound has specific numerical values. These sockets send audio through two channels, the left and right.

Aspect ratio

The ratio of vertical and horizontal sizes of a displayed image. The horizontal vs. vertical ratio of conventional TVs. is 4:3, and that of wide-screens is 16:9.

AUDIO OUT sockets

Red and white sockets that send audio to another system (TV, Stereo, etc).

Chapter

Sections of a picture or a music piece on a DVD that are smaller than titles. A title is composed of several chapters. Each chapter is assigned a chapter number enabling you to locate the chapter you want.

Component Video Out sockets:

Sockets that send high quality video to a TV that has Component Video In sockets (R/G/B, Y/Pb/Pr, etc).

Digital

Sound that has been converted into numerical values. Digital sound is available when you use the COAXIAL DIGITAL OUT. These sockets send audio through multiple channels, instead of just two channels as analogue does.

Disc menu

A screen display prepared for the selection of images, sounds, subtitles, multi-angles, etc recorded on a DVD.

DivX

The DivX code is a patent pending, MPEG-4 based video compression technology, developed by DivX Inc., that can shrink digital video to sizes small enough to be transported over the internet, while maintaining high visual quality.

Dolby Digital

A surround sound system developed by Dolby Laboratories containing up to six channels of digital audio (front left and right, surround left and right, centre and subwoofer).

HDMI CEC

HDMI Consumer Electronics Control enables linked functions of this recorder with HDMI CEC compliant devices using HDMI cables. You can control the basic operations of all the connected devices with a single remote control.

JPEG

A common digital still picture format. A still-picture data compression system proposed by the Joint Photographic Expert Group, which features small decrease in image quality in spite of its high compression ratio.

MP3

A file format with a sound data compression system. "MP3" is the abbreviation of Motion Picture Experts Group 1 (or MPEG-1) Audio Layer 3. By using the MP3 format, one CD-R or CD-RW can contain about 10 times more data than a regular CD.

MPEG

Motion Picture Experts Group. A collection of compression systems for digital audio and video.

Multichannel

DVDs are formatted to have each sound track constitute one sound field. Multichannel refers to a structure of sound tracks having three or more channels.

PBC - Playback Control

Refers to the signal recorded on video CDs or SVCDs for controlling playback. By using menu screens recorded on a Video CD or SVCD that supports PBC, you can enjoy interactive playback and searching.

PCM Pulse Code Modulation

A digital audio encoding system.

Region code:

A system allowing discs to be played only in the region designated. This unit will only play discs that have compatible region codes. You can find the region code of your unit by looking on the product label. Some discs are compatible with more than one region (or ALL regions).

S-Video

Produces a clear picture by sending separate signals for the luminance and the colour. You can use S-Video only if your TV has an S-Video In socket.

Surround sound

A system for creating realistic three dimensional sound fields full of realism by arranging multiple speakers around the listener.

Title

The section of a movie or music feature on DVD. Each title is assigned a title number, enabling you to locate the title you want.

VIDEO OUT socket

Yellow socket that sends the DVD picture video to a TV.



Philips Customer Care phone numbers:

Austria	0810 000205	€ 0.07/ min
Belgium	078 250 145	€ 0.06/ min
Czech Republic	800 142840	free
Denmark	3525 8759	pstn
Finland	09 2311 3415	pstn
France	0821 611655	€ 0.09/ min
Germany	01803 386 852	€ 0.09/ min
Greece	0 0800 3122 1280	free
Ireland	01 601 1777	pstn
Italy	840 320 086	€ 0.08/ min
Hungary	06 80018 189	pstn
Luxembourg	40 6661 5644	pstn
Netherlands	0900 8407	€ 0.10/ min
Norway	2270 8111	pstn
Poland	022 349 15 04	pstn
Portugal	2 1359 1442	pstn
Slovakia	0800 004537	free
Spain	902 888 784	€ 0.10/ min
Sweden	08 5792 9100	pstn
Switzerland	0844 800 544	pstn
United Kingdom	0870 900 9070	pstn

© 2008 Koninklijke Philips Electronics N.V.

All right reserved

12nc: 3139 245 29522

sgpj-0829/31-1