

User Manual	6
Руководство пользователя	64

Thank you for choosing Philips.

Need help fast?

Read your Quick Use/Start Guide and/or User Manual first for quick tips that make using your Philips product more enjoyable.

*If you have read your instructions and still need assistance, you may access our online help at **www.philips.com/support***



SHOWVIEW®

PHILIPS

Important notes for users in the U.K. Mains plug

This apparatus is fitted with an approved 13 Amp plug. To change a fuse in this type of plug proceed as follows:

- 1 Remove fuse cover and fuse.
- 2 Fix new fuse which should be a BSI 362 5 Amp, A.S.T.A. or BSI approved type.
- 3 Refit the fuse cover.

If the fitted plug is not suitable for your socket outlets, it should be cut off and an appropriate plug fitted in its place.

If the mains plug contains a fuse, this should have a value of 5 Amp. If a plug without a fuse is used, the fuse at the distribution board should not be greater than 5 Amp.

Note: The severed plug must be disposed of to avoid a possible shock hazard should it be inserted into a 13 Amp socket elsewhere.

How to connect a plug

The wires in the mains lead are coloured with the following code: blue = neutral (N), brown = live (L).

- As these colours may not correspond with the colour markings identifying the terminals in your plug, proceed as follows:
 - Connect the blue wire to the terminal marked N or coloured black.
 - Connect the brown wire to the terminal marked L or coloured red.
 - Do not connect either wire to the earth terminal in the plug, marked E (or e) or coloured green (or green and yellow).

Before replacing the plug cover, make certain that the cord grip is clamped over the sheath of the lead - not simply over the two wires.

Copyright in the U.K.

Recording and playback of material may require consent. See Copyright Act 1956 and The Performer's Protection Acts 1958 to 1972.

Italia

DICHIARAZIONE DI CONFORMITA'

Si dichiara che l'apparecchio DVDR3383, Philips risponde alle prescrizioni dell'art. 2 comma 1 del D.M. 28 Agosto 1995 n. 548.

Fatto a Eindhoven

Philips Consumer Electronics
Philips, Glaslaan 2
51616 Eindhoven, The Netherlands

Norge

Typeskilt finnes på apparatens underside.

Observer: Nettbryteren er sekundert innkoplet. Den innebygde nettdelen er derfor ikke frakoplet nettet så lenge apparatet er tilsluttet nettkontakten.

For å redusere faren for brann eller elektrisk støt, skal apparatet ikke utsettes for regn eller fuktighet.

Disposal of your old product



Your product is designed and manufactured with high quality materials and components, which can be recycled and reused.

When this crossed-out wheeled bin symbol is attached to a product it means the product is covered by the European Directive 2002/96/EC.

Please inform yourself about the local separate collection system for electrical and electronic products.

Please act according to your local rules and do not dispose of your old products with your normal household waste. The correct disposal of your old product will help prevent potential negative consequences for the environment and human health.

Утилизация старого устройства (Русский)



Ваше устройство спроектировано и изготовлено из высококачественных материалов и компонентов, которые можно утилизировать и использовать повторно.

Если товар имеет символ с зачеркнутым мусорным ящиком на колесах, это означает, что товар соответствует Европейской директиве 2002/96/ЕС.

Ознакомьтесь с местной системой раздельного сбора электрических и электронных товаров. Соблюдайте местные правила.

Утилизируйте старые устройства отдельно от бытовых отходов. Правильная утилизация вашего товара позволит предотвратить возможные отрицательные последствия для окружающей среды и человеческого здоровья.

DK

Advarsel: Usynlig laserstråling ved åbning når sikkerhedsafbrydere er ude af funktion. Undgå udsættelse for stråling.

Bemærk: Netafbryderen er sekundært indkoblet og afbryder ikke strømmen fra nettet. Den indbyggede netdel er derfor tilsluttet til lysnettet så længe netstikket sidder i stikkontakten.

S

Klass I laserapparat

Varning! Om apparaten används på annat sätt än i denna bruksanvisning specificerats, kan användaren utsättas för osynlig laserstrålning, som överskrider gränsen för laserklass I.

Observera! Stömbrytaren är sekundärt kopplad och bryter inte strömmen från nätet. Den inbyggda nätdelen är därför ansluten till elnätet så länge stickproppen sitter i vägguttaget.

SF

Luokan I laserlaite

Varoitus! Laitteen käyttäminen muulla kuin tässä käyttöohjeessa mainitulla tavalla saattaa altistaa käyttäjän turvallisuusluokan I ylittävälle näkymättömälle lasersäteilylle.

Oikeus muutoksiin varataan. Laite ei saa olla alttiina tippu- ja roiskevedelle.

Huom. Toiminnanvalitsin on kytketty toisiopuolelle, eikä se kytke laitetta irti sähköverkosta. Sisäänrakennettu verkko-osa on kytkettynä sähköverkkoon aina silloin, kun pistoke on pistorasiasassa.

Due to the inconsistency of disc formats provided by various disc manufacturers, your DVD system/ player/recorder may require a playability enhancement or upgrade. As DVD technology advances, these enhancement will become common and will be easy to complete. Go to www.philips.com/support for software upgrade.

CAUTION

VISIBLE AND INVISIBLE LASER RADIATION WHEN OPEN. AVOID EXPOSURE TO BEAM

ADVARSEL

SYNLIG OG USYNLIG LASERSTRÅLING VED ÅBNING UNDGÅ UDSÆTTELSE FOR STRÅLING

VARNING

SYNLIG OCH OSYNLIG LASERSTRÅLNING NÄR DENNA DEL ÄR ÖPPNAD BETRakta EJ STRÅLEN

VARO!

AVATTAESSA OLET ALTTIINA NÄKYVÄLLE JA NÄKYMÄTTÖMÄLLE LASER SÄTEILYLLE. ÄLÄ KATSO SÄTEESEEN

VORSICHT

SICHTBARE UND UNSICHTBARE LASERSTRAHLUNG WENN ABDECKUNG GEÖFFNET NICHT DEM STRAHL AUSSETZEN

ATTENTION

RAYONNEMENT LASER VISIBLE ET INVISIBLE EN CAS D'OUVERTURE EXPOSITION DANGEREUSE AU FAISCEAU

For Customer Use:

Read carefully the information located at the bottom or rear of your DVD Recorder and enter below the Serial No. Retain this information for future reference.

Model No. DVD RECORDER
DVDR3383

Serial No. _____

Due to the inconsistency of disc formats provided by various disc manufacturers, your DVD system/ player/recorder may require a playability enhancement or upgrade. As DVD technology advances, these enhancement will become common and will be easy to complete. Go to www.philips.com/support for software upgrade.

En raison de la diversité des formats utilisés par les fabricants, votre système DVD peut nécessiter l'ajout de périphériques ou une mise à niveau logicielle. Au fur et à mesure des progrès de la technologie DVD, ces périphériques se font de plus en plus courants et aisés à intégrer. Pour télécharger la mise à niveau logicielle, visitez le site www.philips.com/support.

Debido a los diferentes formatos de discos disponibles en el mercado, es posible que deba realizar mejoras o actualizaciones en el sistema de DVD relativas a las funciones de reproducción. Conforme la tecnología DVD avanza, estas mejoras estarán al alcance de todo tipo de usuarios y se podrán llevar a cabo fácilmente. Visite la página "www.philips.com/support" para buscar información sobre actualizaciones de software.

Da das Disk-Format je nach Hersteller verschieden ist, ist für Ihr DVD-System möglicherweise die Erweiterung der Spielbarkeit oder eine Aktualisierung erforderlich. Da die DVD-Technologie sich ständig weiterentwickelt, werden sich diese Erweiterungen durchsetzen und einfach auszuführen sein. Gehen Sie für Ihre Software-Aktualisierung zu „www.philips.com/support“.

Doordat fabrikanten verschillende schijfindelingen aanbieden, moet uw dvd-systeem mogelijk worden geüpgradet of uitgebreid. Naarmate de dvd-technologie zich verder ontwikkelt, zullen deze uitbreidingen normaal worden en zult u ze gemakkelijk kunnen uitvoeren. Ga naar "www.philips.com/support" om uw software te upgraden.

A causa della differenza di formato tra i dischi forniti dai vari produttori, il sistema DVD potrebbe richiedere un potenziamento o aggiornamento della riproducibilità. Col progredire della tecnologia DVD, questi potenziamenti diverranno comuni e facili da implementare. Visitare "www.philips.com/support" per scaricare gli aggiornamenti del software.

På grund af uoverensstemmelser mellem diskformater fra de forskellige diskproducenter, kan dit dvd-system kræve en afspilningsudvidelse eller en opgradering. Efterhånden som dvd-teknologien udvikles, vil disse udvidelser blive almindelige og vil være nemme at implementere. Gå til "www.philips.com/support", hvis du ønsker softwareopgradering.

Koska eri levyvalmistajat käyttävät erilaisia levyformaatteja, DVD-järjestelmäsi toimintoja täytyy ehkä laajentaa tai päivittää. DVD-teknikan kehittyessä nämä laajennukset yleistyvät ja ovat helposti toteutettavissa. Löydät ohjelmistopäivityksen sivustosta "www.philips.com/support".

Devido à inconsistência dos formatos de disco disponibilizados por vários fabricantes de discos, a capacidade de reprodução do seu sistema de DVD pode necessitar de ser melhorada ou atualizada. À medida que a tecnologia do DVD avança, estes melhoramentos tornam-se comuns e fáceis de completar. Visite "www.philips.com/support" para obter atualizações de software.

Λόγω της ασυνέπιας στην διαμόρφωση των δίσκων που παρέχονται από διάφορους κατασκευαστές δίσκων, το σύστημα DVD που χρησιμοποιεί νδέχεται να απαιτεί βελτίωση ή αναβάθμιση της δυνατότητας αναπαραγωγής. Καθώς εξίσταται η τεχνολογία των DVD, οι βελτιώσεις αυτές θα είναι συνηθισμένες και θα είναι ύκολο να ολοκληρωθούν. Μταβίτ στη διύθυνση "www.philips.com/support" για αναβάθμιση λογισμικού.

Ze względu na niekompatybilność formatów płyt oferowanych przez rozmaitych producentów, Twój system DVD może wymagać rozbudowy lub aktualizacji oprogramowania. W miarę zaawansowania technologii DVD możliwości tego rodzaju rozbudowy staną się powszechne i proste w realizacji. Odwiedź stronę "www.philips.com/support" aby pobrać aktualizację oprogramowania.

Из-за несовместимости форматов дисков различных производителей для вашей системы DVD может быть необходимо произвести обновления или улучшить воспроизводимость. С развитием технологии DVD эти улучшения станут широкоиспользуемыми и просто выполняемыми. Обновление программного обеспечения находится на вб-сайт "www.philips.com/support".

This product incorporates copyright protection technology that is protected by US patents. Use of this copyright protection technology must be authorised by Macrovision, and is intended for home and other limited viewing uses only, unless otherwise authorised by Macrovision. Reverse engineering or disassembly is prohibited.

U.S. Patent Number: 4,631,603; 4,819,098; 4,907,093; 5,315,448; and 6,516,132



Manufactured under license from Dolby Laboratories. "Dolby" and the double-D symbol are trademarks of Dolby Laboratories.

SHOWVIEW®

This is a simple programming system for recorders. To use it, enter the programming number associated with your television programme. You can find this number in your favourite listings magazine.

ShowView® is a registered trademark of Gemstar Development Corporation. The ShowView® system is manufactured under license from Gemstar Development Corporation.



DivX®, DivX® Certified, and associated logos are trademarks of DivX® Inc and are used under license.



i.Link is also known as 'FireWire' and 'IEEE1394'. This connection is used for the transfer of high bandwidth digital signals as used by digital video (DV) camcorders. It carries all audio and video signals via a single cable.

English 6

Русский 64

English

Русский

This product complies with the radio interference requirements of the European Community.



This product complies with the requirements of the following directives and guidelines: 73/23/EEC + 89/336/EEC + 93/68/EEC

LASER

Type	Semiconductor laser InGaAlP (DVD) AlGaAs (CD)
Wave length	658 nm (DVD) 790 nm (CD)
Output Power	30 mW (DVD+RW write) 1.0 mW (DVD read) 1.0 mW (CD read)
Beam divergence	84 degrees (DVD) 61 degrees (CD)

Table of Contents

General

Care and Safety Information	8
Setup precautions.....	8
Cleaning discs	8
About recycling.....	8
Product Information	9
Introduction.....	9
Accessories supplied	9
Region codes.....	9
Copyright notice.....	9

Product Overview

Remote Control	10
Using the remote control	12
Main Unit	13

Connections

Step 1: Basic Recorder Connections.....	14
Connecting the antenna cables	14
Connecting the video cable.....	15
Connecting the audio cables	16
Step 2: Optional Connections.....	17
Connecting to a Cable Box or Satellite Receiver	17
Connecting to a VCR or other similar device.....	18
Connecting to a VCR and Cable Box/Satellite Receiver.....	19
Connecting a camcorder to the front sockets.....	20
Step 3: Installation and Setup	21
Finding the correct viewing channel	21
Setting the OSD language	21
Select the country of your residence	22
Setting your TV channel programmes.....	22
Setting the date & time.....	23

Recording

Recording	24
Discs for recording	24
Recording settings	24
RECORD settings.....	25
Manual recording.....	26
One Touch Recording - automatic turn-off.....	26
About timer recording.....	27
Timer recording (manually).....	27
Timer recording (SHOWVIEW® System)	29
Changing/ Deleting a timer recording.....	30
Simultaneous recording and playback.....	30

Table of Contents

Playback

Playback	31
Playable discs	31
Inserting a disc	31
Starting disc playback	32
Additional Playback Features	36
Changing to another chapter/track	36
Pausing playback and step play	36
Searching forwards/backwards	36
Using T/C options	37

Edit Recordings

Editing/ Finalising Recording	40
About disc editing	40
Accessing disc editing menu	40
Playing your recordings (DVD±R) on other DVD players	42
About title editing	43
Accessing title editing menu	43
About video editing	45
Accessing video editing menu	45

Other Information

DVD System Menu Options	48
Accessing the System Menu	48
GENERAL settings	49
PLAYBACK settings	50
RECORD settings	52
LANGUAGE settings	52
CHANNEL SETUP settings	53
CLOCK settings	55
Software Upgrade	56
Installing the latest software	56
Specifications	57
Troubleshooting	58
Frequently Asked Questions	61
Glossary	62
Display panel symbols/ messages	63
TV System Guide	122

Care and Safety Information

CAUTION!

High voltage! Do not open the device. You run the risk of getting an electric shock.

The machine does not contain any user-serviceable parts. Please leave all maintenance work to qualified personnel.

Setup precautions

Finding a suitable location

- Place the set on a flat, hard and stable surface. Do not place the set on a carpet.
- Do not position the set on top of other equipment that might heat it up (e.g., receiver or amplifier).
- Do not put anything above or under the set (e.g., CDs, magazines).
- Install this unit near the AC outlet and where the AC power plug can be reached easily.

Space for ventilation

- Place the apparatus in a location with adequate ventilation to prevent internal heat build up. Allow at least 10 cm (4") clearance from the rear and the top of the set and 5 cm (2") from the left and right to prevent overheating.

Avoid high temperatures, moisture, water and dust

- Apparatus shall not be exposed to dripping or splashing.
- Do not place any sources of danger on the apparatus (e.g., liquid filled objects, lighted candles).

Cleaning discs

Some problems occur because the disc inside the recorder is dirty (frozen picture, sound disruptions, picture distortions). To avoid these problems, discs should be cleaned on a regular basis.

To clean a disc, use a micro fibre cleaning cloth and wipe the disc from the centre to the edge in a straight line.

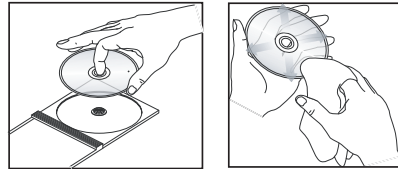

CAUTION!

Do not use solvents such as benzene, thinner, commercially available cleaners, or anti-static sprays intended for analogue discs.

Since the optical unit (laser) of the recorder operates at a higher power than regular DVD or CD players, cleaning CDs intended for DVD or CD players may damage the optical unit (laser). Therefore, refrain from using a cleaning CD.

About recycling

These operating instructions have been printed on non-polluting paper. This electronic equipment contains a large number of materials that can be recycled. If you are disposing of an old machine, please take it to a recycling centre. Please observe the local regulations regarding disposal of packaging materials, exhausted batteries, and old equipment.

Product Information

Introduction

Your Philips recorder allows you to record the TV programmes or duplicate camcorder recordings to a DVD±RW or DVD±R and play pre-recorded DVDs.

The recordings you make on the recorder will play on DVD players and DVD-ROM drives. The DVD±R discs have to be finalised before they can be played back on other DVD players.

Before you start using this recorder, complete the basic connections and set-up in three easy steps.

Step 1: Basic recorder connections

Step 2: Optional connections for other devices

Step 3: Basic installation and set-up

Please take time to read this user manual before using your recorder. It contains important information and notes regarding the operations of the recorder.

Helpful Hints:

- If you have questions or if problems come up during operation, please see the chapter 'Troubleshooting'.
- If you need further assistance, please call the customer support service for your country. The corresponding telephone numbers and email addresses are given in the guarantee booklet.
- Refer to the type plate on the rear or bottom of the product for identification and supply ratings.

Accessories supplied

- Remote control and batteries
- SCART cable
- RF coaxial cable
- Quick Start Guide

Region codes

DVD films are usually not released at the same time in all regions of the world, thus all DVD players are keyed to a specific region code.

This device will only play **Region 5** DVDs or DVDs manufactured to be played in all regions ('ALL'). DVDs from other regions cannot be played on this recorder.



Copyright notice

The making of unauthorised copies of copy-protected material, including computer programmes, files, broadcasts and sound recordings, may be an infringement of copyrights and constitute a criminal offence. This equipment should not be used for such purposes.

Remote Control

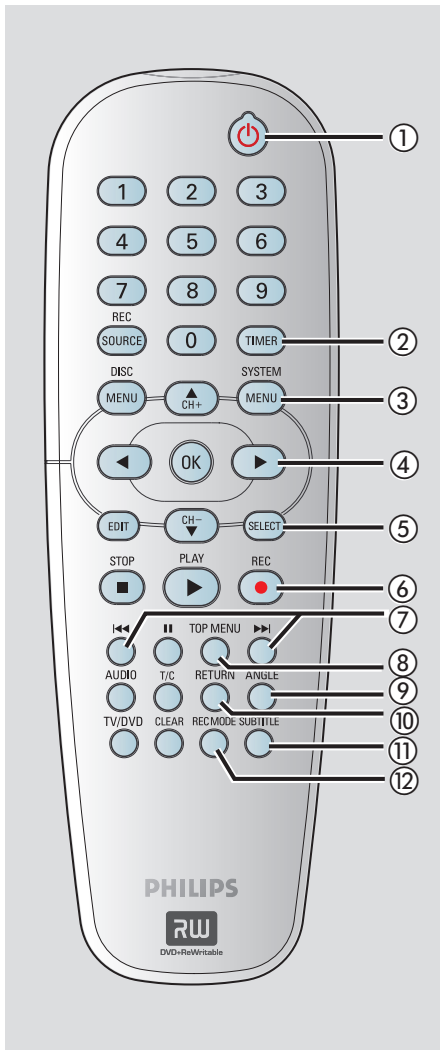

① STANDBY-ON

- Turns on the recorder or switches to standby mode.

② TIMER

- Enters/exits the timer recording menu.

③ SYSTEM-MENU

- Enters/exits the system menu.

- ④ ◀▶ : Cursor keys for moving to the left/right or making a forward/reverse search.

- ▲▼ : Cursor keys for moving up/down or changing the recorder's TV tuner channel.

⑤ SELECT

- Selects a track/chapter/file in the programme menu.

⑥ REC ●

- Starts recording the current TV channel or the current video input source.
- Press repeatedly to set up a One Touch Recording at 30, 60 or 90 minutes interval.

⑦ ◀▶▶▶

- Skips to previous or next chapter/track.
- Press and hold to make a fast forward/fast reverse search.

⑧ TOP MENU *(For DVD±R/±RWs only)*

- Enters the disc editing menu.

⑨ ANGLE

- Selects a DVD disc camera angle (if available).

⑩ RETURN

- Returns to the previous menu of a video CD (VCD) or some DVDs.

⑪ SUBTITLE

- Selects a DVD subtitle language.

⑫ REC MODE

- Toggles between recording modes : HQ, SP, EP or SLP.
This determines the quality of the recording and the amount/length of time you can record on a DVD±R/±RW.

Remote Control (continued)

English

- 13 Numeric keypad**
 - Selects a chapter/track number to play.
 - Selects the recorder's preset TV tuner channel.

- 14 REC SOURCE**
 - Selects the recorder's input source.

- 15 DISC-MENU**
 - Access DVD disc menu or Index Picture screen of a DVD±R/±RW.
 - Access VCD disc menu when PBC is turned on.

- 16 OK**
 - Stores/confirms an entry.
 - Displays/removes the status bar.

- 17 EDIT** (For DVD±R/±RWs only)
 - Enters/exits the video editing menu.

- 18 PLAY ►**
 - Plays a disc.

- 19 STOP ■**
 - Stops playback/recording.
 - Holding down the key will open and close the disc tray.

- 20 II**
 - Pauses the playback or recording.
 - Press repeatedly to advance a paused picture one frame at a time.

- 21 AUDIO**
 - Selects an audio language (DVD, VCD) or an audio channel.

- 22 T/C** (Title/Chapter)
 - Enters/exits the T/C menu.

- 23 TV/DVD**
 - Switch between playback from the additional devices (connected via EXT2 AUX I/O socket) and playback from the recorder.

- 24 CLEAR**
 - Clears a track/chapter/file in the programme menu.
 - Clears a timer entry.

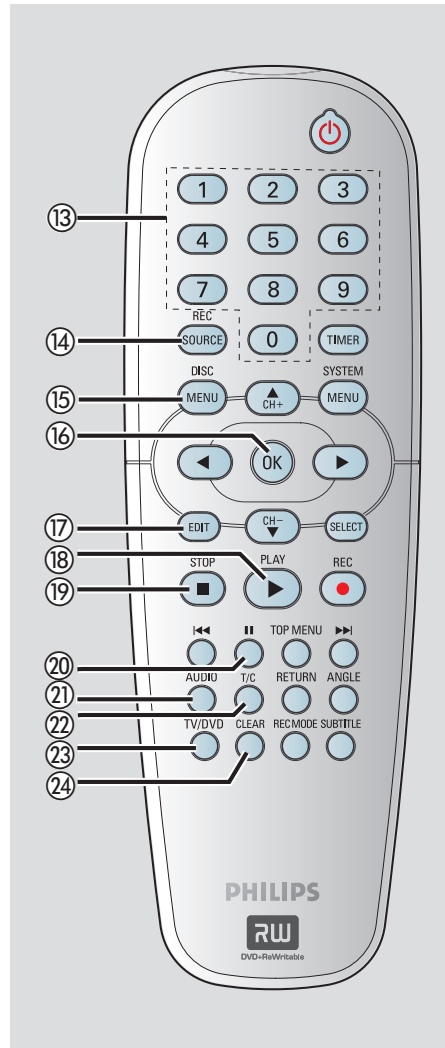

Remote Control (continued)

Using the remote control

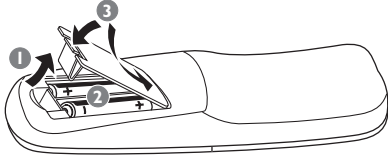

- 1 Open the battery compartment.
- 2 Insert two batteries of type R06 or AA, following the indications (+ -) inside the compartment.
- 3 Close the cover.
- 4 Aim the remote control directly at the remote sensor (IR) on the front panel.

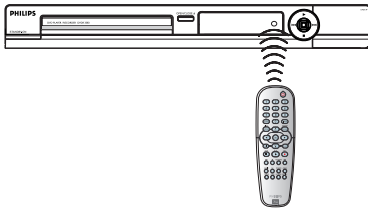

- 5 Select the source you want to control by pressing the **REC SOURCE** key on the remote control.
- 6 Select the desired function (for example **◀◀**, **▶▶**).

CAUTION!

- Remove batteries if they are exhausted or if the remote control is not to be used for a long time.
- Do not mix batteries (old and new or carbon and alkaline, etc).
- Batteries contain chemical substances, so they should be disposed of properly.

Main Unit

English

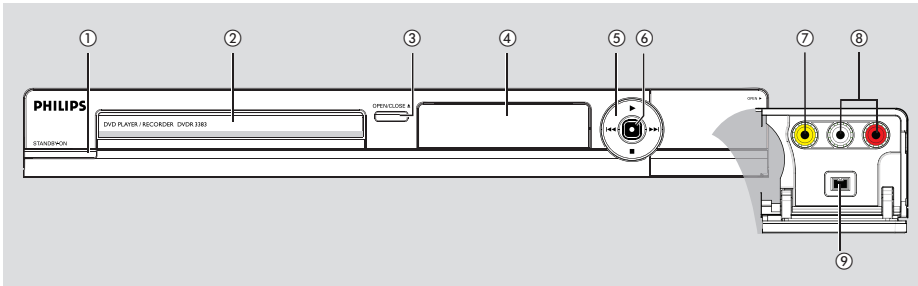

① **STANDBY-ON**

- Turns on the recorder or switch to standby mode.

② **Disc tray**

③ **OPEN/CLOSE ▲**

- Opens/closes the disc tray.

④ **System display panel**

- Shows information about the current status of the recorder.

⑤ **◀◀ (PREV) / ▶▶ (NEXT)**

- Go to the previous/next chapter or track. Press and hold to make a forward/reverse search.

▶ (PLAY)

- Plays a disc.

■ (STOP)

- Stops playback/recording.

⑥ **● (RECORD)**

- Starts recording the current TV channel or the current video input source.
- Press repeatedly to set up a One Touch Recording at 30, 60 or 90 minutes interval.

Sockets behind the flap

Flip down the door as indicated by the **OPEN ▶** label at the right hand corner.

⑦ **CAM**

- Video input for camcorders or video recorders. Press **REC SOURCE** on the remote control to select 'CAM1' in order to view the input source.

⑧ **L/R AUDIO**

- Audio input for camcorders or video recorders.

⑨ **DV IN**

- Input for digital camcorders or other suitable devices using this connector. Press **REC SOURCE** on the remote control to select 'DV' in order to view the input source.

Step I: Basic Recorder Connections

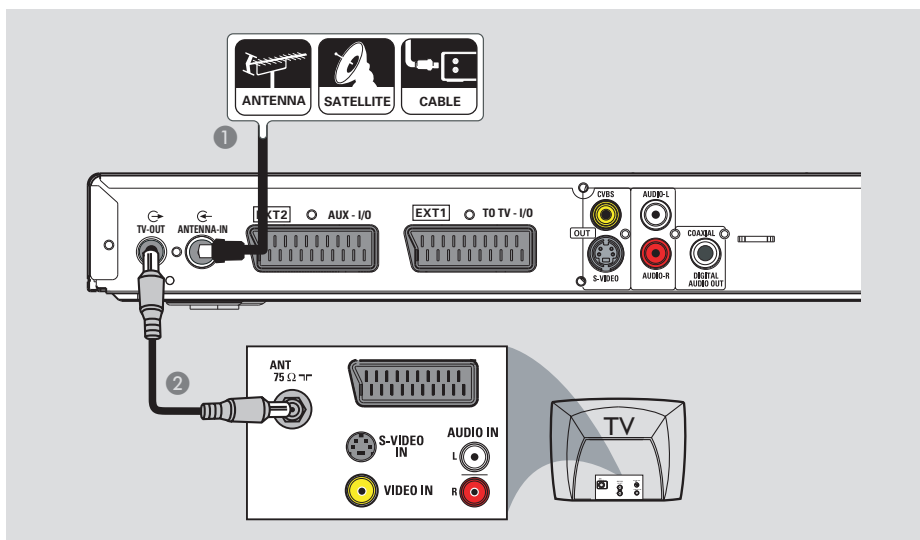

Connecting the antenna cables

These connections enable you to watch and record TV programmes using the recorder. If the antenna signal is connected via a VCR, Cable Box or Satellite Receiver, ensure that these devices are turned on in order to watch or record the cable programmes.

- **If you want to connect to a VCR and/or Cable Box/Satellite Receiver,** see the chapter “Step 2 : Optional Connections” for the complete connections to your TV.

- 1 Connect the existing Antenna/Cable TV signal (or from the Cable Box/Satellite Receiver {RF OUT or TO TV}) to the **ANTENNA-IN** socket on the recorder.
- 2 Use the supplied RF coaxial cable to connect **TV-OUT** socket on the recorder to the antenna input socket on your TV (VHF/UHF RF IN).

Helpful Hint:

– Depending on how you have currently connected your TV channel (directly from an off-air antenna or Cable box or VCR), you will have to disconnect some of the cables before you make the above connection.

TIPS: Before making or changing any connections, make sure that all the devices are disconnected from the power outlet.

Step I: Basic Recorder Connections (continued)

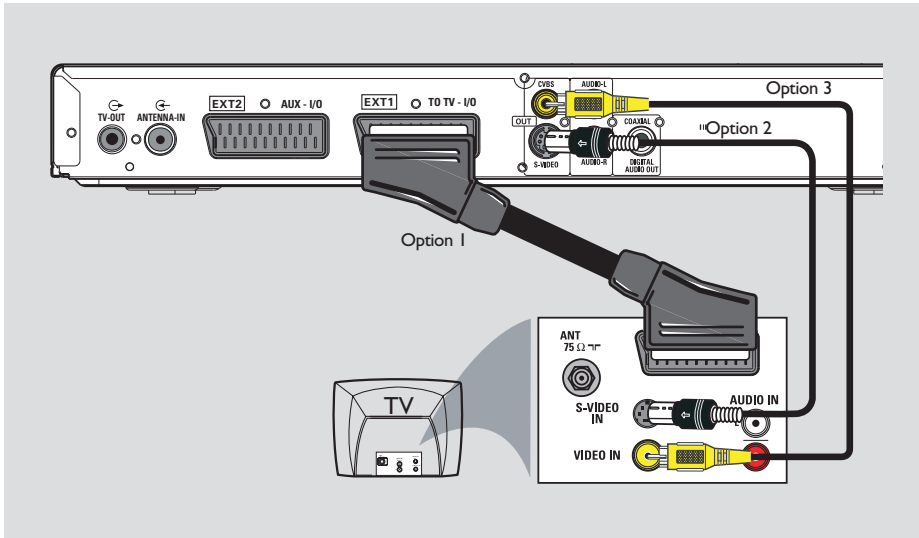

Connecting the video cable

This connection enables you to view the disc playback from the recorder. You only need to choose **one** of the options below to make your video connection.

Option 1: Using a SCART cable

- Use the SCART cable to connect the **EXT1 TO TV-I/O** socket on the recorder to the corresponding SCART input socket on the TV set.

Helpful Hints:

- If your TV set has several SCART sockets, select the SCART socket that is suitable for both video output and video input.
- If your TV set displays a selection for the SCART socket, select 'VCR' as the source for the SCART socket.
- The EXT2 AUX-I/O socket is intended only for additional devices.

Option 2: Using an S-Video cable

- Use an S-video cable (not supplied) to connect the **S-VIDEO OUT** socket on the recorder to the S-Video input socket (or labelled as Y/C or S-VHS) on the TV set.
→ Audio connection is required in order to hear the sound, see the next section "Connecting the audio cables".

Option 3: Using a Video (CVBS) cable

- Use a composite video cable (yellow - not supplied) to connect the **CVBS OUT** socket on the recorder to the video input socket (or labelled as A/V In, Video In, Composite or Baseband) on the TV set.
→ Audio connection is required in order to hear the sound, see the next section "Connecting the audio cables".

TIPS: Before making or changing any connections, make sure that all the devices are disconnected from the power outlet.

Step I: Basic Recorder Connections (continued)

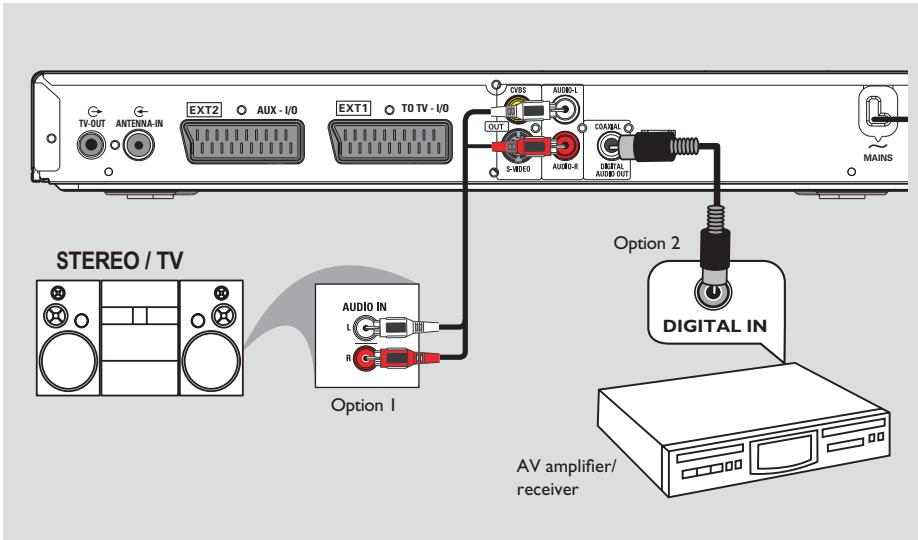

Connecting the audio cables

This connection enables you to listen to the sound. This connection is not required if the recorder is connected to the TV using the SCART cable.

Option 1: Using an audio cable

You can connect the recorder to a two channel stereo system or receiver in order to enjoy the stereo sound system.

- Use an audio cable (red/white ends) to connect the **AUDIO-L-R** sockets to one of the following devices with the same input sockets.
 - a stereo system (for example, TV or mini system).
 - a receiver with two channel analogue stereo.

Option 2: Using a coaxial cable

You can connect the recorder to an AV amplifier/receiver with a digital multichannel sound decoder in order to enjoy multichannel surround sound.

- Use a coaxial cable (not supplied). Connect the **COAXIAL (DIGITAL AUDIO OUT)** socket on the recorder to the digital input of the receiver/ amplifier.

Before you start operating, set the digital audio output settings accordingly (see the chapter “DVD System Menu Options - PLAYBACK settings). If the audio setting does not match your stereo’s capabilities, the stereo may produce a strong, distorted sound or no sound at all.

TIPS: Before making or changing any connections, make sure that all the devices are disconnected from the power outlet.

Step 2: Optional Connections

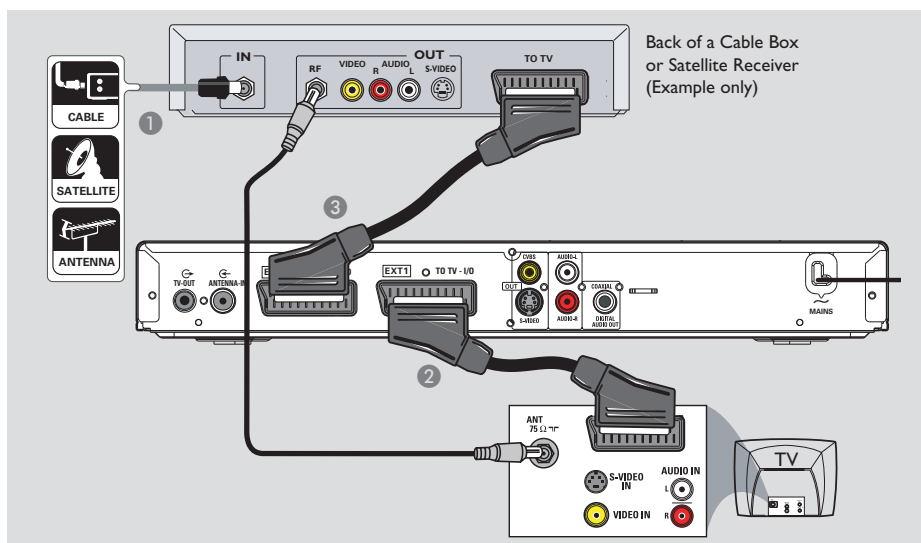

English

Connecting to a Cable Box or Satellite Receiver

Option 1

If your Cable Box/Satellite Receiver has only an antenna output socket (RF OUT or TO TV),

see the section “Step 1: Basic Recorder Connections – Connecting the antenna cables” for the complete connections to your TV.

Option 2 (see the above illustration)

If your Cable Box/Satellite Receiver has a SCART output socket

- 1 Keep the existing antenna connection from the Cable Box/Satellite Receiver to your TV.
- 2 Use the SCART cable to connect the **EXT1 TO TV-I/O** socket on the recorder to the corresponding SCART input socket on the TV.
- 3 Use another SCART cable to connect the **EXT2 AUX-I/O** socket on the recorder to the SCART output socket (or labelled as TV OUT or TO TV) on the Cable Box/Satellite Receiver.

To start playback, select the TV channel directly on the Cable Box/Satellite Receiver. To view the picture from a connected external device, press the **TV/DVD** key on the remote control.

TIPS: Before making or changing any connections, make sure that all the devices are disconnected from the power outlet.

Step 2: Optional Connections (continued)

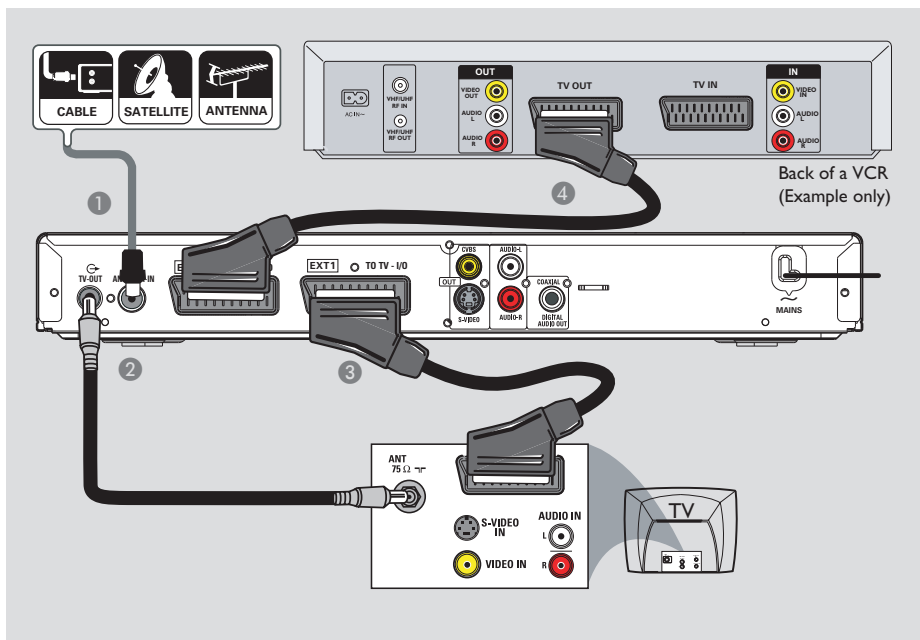

Connecting to a VCR or other similar device

This connection enables you to record from video tape to a DVD±R/±RW and allows the VCR to be used for playback if the recorder is turned off.

IMPORTANT!

Your new recorder can replace the VCR for all your recording needs. Just unplug all the connections to your VCR.

- 1 Connect the existing Antenna/Satellite/Cable TV signal (or from the Cable Box/Satellite Receiver, labelled as RF OUT or TO TV) to the **ANTENNA-IN** socket on the recorder.

- 2 Use the supplied RF coaxial cable to connect the **TV-OUT** socket on the recorder to the aerial input socket (or labelled as VHF/UHF RF IN) on your TV.

- 3 Use the SCART cable to connect the **EXT1 TO TV-I/O** socket on the recorder to the corresponding SCART input socket on the TV.

- 4 Use another SCART cable to connect the **EXT2 AUX-I/O** socket on the recorder to the SCART output socket (or labelled as TV OUT or TO TV) on the VCR.

Helpful Hints:

- Most commercial video cassettes and DVDs are copy-protected and therefore cannot be recorded.
- Connect the recorder directly to the TV. If there is a VCR or an additional device in between, the picture quality may be poor because of the copy protection system built into this recorder.

TIPS: Before making or changing any connections, make sure that all the devices are disconnected from the power outlet.

Step 2: Optional Connections (continued)

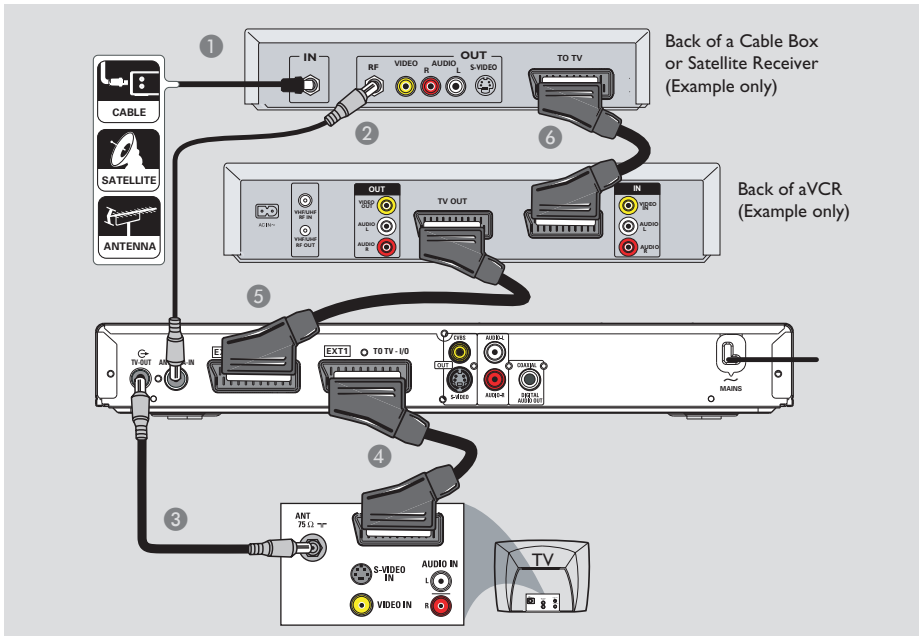

Connecting to a VCR and Cable Box/Satellite Receiver

- 1 Connect the Antenna/Cable TV signal to the antenna input (RF IN) socket on the Cable Box/Satellite Receiver.
- 2 Use the supplied RF coaxial cable to connect the antenna output (RF OUT) socket on the Cable Box/Satellite Receiver to the **ANTENNA-IN** socket on the recorder.
- 3 Use another RF coaxial cable to connect the **TV-OUT** socket on the recorder to the antenna input socket on the TV.
- 4 Use the SCART cable to connect the **EXT1 TO TV-I/O** socket on the recorder to the corresponding SCART input socket on the TV.
- 5 Use another SCART cable to connect the **EXT2 AUX-I/O** socket on the recorder to the SCART output socket (or labelled as TV OUT or TO TV) on the VCR.
- 6 Use another SCART cable to connect the SCART input (TV IN) socket on the VCR to the SCART output socket (or labelled as TV OUT or TO TV) on the Cable Box/Satellite Receiver.

TIPS: Before making or changing any connections, make sure that all the devices are disconnected from the power outlet.

Step 2: Optional Connections (continued)

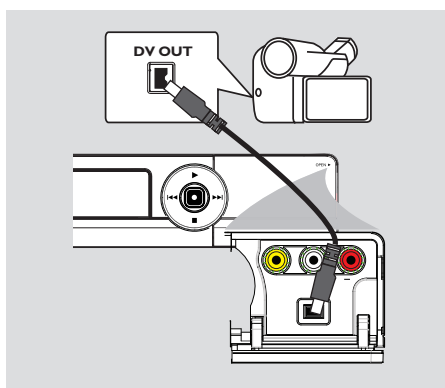

Connecting a camcorder to the front sockets

You can use the front sockets to copy camcorder recordings. These sockets are located behind the flap on the right and provides convenient connections for a camcorder.

Option 1: Using the DV IN socket

Use this connection if you have a Digital Video or Digital 8 camcorder. The DV socket conforms to the i.LINK standard.

- Use an i.LINK 4-pin cable (not supplied) to connect the **DV IN** socket on the recorder to the appropriate DV OUT socket on the camcorder.

Before you start operating, press **REC SOURCE** on the remote control repeatedly to select 'DV' as the input channel. See the chapter "Recording" for details.

Helpful Hints:

- The DV IN socket does not support a connection to a Personal Computer.
- It is not possible to record from the recorder to your camcorder via the DV IN socket on your recorder.

TIPS: Before making or changing any connections, make sure that all the devices are disconnected from the power outlet.

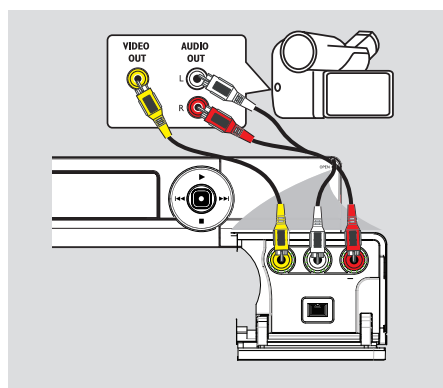

Option 2: Using the VIDEO In socket

Use the CAM (VIDEO) connection if your camcorder has only a single video output (Composite Video, CVBS).

- 1 Connect the **CAM** socket on the front panel of the recorder to the corresponding S-VHS or Video output socket on the camcorder.
- 2 Use an audio cable (red/white ends) to connect the **AUDIO L/R** sockets on the front panel of the recorder to the audio output sockets on the camcorder.

Before you start operating, press **REC SOURCE** on the remote control repeatedly to select 'CAM1' as the input channel, depending on your connections. See the chapter "Recording" for details.

Step 3: Installation and Setup

Before you start...

When you complete the connections and switch on the recorder for the first time, it is advisable that you make several basic settings.

Please see the following pages on using the system menu features to programme TV channels, menu language and system clock settings. This will optimise the performance of this recorder.

Finding the correct viewing channel

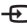
- 1 Press **STANDBY-ON** on the recorder to switch it on.
- 2 Switch on the TV set and set it to the correct video-in channel. You should see the blue DVD background screen.
 - You may go to Channel 1 on your TV, then press the Channel Down button on your TV's remote control until you see the Video In channel.
 - You may press  button repeatedly on your TV's remote control.
 - Usually this channel is between the lowest and highest channels and may be called FRONT, A/V IN, VIDEO. See your TV manual for more details.



Setting the OSD language

Select the menu language for this recorder's on-screen display. The language options are different depending on your country or region. It may not correspond to the illustrations shown in the user manual.

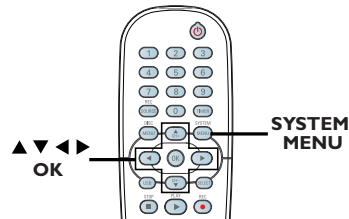

The menu language (on-screen display) for the system will remain as you set it.

Language settings can only be changed when there is no disc in the disc tray.

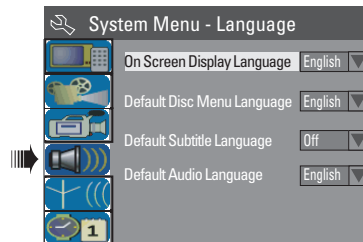

- 1 Press **SYSTEM-MENU**.
 - The system menu appears.
- 2 Use  keys to highlight  { **System Menu - Language** } and press  to access the menu.



- 3 Use  keys to highlight { **On Screen Display Language** } and press **OK** to access its options.
- 4 Use  keys to highlight the desired language and press **OK** to confirm.

TIPS: Press  to go access the options of an item in the menu.
Press **SYSTEM-MENU** to exit the menu.

Step 3: Installation and Setup (continued)

Select the country of your residence

Select the country of your area for auto channel tuning.

- 1 Press **SYSTEM-MENU** on the remote control.
→ The system menu appears on the TV.
- 2 Use ▲▼ keys to highlight  { **System Menu - General** } and press ►.

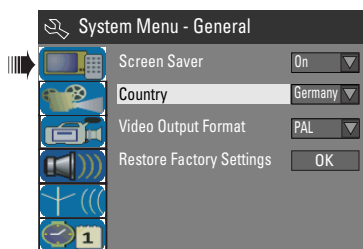

- 3 Use ▲▼ keys to highlight { **Country** } and press **OK**.
- 4 Use ▲▼ keys to select the country of your residence and press **OK** to confirm.

Setting your TV channel programmes

Before the recorder can start recording the TV channel programmes, you need to search for the available TV channels and store them in the recorder.

Note: Make sure you have successfully made all the required connections to the recorder, the TV and Satellite Receiver/ Cable Box (if any) and switched them on.

Tuner settings can only be changed when there is no disc in the disc tray.

- 1 Press **SYSTEM-MENU** on the remote control.
→ The system menu appears on the TV.
- 2 Use ▲▼ keys to highlight  { **System Menu - Channel Setup** } and press ►.

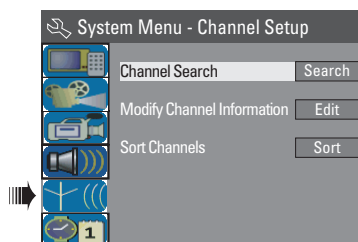

- 3 Use ▲▼ keys to highlight { **Channel Search** } and press **OK**.
→ The automatic TV channel search starts. This process may take several minutes. Once complete, the total number of channels found appears on the TV.

To modify or sort the TV channels, see the chapter “DVD System Menu Options – CHANNEL SETUP settings.”

TIPS: Press ► to go access the options of an item in the menu.
Press **SYSTEM-MENU** to exit the menu.

Step 3: Installation and Setup (continued)

Setting the date & time

If the recorder has not set the time and date correctly, set the clock manually by following the steps below.

- 1 Press **SYSTEM-MENU**.
→ The system menu appears.
- 2 Use ▲▼ keys to select  { **System Menu - Clock** } and press ► to confirm.

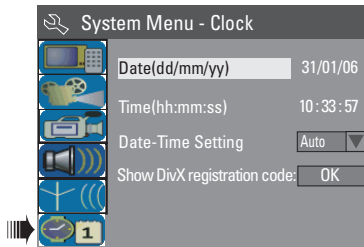

- 3 Use ▲▼ keys to highlight { **Date (dd/mm/yy)** } and press **OK**.
- 4 Use ▲▼ keys to change the numbers and use ◀▶ keys to select different entry fields. Press **OK** to confirm.
- Alternatively, you can key in the numbers using the **numeric keypad 0-9** on the remote control.
- 5 To confirm all changes, press **OK**.
- 6 Move to { **Time (hh:mm:ss)** } and repeat step 4~5.

TIPS: Press ► to go access the options of an item in the menu.
Press **SYSTEM-MENU** to exit the menu.

Recording

Discs for recording

Several different formats of DVD recordable discs can be used with this recorder:



DVD±RW (DVD Rewritable)

– Discs that are rewritable can be used for multiple recordings once the existing data has been erased.



DVD±R (DVD Recordable)

– Discs can only be used for a single recording. Each new recording is always added at the end of all previous recordings as existing recordings cannot be overwritten.

– Editing can be made on any DVD±R discs as long as they have not been finalised. It is also possible to create additional chapter markers.

– To play a DVD±R on other DVD player, it must be finalised (See the chapter “Editing/ Finalising Recording – Playing your recordings (DVD±R) on other DVD players”). After this is done, no more data can be added to the disc.

Supported disc types and media speeds

Disc	Media speeds
DVD+R	1x - 16x
DVD+RW	2.4 x - 4x
DVD-R	1x - 16x
DVD-RW	2x - 4x

IMPORTANT!

Unrecordable pictures

Television programmes, films, video tapes, discs, and other materials may be copy-protected and therefore cannot be recorded on this recorder.

Recording settings

The default recording settings allow you to set the auto chapter markers, preferred recording input source and recording mode. Any changes made using the remote control will only apply to the current recording settings. The default recording settings will remain unchanged for the next recording.

- 1 Press **SYSTEM-MENU** on the remote control.
→ The system menu appears on the TV.
- 2 Use ▲▼ keys to select  { **System Menu - Record** } and press ► to confirm.

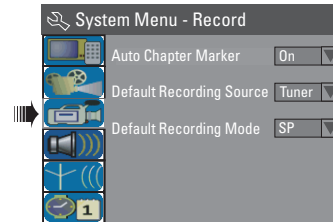

- 3 Use ▲▼ keys to select the setting you wish to change and press **OK** to confirm.
→ Instructions and explanation of the options are provided in the following pages.
- 4 To exit, press **SYSTEM-MENU**.

TIPS: Press ◀ to go back to previous menu item. Press **SYSTEM MENU** to exit the menu item.

RECORD settings (underlined options are the factory default settings)

Auto Chapter Marker

Automatically insert chapter markers within a title during recording. This helps you to access specific points on the recorded disc as you would choose a chapter on other DVDs.

This allows you access to specific points on the recording.

1) Use **▲▼** keys to select one of the options:

- { Off } – Disable this feature.
- { On } – Chapter markers will automatically be inserted within the title during recording at every 5 minutes interval.

2) Press **OK** to confirm your selection.

Default Recording Source

Define your preferred source of recording.

1) Use **▲▼** keys to select one of the options:

- { Tuner } – Input source from TV programmes.
- { CAMI } – Input source from the device connected to the CAM and AUDIO L/R sockets on the front panel.
- { DV } – Input source from the device connected to DV IN socket on the front panel.
- { EXT 1 } – Input source from the device connected to the EXT1 TO TV-I/O SCART socket on the back panel.
- { EXT 2 } – Input source from the device connected to the EXT2 AUX-I/O SCART socket on the back panel.

2) Press **OK** to confirm your selection.

Default Recording Mode

Define your preferred mode of recording.

This function can also be accessed via the **REC MODE** on the remote control.

1) Use **▲▼** keys to select one of the options:

Record Mode	Picture Quality	Maximum Recording Time per Disc
HQ	High quality	1 hour
SP	DVD quality-Standard Play	2 hours
EP	VHS quality-Extended Play	4 hours
SLP	VHS quality-Super Long Play	6 hours

2) Press **OK** to confirm your selection.

Recording (continued)

Manual recording

Use this feature to start recording immediately (e.g., to record a TV show already in progress).

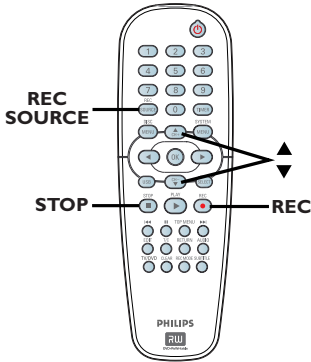

- 1 Switch on the TV set. Select the correct Video In channel on the TV.
- 2 Insert a DVD±R/±RW into the recorder.
- 3 Press **REC SOURCE** on the remote control to select { **Tuner** }, then use ▲▼ keys to select the TV channel you wish to record.
- **To record from an external device**, press **REC SOURCE** repeatedly to select the correct input channel that matches the socket which is connected to the recorder.

{ CAMI }

Input source from the device connected to the CAM and AUDIO L/R sockets on the front panel.

{ DV }

Input source from the device connected to DV IN socket on the front panel.

{ EXT 1 }

Input source from the device connected to the EXT1 TO TV-I/O SCART socket on the back panel.

{ EXT 2 }

Input source from the device connected to the EXT2 AUX-I/O SCART socket on the back panel.

- 4 Press **REC ●** to start recording.
→ The recording will automatically start after the last recording on the DVD±R/±RW.
- 5 To stop the recording, press **STOP ■**.

Pausing a recording

- 1 During a recording, press **PAUSE II**.
→ You can use this function to avoid recording commercials.
- 2 To resume recording, press **REC ●**.

One Touch Recording - automatic turn-off

- 1 Follow the steps 1~3 of "Manual Recording" in the previous section.
- 2 Press **REC ●** repeatedly to toggle between OTR 30, 60 or 90- minutes recording options.
→ The recorder will stop recording at the designated end time and switch off automatically.
- To interrupt the recording, press **STOP ■**.

TIPS: Press ◀ to go back to previous menu item.
Press **SYSTEM MENU** to exit the menu item.

Recording (continued)

About timer recording

Use 'Timer Recording' to automatically start and stop a recording at a later date/time. The recorder will tune to the right programme channel and start recording at the specified time.

With this recorder, you can pre-programme up to **8 recordings**.

To make a timer recording, your recorder needs to know:

- The date you want to make the recording.
- The recording input source.
- The start and stop time of the recording.
- The recording mode, see the section "RECORD settings – Default Recording Mode" in this chapter.

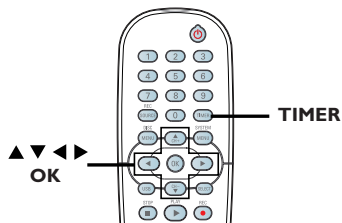

About 'PDC'

'PDC' (Programme Delivery Control) is used to control the start and end time of TV channel recordings. If a TV programme starts earlier or ends later than was scheduled, the recorder will then switch on and off at the correct time.

PDC is intended to record the entire programme. To set a timer that is longer/shorter than the PDC broadcast time, you must turn off the PDC.

Timer recording (manually)

- 1 Switch on the TV set. Select the correct Video In channel at the TV.
- 2 Press **TIMER** on the remote control.
→ The timer schedule appears.

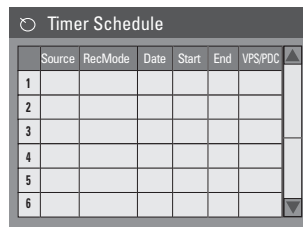

- 3 Press **OK** on the remote control.
→ The SHOWVIEW® System menu appears.

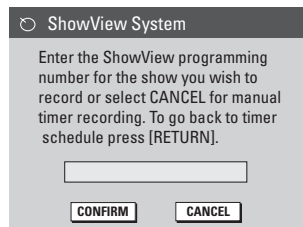

- 4 Select **CANCEL** in the menu and press **OK**.
→ The timer editor menu appears.

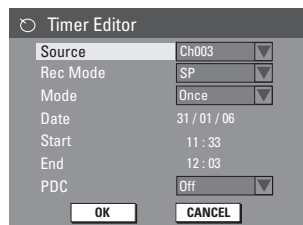

TIPS: Ensure that there is enough space on the DVD±R/±RW before recording. Before you playback the DVD±R on another player, finalise the disc. See "Playing your recordings (DVD±R) on other DVD players".

Recording (continued)

- 5 Use **▲▼** keys to select an entry in the menu and press **▶** to enter its options.
 - { **Source** }
 - Use **▲▼** keys to select the recording input source.
 - { **Rec Mode** }
 - Use **▲▼** keys to select your option. See the chapter “Recording – RECORD settings - Default Recording mode”.
 - { **Mode** }
 - Use **▲▼** keys to select { **Once** }, { **Daily** }, { **Weekly** }, { **Mon-Fri** } (Monday to Friday,) { **Mon-Sat** } (Monday to Saturday) or { **Weekend** } (Saturday and Sunday) recordings.
 - { **Date** }
 - Use **▲▼** keys or the **numeric keypad 0-9** to enter the date for recording.
 - { **Start** }
 - Use **▲▼** keys or the **numeric keypad 0-9** to enter the start time of recording.
 - { **End** }
 - Use **▲▼** keys or the **numeric keypad 0-9** to enter the end time of recording.
 - { **PDC** }
 - Use **▲▼** keys to turn on/off the PDC mode (See the previous page “About PDC”).
- 6 Select **OK** in the menu and press **OK**.
 - The system will store the timer entry and return to the timer schedule list.
- To cancel the above timer setting, select **CANCEL** in the menu and press **OK**.
- 7 Press **TIMER** to exit the menu.
- 8 Insert a DVD±R/±RW into the DVD recorder.

- 9 Press **STANDBY-ON** to switch the recorder to standby mode.
 - If the DVD recorder is not in standby mode, a warning message will appear three minutes before the recording starts.
 - The ‘**TIMER**’ icon will light up on the display panel if a timer recording is set.

Helpful Hint:

- Set the timer recording one minute ahead of the programme’s start time. This helps ensure the entire programme is recorded as the disc requires about 30 seconds to prepare for recording.

Setting a timer recording from an external Cable Box/ Satellite Receiver

If you have a Satellite Receiver/Cable Box connected to this recorder via the EXT2 AUX-I/O scart connection (see “Step 2: Optional Connections”), follow the steps described below to programme the recordings.

- 1 Select the channel you want to record at the Satellite Receiver/Cable Box.
- 2 Programme the recording with the required information. Follow the steps 1~4 of “Timer Recording (manually)” on the previous page.
 - { **Source** }
 - Use **▲▼** keys to select { **EXT2** } as the input channel and press **OK** to confirm.
- 3 Leave the Satellite Receiver/Cable Box switched on for the recording.

TIPS: Ensure that there is enough space on the DVD±R/±RW before recording. Before you playback the DVD±R on another player, finalise the disc. See “Playing your recordings (DVD±R) on other DVD players”.

Recording (continued)

Timer recording (SHOWVIEW® System)

This is a simple programming system for recorders. To use it, enter the SHOWVIEW® programming number associated with your television programme. You can find this number in your TV listings magazine.

All the information needed by the recorder for programming is contained in the programming number.

- 1 Switch on the TV set. Select the correct Video In channel on the TV.
- 2 Press **TIMER** on the remote control.
→ The timer schedule appears.

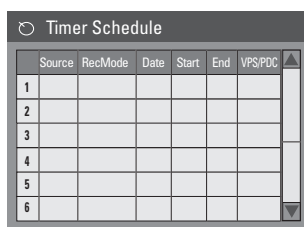

- 3 Press **OK** to confirm.
Alternatively, press **▼** key to go to the next available empty slot and press **OK**.
→ The SHOWVIEW® System menu appears.

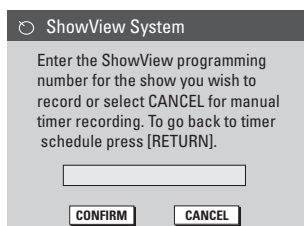

- 4 Use the **numeric keypad 0-9** to enter the SHOWVIEW® programming number for the show you wish to record.
(e.g. : 5-312-4 or 5,312 4, key in '53124').

- To clear the SHOWVIEW® programming number, press **CLEAR** on the remote control.
- To cancel the SHOWVIEW® programming, use **▲▼** keys to select **CANCEL** in the menu and press **OK**.
- 5 To confirm your entry, select **CONFIRM** in the menu and press **OK**.
→ The system will store the timer entry and return to the timer editor menu.
- If the channel number of the TV channel has not been assigned to the programming number, you will have to manually key in the channel number that is assigned to the SHOWVIEW® code. Follow the instructions on the TV.
- 6 Press **TIMER** to exit the menu.
- 7 Insert a DVD±R/±RW into the recorder.
- 8 Press **STANDBY-ON** to switch the recorder to standby mode.
→ If the recorder is not in standby mode, a warning message will appear three minutes before the recording starts.
→ The **'TIMER'** icon will light up on the display panel if a timer recording is set.

TIPS: Ensure that there is enough space on the DVD±R/±RW before recording. Before you playback the DVD±R on another player, finalise the disc. See "Playing your recordings (DVD±R) on other DVD players".

Recording (continued)

Changing/ Deleting a timer recording

- 1 Switch on the TV set. Select the correct Video In channel at the TV.
- 2 Press **TIMER** on the remote control.
→ The timer schedule appears.

Timer Schedule						
	Source	RecMode	Date	Start	End	VPS/PDC
1	CH003	SP	14/01/06	11.00	12.30	On
2	CH010	HQ	25/01/06	02.00	06.30	Off
3	CH008	SP	30/01/06	10.00	11.15	On
4	CH005	EP	31/01/06	08.30	09.00	Off
5						
6						

- 3 Use **▲▼** keys to select a timer programme which you want to change/delete.
- 4 **To delete a timer**, press **CLEAR** on the remote control.
- 5 **To change the timer schedule**, press **OK** to enter the timer editor menu of the selected timer programme.

Timer Editor	
Source	Ch003
Rec Mode	SP
Mode	Once
Date	31 / 01 / 06
Start	11 : 33
End	12 : 03
PDC	Off
<input type="button" value="OK"/> <input type="button" value="CANCEL"/>	

- 6 Select the entry field and make the necessary changes.
- 7 Once complete, select in the menu and press **OK** to save the changes.
- 8 Press **TIMER** to exit the menu.

Simultaneous recording and playback

While recording is in progress, you can watch another TV channel or playback from another audio/video device connected to this recorder.

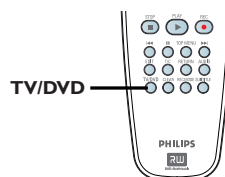

Watching playback from another device

This is only possible if the recorder is connected to the TV using the EXT1 TO TV-I/O socket.

- Press **TV/DVD** to view the picture from the device which is connected to the EXT2 AUX-I/O socket of this DVD recorder.

Watching another TV channel

If there is no device connected to the EXT2 AUX-I/O socket, pressing **TV/DVD** will switch to TV mode.

- Use the TV's remote control to change the channels.
→ The message "TV/LOOP" will be displayed on the recorder's system display panel.
- To return to viewing playback from the recorder, press **TV/DVD** on the remote control

Helpful Hint:

– Remember to turn the TV back to its video input channel if you want to watch the TV channel through the recorder or playback the recorded disc.

TIPS: Ensure that there is enough space on the DVD±R/±RW before recording. Before you playback the DVD±R on another player, finalise the disc. See "Playing your recordings (DVD±R) on other DVD players".

Playable discs

Using this recorder, you can play and record on the following discs:

Recording and Playback

DVD±RW (DVD Rewritable); can be recorded on over and over again.



DVD±R (DVD Recordable); can be recorded only once.



Playback only:

DVD Video (Digital Versatile Disc)



CD-RW (CD-Rewritable) Audio/ MP3/ JPEG contents



CD-R (CD-Recordable) Audio/ MP3/ JPEG contents



Audio CD (Compact Disc Digital Audio)



MP3-Disc



Video CD (Formats 1.0, 1.1, 2.0)



Super Video CD



DivX® Disc (DivX® 3.11, 4.x, 5.x, 6)



IMPORTANT!

– If the inhibit icon (Error) appears on the TV screen when a key is pressed, it means the function is not available on the current disc or at the current time.

– DVD discs and players are designed with regional restrictions. Before playing a disc, make sure the disc is for the same region as your player.

– Do not push on the disc tray or place any objects other than discs on the disc tray. It may cause the disc player to malfunction.

Inserting a disc

- 1 Press **STANDBY-ON** to switch on the recorder.
- 2 Press **OPEN/CLOSE ▲** on the front of the recorder.
→ The disc tray opens.
- 3 Carefully place the disc into the tray with the label facing up, then press **OPEN/CLOSE ▲**.
→ Make sure the disc label is facing up. For double-sided discs, load the side as indicated on the label.
- 4 Switch on the TV set. Select the correct Video In channel at the TV (See the chapter “Step 3: Installation and Setup – Finding the correct viewing channel”).
- 5 Playback will start automatically or a dialogue will appear on the TV (see next page).

TIPS: Some discs cannot be played on this recorder due to the configuration and characteristics of the disc, or due to the condition of recording and authoring software.

Playback (continued)

Starting disc playback

- Playback will begin automatically. If the disc has its own menu this will be loaded, otherwise the recorder will launch an index screen.
- If the pin code entry dialogue appears on the TV, this means that the parental control was activated for the inserted disc (See the chapter “DVD System Menu Options – PLAYBACK settings”).
→ Use the **numeric keypad 0-9** on the remote control to enter your pin code (password).
- For more playback features, see the chapter “Additional Playback Features”.

Playing a DVD video disc

- 1 Insert a DVD disc.

If the disc menu appears on the TV

- Use **numeric keypad 0-9** to input your selection or use ◀▶▲▼ keys to select a play option and press **OK** to start playback.

To select the previous or next chapter/title marker

- During playback, press ◀◀/▶▶ to go to the previous/next chapter/track.
- 2 To stop playback, press **STOP ■**.

Playing a (Super) Video CD

(Super) Video CDs may feature the ‘PBC’ (Play Back Control). This allows you to play the video CDs interactively by following the menu on the display.

- 1 Insert a (Super) Video CD.

If the ‘PBC’ is on, the disc index menu will appear on the TV

- 2 Use **numeric keypad 0-9** to input your selection or to select a play option.
- Press **RETURN** on the remote control to return to the previous menu.
- To turn on/off the Playback Control mode, press **T/C** on the remote control during playback to access the T/C menu. Then use ▲▼ keys to select { **PBC On** } or { **PBC Off** }.
- 3 To stop playback, press **STOP ■**.

Playing an audio CD

- 1 Insert an audio CD.
→ Playback starts automatically.
→ The track number and elapsed playing time appear on the display panel.
- 2 To stop playback, press **STOP ■**.

TIPS: Some discs cannot be played on this recorder due to the configuration and characteristics of the disc, or due to the condition of recording and authoring software.

Playback (continued)

Playing a DVD±R/±RW disc

- 1 Insert a DVD±R/±RW disc.
→ The Index Picture screen appears.
- 2 Use ▲▼ keys to select a title and press **PLAY ▶** to start playback.
- 3 To stop playback, press **STOP ■**.

Helpful Hint:

– If the message ‘BLANK’ appears on the display panel, this means that there are no recordings on this disc..

Playing an MP3 disc

- 1 Insert an MP3 CD.
→ The disc content menu appears.

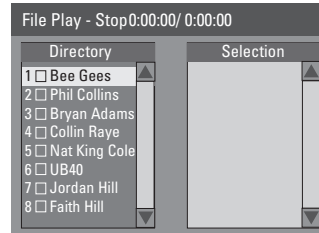

Note: It may require a longer time for the recorder to display the disc content menu on the TV due to the large number of songs/pictures compiled into one disc.

- 2 Use ▲▼ keys to navigate within the menu and press **OK** to access the folder/album.
- 3 Use ▲▼ keys to select the track/file to playback.
- To move up to the previous level, press **RETURN**.
- 4 To create a playlist, highlight the track/file and press **SELECT**.
→ The selected tracks/files will appear on the right screen.
→ Use ◀▶ keys to toggle between the left and right screen.
→ To remove the track/file from the selected playlist, press **CLEAR**.
- 5 To start playback, move the cursor to the right selection screen, press **PLAY ▶**.
- 6 During playback, you can press **I◀◀ / ▶▶** to select the next/previous track.
- 7 To stop playback, press **STOP ■**.

Helpful Hint:

– Only the first session of a multi-session CD will playback.

TIPS: Some discs cannot be played on this recorder due to the configuration and characteristics of the disc, or due to the condition of recording and authoring software.

Playback (continued)

Playing a picture disc (or musical slide show)

You can display JPEG pictures in the selected list automatically one after the other.

- 1 Insert a JPEG picture disc (CD, CD-R/RW, DVD±R/±RW).
→ The disc content menu appears.
- 2 Use ▲▼ keys to navigate within the menu and press **OK** to access the folder/album.
- 3 To create a playlist, highlight the track/file and press **SELECT**.
→ The selected tracks/files will appear on the right screen.
→ To remove the track/file from the playlist, press **CLEAR**.
→ You can select to playback from the original disc content or from the playlist. Use ◀▶ keys to move to the correct screen before selecting the track/file for playback.

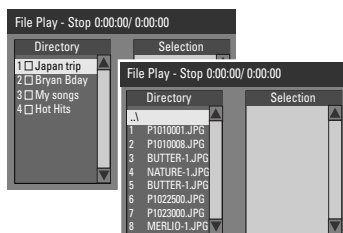

If the disc contains MP3 music and JPEG picture files, you can start a musical slide show playback,

- Select an MP3 file and press **OK** to start playback, then select a picture file in the menu and press **OK** to start the musical slide show playback.

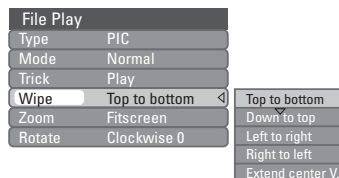

- 5 During playback, press **T/C** once to show the disc content menu. Press **T/C** again to access various settings for the slide show playback.
→ The selected animation settings will appear in the top left corner of the TV screen.
- 6 To stop playback, press **STOP** ■.

Playable JPEG picture disc

This recorder can read JPEG pictures stored on a CD-ROM, Picture CD, or DVD.

File format:

- The file extension has to be '.JPG,' '.JPE' or '.JPEG.'
- Only DCF-standard still pictures or JPEG pictures (eg. TIFF) can be displayed.
- It cannot playback moving pictures, Motion JPEG, pictures in non-JPEG formats or pictures associated with sound.
- The recorder may require a longer time to display the disc content on the TV due to the large number of songs/pictures compiled onto one disc.

TIPS: Some discs cannot be played on this recorder due to the configuration and characteristics of the disc, or due to the condition of recording and authoring software.

Playing a DivX® disc

This DVD system supports the playback of DivX® movies which you have copied from your computer onto a CD-R/RW, DVD±R/±RW.

- 1 Insert a DivX® disc.
→ The disc content menu appears.
- If the DivX® movie contains external subtitles, you have to first select the subtitle file from the file list.
- 2 Press **PLAY** ► to start playback.
- During playback, you can press **DISC MENU** to display the disc content menu.

To select another character set for the subtitle file,

- During playback, press **T/C** once to show the disc content menu. Press **T/C** again to access various settings for the slide show playback.

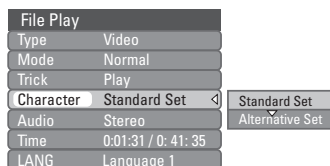

- Use ▲▼ keys to select { **Character** } and press ► to access the options. Select the preferred subtitle set and press **OK** to confirm.

Helpful Hints:

- Subtitle files with the following filename extensions (.srt, .smi, .sub, .sami) are supported.
- It is normal to experience an occasional pixelation during DivX® playback due to poor clarity of digital contents during internet downloading

TIPS: Some discs cannot be played on this recorder due to the configuration and characteristics of the disc, or due to the condition of recording and authoring software.

Additional Playback Features

Changing to another chapter/track

When a disc contains more than one chapter or track, you can change to a different chapter or track as follows.

During playback,

- Press **▶▶** to go to the next chapter/track.
- Press **◀◀** to return to the start of the previous chapter/track.
OR
- Use the **numeric keypad 0-9** to input the title/chapter/track number.
OR
- Press **T/C** to enter the T/C menu and use **▲▼** keys to select { **Title** } or { **Chapter** } and use **numeric keypad 0-9** to input the title/chapter/track number.

Pausing playback and step play

- 1 During playback, press **PAUSE ||** to pause playback and display a still picture.
- 2 Press **PAUSE ||** again to move one frame forward.
- 3 To resume normal playback, press **PLAY ▶**.

Searching forwards/backwards

You can search forward or backward on a disc at two, four, sixteen or thirty two times the normal playback speed.

- 1 During playback, press **◀** (reverse) or **▶** (forward) to switch to the search function.
→ The search status bar appears.
It displays the search speed (FREV x2, FREV x4, FREV x16, FREV x32, FFWD x2, FFWD x4, FFWD x16, FFWD x32)
→ The sound will be muted.
- 2 Use **◀▶** keys to cycle through the search speeds.
- 3 To resume normal playback, press **PLAY ▶**.

TIPS: The operating features described here might not be possible for certain discs. Always refer to the instructions supplied with the discs.

Additional Playback Features (continued)

Using T/C options

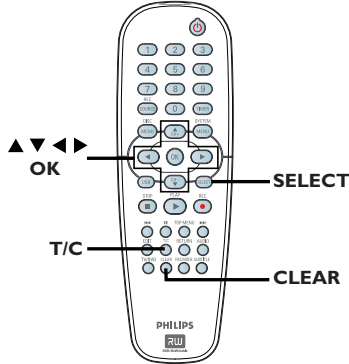

- 1 During playback, press **T/C** on the remote control.
→ The T/C menu appears on the TV.

DVD	
Mode	Normal
Trick mode	Play
Title	02/05
Chapter	01/22
Audio	01/02 - 0TH
Subtitle	Off
Angle	01/03
Title	00:22:03 / 01:27:24

- 2 Use **▲▼** keys to select the setting you want to adjust.
→ Instructions and explanation of the options are provided in the following pages.
- 3 To exit, press **T/C**.

Selecting various repeat/ shuffle functions

You can select various repeat play or random play modes during playback.

- 1 During disc playback, press **T/C** on the remote control.
→ The T/C menu appears.
- 2 Use **▲▼** keys to select { **Mode** } and press **OK**.
- 3 Use **▲▼** keys to select one of the repeat options.

{ **Normal** }

Select this to cancel the repeat mode and return to normal playback.

{ **Repeat A-B** }

Select this to repeat the playback of a specific segment within a title/chapter/ track. Press **OK** to mark the start and end of the segment you want to repeat.

{ **Repeat Chapter** }

Select this to repeat playback of the current chapter (DVD, DVD±R/±RW only).

{ **Repeat Track/Title** }

Select this to repeat playback of the current track/title.

{ **Repeat Directory** }

Select this to repeat playback of the current folder/directory (MP3, JPEG, picture disc only).

{ **Repeat Disc** }

Select this to repeat playback of the entire disc. (MP3, JPEG, SVCD and CDDA discs only).

{ **Shuffle** }

Select this to randomly playback all the tracks within the disc (MP3 and audio CD only).

- 4 To cancel repeat playback, press **STOP** or select { **Normal** } and press **OK**.

TIPS: The operating features described here might not be possible for certain discs. Always refer to the instructions supplied with the discs.

Additional Playback Features (continued)

Creating a playlist

You can play the contents of the disc in the order you want by programming the tracks to be played.

- 1 Press **T/C** on the remote control.
→ The T/C menu appears.
- 2 Select { **Mode** } > { **Program** }.
→ The programme menu appears.

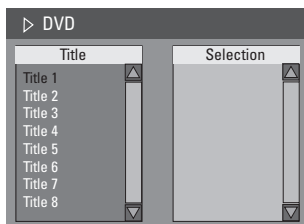

- 3 If the disc is recorded with Titles/Folders/Albums, press **OK** to access the tracks/files/chapters.
- Pressing **OK** at the highlighted track/file/chapter will start playback.
- Use ◀ ▶ keys to toggle between the left and right screen.

To programme your favourite track/file/chapter

- 4 Use ▲ ▼ keys to select the track/file/chapter to programme and press **SELECT** on the remote control.
→ The selected track/file/title will appear at the right screen.
→ The order on the right screen will be the order of programme playback.

To remove the programmed item from your selection

- 5 Press ▶ key to move to the right screen. Select the track/file/chapter and press **CLEAR** on the remote control.

To start programme play

- 6 Press ▶ key to move to the right screen and press **OK**.
→ Playback will start from the selected track/file/chapter according to the programmed sequence.

To exit programme play

- 7 Press **STOP** ■ to exit programme play.

Changing the audio soundtrack language

This operation works only on DVDs with multiple soundtrack language or VCDs with multiple audio channels.

- During disc playback, press **AUDIO** repeatedly to toggle through the audio channels on the disc.

Alternatively,

- 1 Press **T/C** on the remote control.
→ The T/C menu appears.
- 2 Use ▲ ▼ keys to select { **Audio** } and press ▶ to access its options.
- 3 Use ▲ ▼ keys to select the audio language and press **OK** to confirm.
→ The languages may be numbered or abbreviated, such as "En" for English.
→ If the language selected is not available on the disc, the disc's default setting for language will be used instead.

Helpful Hint:

– Some DVDs allow soundtrack language changes only via the DVD disc menu. To access the Disc Menu, press **DISC-MENU**.

TIPS: The operating features described here might not be possible for certain discs. Always refer to the instructions supplied with the discs.

Additional Playback Features (continued)

Changing subtitle language

This operation works only on DVDs with multiple subtitle languages, you can change the language you want during playback of the DVD.

- During disc playback, press **SUBTITLE** repeatedly to toggle through the language options on the disc.

Alternatively,

- 1 Press **T/C** on the remote control.
→ The T/C menu appears.
- 2 Use **▲▼** keys to select { **Subtitle** } and press **▶** to enter the menu and find the different available options.
- 3 Use **▲▼** keys to select the language and press **OK** to confirm.
→ The languages may be numbered or abbreviated, such as “En” for English.
→ If the language selected is not available on the disc, the disc’s default setting language will be used instead.

Helpful Hint:

– Some DVDs discs allow subtitle language changes only via the DVD disc menu. To access the disc menu, press **DISC-MENU**.

Switching camera angles

This option is only available with DVDs that contain sequences recorded from different camera angles. This allows you to view the picture from different angles.

- 1 Press **T/C** on the remote control.
→ The T/C menu appears.
- 2 Use **▲▼** keys to select { **Angle** } and press **▶** to enter its options.
→ The camera angles available for selection appears.
- 3 Use **▲▼** keys to select the camera angle you want to switch to, then press **OK** to confirm.

Time search

This option allows you to skip to a specific point in the current disc.

- 1 Press **T/C** on the remote control.
→ The T/C menu appears.
- 2 Use **▲▼** keys to select { **Title** } and press **▶** to select time search by { **Title** } or { **Chapter** }. To confirm search option, press **OK**.
- 3 Use the **numeric keypad (0-9)** to enter the time required.
→ Playback skips to the selected time.

TIPS: The operating features described here might not be possible for certain discs. Always refer to the instructions supplied with the discs.

Editing/ Finalising Recording

About disc editing

This recorder offers various disc editing options for various disc types. You can change the disc content and settings of a recorded DVD±R/±RW from the disc editing menu. The edited contents may not be available when you play the disc on another DVD player.

The displayed options in the disc editing menu differ depending on the type of disc.

{ Play }

Start playing from the beginning of the disc.

{ Rename Disc }

Change the name of the disc.

{ Erase Disc } - DVD±RW only

Erase all the recordings on the disc.

{ Record New Title }

Start recording from the last empty title on the disc.

{ Overwrite Disc } - DVD±RW only

Start a new recording from the beginning of the disc, all the recorded content will be overwritten.

{ Make Compatible } - DVD±RW only

To ensure the edited changes remain when the disc is played back on another DVD player. (e.g., hidden chapters to remain hidden).

{ Lock/Unlock Disc } - DVD±RW only

Lock or unlock a disc to prevent accidental erasure or changes being made.

{ Finalize Disc } - DVD±R only

Finalise the disc to enable playback on other DVD players. Further recording and editing to the disc are not allowed. It is not possible to unfinalise the disc.

Accessing disc editing menu

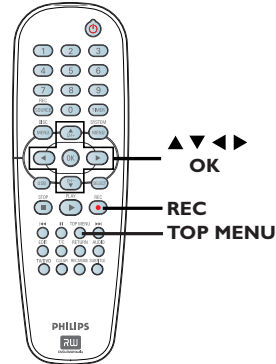

- 1 Insert a recorded DVD±R/±RW into the recorder.
→ The Index Picture screen appears on the TV.
- 2 Press **TOP MENU** on the remote control.
→ The disc editing menu appears. The available editing options are different for DVD±R and DVD±RW discs.



- 3 Use ▲▼ keys to access different options and **OK** to select.
→ Instructions and explanation of the options are provided in the following pages.
- 4 To exit, press **TOP MENU** to go back to the disc Index Picture screen.

TIPS: No further recording and editing can be carried out on a full or finalised DVD±R. Press ◀ to go back to the previous menu.

Editing/ Finalising Recording (continued)

Rename disc

The original disc name is generated automatically by the recorder. You can change the disc name by following the steps below.

- 1 Press **TOP MENU**, then use **▲▼** keys to select { **Rename Disc** } and press **OK**.
→ The keyboard screen appears.
- 2 Use **◀▶▲▼** keys to highlight a character on the keyboard and press **OK** to select.
→ The maximum input is up to 9 characters.
- You can use the following keys on the keyboard screen to edit your input:
 - BkSp** : to remove the character to the left of the cursor.
 - Delete** : to remove the character to the right of the cursor.
 - Space** : to create a space between the characters.
 - Caps** : to toggle between upper and lowercase characters.
 - Clear** : to clear the entry field completely.
- 3 To confirm your entry, select **OK** on the keyboard and press **OK**.
→ The info panel is now updated.
- To cancel the changes, select **EXIT** on the keyboard and press **OK**.

Erase disc (DVD±RW only)

This erases the content of the DVD±RW including those that was not recorded on this recorder. Once the existing content is erased, it can be used again for recording.

- 1 Press **TOP MENU**, then use **▲▼** keys to select { **Erase Disc** } and press **OK**.
→ A warning message will appear.
- 2 Select **YES** in the menu to proceed or **NO** to abort, then press **OK** to confirm.

Record new title

This function allows you to start a new recording at the remaining empty space on the DVD±R/±RW.

- 1 Press **TOP MENU**, then use **▲▼** keys to select { **Record New Title** } and press **OK**.
- 2 Select the source you want to record from and press **REC ●** to start recording.

Overwrite disc (DVD±RW only)

This function allows you to start a new recording from the beginning of a DVD±RW regardless of the contents of the disc.

- 1 Press **TOP MENU**, then use **▲▼** keys to select { **Overwrite disc** } and press **OK**.
- 2 Select the source you want to record from and press **REC ●** to start recording.

TIPS: No further recording and editing can be carried out on a full or finalised DVD±R. Press **◀** to go back to the previous menu.

Editing/ Finalising Recording (continued)

Make compatible (DVD±RW only)

The edited DVD±RW may still display the original titles or hidden scenes when played back on other DVD players. This function ensures that the edited changes of the DVD±RW remain when played back on other players.

- Press **TOP MENU**, then use **▲▼** keys to select { **Make Compatible** } and press **OK** to confirm.

Helpful Hint:

– If the option {Compatible} is not available for selection, it means that the disc is already compatible.

Lock/Unlock disc (DVD±RW only)

You can choose to protect the recorded DVD±RW in order to prevent accidental loss of recordings.

- 1 Press **TOP MENU**, then use **▲▼** keys to select { **Lock Disc** } and press **OK**.
→ The disc is locked for this DVD recorder only.
→ When the disc is locked, the option in the disc editing menu will change to { **Unlock Disc** }.
- 2 If you want to overwrite or edit on the protected disc, select { **Unlock Disc** }.

Playing your recordings (DVD±R) on other DVD players

It is necessary to finalise a DVD±R disc before you can play it on any other DVD player. Otherwise, the DVD±R will only playback on this recorder.

After a DVD±R disc has been finalised, no further recordings or editing can be made to it. Make sure that you have completed all the recordings and editing before finalising the disc.

- 1 Press **TOP MENU**, then use **▲▼** keys to select { **Finalize Disc** } and press **OK**.
→ A warning message will appear.
- 2 Select in the menu and press **OK** to start the process.
→ Finalisation will take a few minutes. Do not try to open the disc tray or turn the power off as this may render the disc unusable.
- 3 Select to abort.

TIPS: No further recording and editing can be carried out on a full or finalised DVD±R. Press **◀** to go back to the previous menu.

Editing/ Finalising Recording (continued)

About title editing

You can change the individual title information or delete a title (recording) in a recorded DVD±R/±RW. If a DVD±R has been finalised, it cannot be edited.

The displayed options in the title editing menu differ depending on the type of disc.

{ Play Title }

Start playing a recording.

{ Edit Title }

Access the video editing menu.

{ Rename Title }

Change the name of the recording.

{ Erase Title } - DVD±RW only

Delete the title (recording).

{ Overwrite Title } - DVD±RW only

Start a new recording, the existing title (recording) will be overwritten.

{ Overwrite Disc } - DVD±RW only

Overwrite from the existing selected title onwards to the end of the disc.

{ Append Title }

Insert a new recording to the last existing recording.

Accessing title editing menu

- 1 Insert a recorded DVD±R/±RW into the recorder.
→ The Index Picture screen appears on the TV.
- During playback, press **DISC MENU** to access the Index Picture screen.
- 2 Use ▲▼ keys to highlight a title (recording), and press ►.
→ The title editing menu appears.



- 3 Use ▲▼ keys to access different options and **OK** to select.
→ Instructions and explanation of the options are provided in the following pages.
- 4 To exit, press ◀.

Video editing

This feature allows access to the video editing menu. See the chapter “Editing/ Finalising Recording – About video editing” for more information.

- In title editing menu, use ▲▼ keys to select { **Edit Title** } and press **OK**.
→ The video editing menu appears.
→ The recorder will play the selected title.

TIPS: No further recording and editing can be carried out on a full or finalised DVD±R.
Press ◀ to go back to the previous menu.

Editing/ Finalising Recording (continued)

Rename title

The original title name is generated automatically by the recorder. You can give a new name to the title by following the steps below.

- 1 In title editing menu, use ▲▼ keys to select { **Rename Title** } and press **OK**.
→ The keyboard screen appears.
 - 2 Use ◀▶ ▲▼ keys to highlight a character and press **OK** to select.
→ The maximum input is up to 9 characters.
- You can use the following keys on the keyboard screen to edit your input:

- : to remove the character to the left of the cursor.
- : to remove the character to the right of the cursor.
- : to create a space between the characters.
- : to toggle between upper and lowercase characters.
- : to clear the entry field completely.

- 3 To confirm your entry, select on the keyboard and press **OK**.
→ The info panel is now updated.
- To cancel the changes, select on the keyboard and press **OK**.

Erase title (DVD±RW only)

You can delete a specific title (recording) from the disc.

- 1 In title editing menu, use ▲▼ keys to select { **Erase Title** } and press **OK**.
→ A warning message will appear.
- 2 Select in the menu to proceed or to abort, then press **OK** to confirm.

TIPS: No further recording and editing can be carried out on a full or finalised DVD±R. Press ◀ to go back to the previous menu.

Overwrite title (DVD±RW only)

This function allows you to record a new title from the beginning of the current title in the DVD±RW. The other titles will not be affected.

- 1 In title editing menu, use ▲▼ keys to select { **Overwrite Title** } and press **OK**.
- 2 Select the source you want to record from and press **REC ●** to start recording.

Overwrite disc

You can select to overwrite only the recordings from the selected title to the end of the disc.

- In video editing menu, use ▲▼ keys to select { **Overwrite Disc** } and press **OK** to confirm.

Append recording

This function allows you to add a recording to the last existing title.

- 1 In title editing menu, use ▲▼ keys to select { **Append Title** } and press **OK**.
- 2 Press **REC SOURCE** to select the input channel to append.
- 3 Press **REC ●** to start append recording.
- 4 To stop append recording, press **STOP ■**.

Editing/ Finalising Recording (continued)

About video editing

After a recording has been made, this recorder allows you to edit the video content. You can add/delete chapter markers, hide unwanted scenes, change the picture in the index picture screen and split a title (recording) into two.

When you playback a recording in video edit mode, the entire recording will be played back including hidden scenes.

The edit functions available in the disc editing menu are:

{ Title }

Select a title (recording) to playback.

{ Chapter }

Select a chapter within the selected title.

{ Chapter Marker }

Insert a chapter marker in the recording or erase a chapter marker to combine two chapters.

{ Hide Chapter }

Hide the unwanted scene in the recording.

{ Index Picture }

Select a scene in the recording as the index picture screen.

{ Split Title } - DVD±RW only

Divide the recording into two under separate titles.

Accessing video editing menu

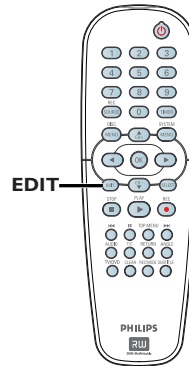

- 1 Insert a recorded DVD±R/±RW into the recorder.
→ The Index Picture screen appears on the TV.
- 2 Use ▲▼ keys to select a title (recording).
- 3 Press **PLAY** ► to start playback.
- 4 Press **EDIT** on the remote control.
→ The video editing menu appears.

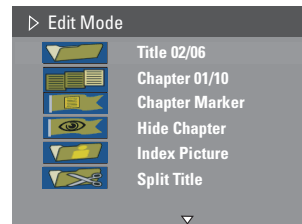

- 5 Use ▲▼ keys to access different options and press **OK** to select.
→ Instructions and explanation of the options are provided in the following pages.
- 6 To exit, press **EDIT**.

TIPS: No further recording and editing can be carried out on a full or finalised DVD±R.
Press ◀ to go back to the previous menu.

Editing/ Finalising Recording (continued)

Selecting a title

This option shows the current title and the total number of titles on the disc.

- 1 During playback, press **EDIT** to display the video editing menu, then use **▲▼** keys to select  { **Title** } and press **OK**.
- 2 Use the **numeric keypad 0-9** to key in a title and press **OK**.
→ The recorder will playback the selected title.

Selecting a chapter

This option shows the current chapter and the total number of chapters in the title.

- 1 During playback, press **EDIT** to display the video editing menu, then use **▲▼** keys to select  { **Chapter** } and press **OK**.
- 2 Use the **numeric keypad 0-9** to key in the chapter and press **OK**.
→ The recorder will playback the selected chapter.

Creating chapter markers

You can create a chapter by inserting chapter markers at any point within a title during playback. This will allow you to access a specific point in the recording easily or set a chapter you wish to hide.

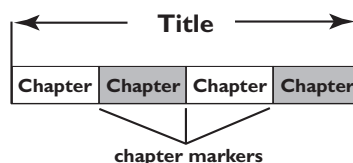

- 1 During playback, press **EDIT** to display the video editing menu, then use **▲▼** keys to select  { **Chapter Marker** } and press **OK**.
- 2 Use **▲▼** keys to select one of the options and press **OK** to confirm.

{ **Insert Marker** }

Select this to insert a new chapter marker at the current point of playback.

{ **Delete Marker** }

Select this to delete the current chapter marker (it refers to the closest marker before the current point of playback).

{ **Delete All Markers** }

Select this to delete all the chapter markers in the current title.

TIPS: No further recording and editing can be carried out on a full or finalised DVD±R. Press **◀** to go back to the previous menu.

Editing/ Finalising Recording (continued)

Hiding unwanted scenes

You can choose to hide certain scenes from playback (e.g. skipping commercials) or make it visible again.

- 1 Create a chapter marker at the start and end of the scene you want to hide. (See previous page on “Creating Chapter Markers”).
 - 2 Select the chapter you want to hide and start playback. (See previous page on “Selecting a chapter”).
 - 3 During playback, press **EDIT** to display the video editing menu, then use **▲▼** keys to select  { **Hide Chapter** } and press **OK**.
→ The current chapter will be hidden.
- If the video editing menu does not show, press **EDIT** on the remote control.

To unhide a chapter

- 1 Press **EDIT** on the remote control during playback.
→ The video editing menu appears.
→ While in editing mode, the hidden chapter/chapters will be played back.
- 2 Wait for the chapter you want to unhide to occur or use **I◀◀▶▶I** keys on the remote control to make a fast search.
- 3 Use **▲▼** keys to select { **Unhide Chapter** } and press **OK**.
→ The current chapter will be visible during playback.

Helpful Hint:

- All the hidden chapters will be played back while in video editing mode.
- To locate a specific frame during playback, press **PAUSE ||** repeatedly to forward search to the frame that you want.

Changing Index Picture

The index picture is the picture of the title you will see when the recorder loads up the Index menu. Normally, the first frame of a recording is shown as the title's index picture.

- 1 During playback, use **◀▶** keys on the remote control to search for the scene to use, then press **PAUSE ||**.
→ Press **PAUSE ||** again to move forward to next pause scene.
- 2 Press **EDIT** to display the video editing menu, then use **▲▼** keys to select  { **Index Picture** } and press **OK** to select the current scene as the index picture for the title.

Splitting a title (DVD±RW only)

You can divide the current title into two new titles. Each of these titles is characterised by its own index picture.

Warning! Once a title is divided, the process cannot be reversed.

- During playback, press **EDIT** to display the video editing menu, then use **▲▼** keys to select  { **Split Title** } and press **OK** to divide the title at the current playback position.
→ A new title will be shown at the Index Picture screen.

TIPS: No further recording and editing can be carried out on a full or finalised DVD±R. Press **◀** to go back to the previous menu.

DVD System Menu Options

Accessing the System Menu

The system menu provides various options for you to adjust the recorder to suit your preferences.

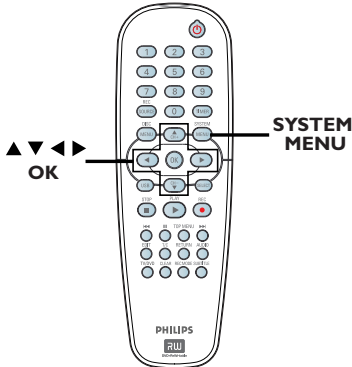

- 1 Press **SYSTEM MENU** on the remote control.
→ The system menu appears on TV.
- 2 Use ▲▼ keys to highlight a menu item and press ► to access its options.
- 3 Use ▲▼ keys to highlight the setting you wish to change and press **OK** to confirm and return to the previous menu item.
→ Instructions and explanation of the options are provided in the following pages.
- 4 To exit, press **SYSTEM MENU**.

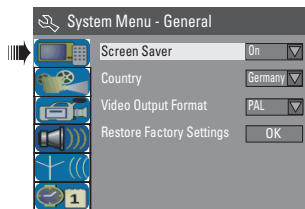

See the next page.

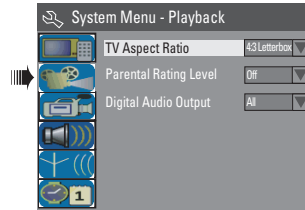

See this chapter “PLAYBACK settings”.

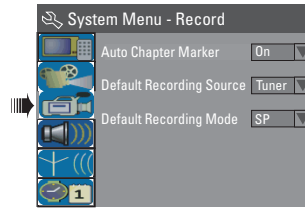

See the chapter “Recording – RECORD settings”.

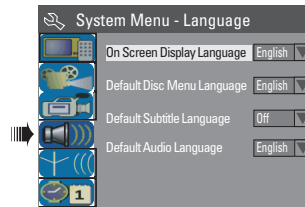

See this chapter “LANGUAGE settings”.

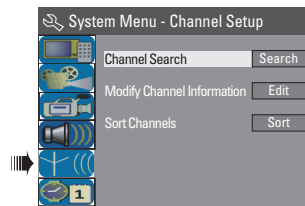

See this chapter “CHANNEL SETUP settings”.

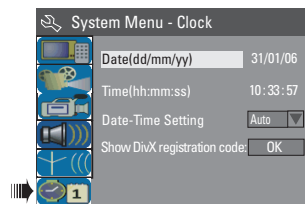

See this chapter “CLOCK settings”.

DVD System Menu Options (continued)

GENERAL settings (underlined options are the factory default settings)

Screen Saver

A screen saver prevents damage to the TV screen by avoiding exposure to a static image for too long.

1) Use **▲▼** keys to select one of the options.

{ On } – Select this if you wish to turn off the TV screen after playback had been stopped or paused for longer than 15 minutes.

{ Off } – Select this to disable the screen saver.

2) Press **OK** to confirm your selection.

Country

Select the country of your area for auto channel tuning. (See section “ Step 3: Installation and Setup - Select the country of your residence”)

Video Output Format

The colour system of the DVD system, DVD and TV should match. Only then will it be possible to play a DVD on this system. Before changing the TV system, determine the colour system of your TV set.

1) Use **▲▼** keys to select one of the options.

{ NTSC } – Select this if the connected TV set has the NTSC colour system. It will change the video signal of a PAL disc and output it to NTSC format.

{ PAL } – Select this if the connected TV set has the PAL colour system. It will change the video signal of an NTSC disc and output it to PAL format.

2) Press **OK** to confirm your selection.

Helpful Hint:

– If a blank/distorted TV screen appears, wait for 10 seconds for the auto recovery.

Restore Factory Settings

This option will restore all the settings of this recorder, except for the PIN code.

Restore Factory settings can only be changed when there is no disc in the disc tray.

1) Use **▲▼** keys to select { **Restore Factory Settings** } and press **OK**.

→ A warning message will appear.

2) Select **OK** in the menu to proceed or **CANCEL** to abort, then press **OK** to confirm.

DVD System Menu Options (continued)

PLAYBACK settings (underlined options are the factory default settings)

TV Aspect Ratio

Set the aspect ratio of the recorder according to the TV type you have connected.

1) Use **▲▼** keys to select one of the options.

{ **16:9** } – Select this for wide screen TV (frame ratio 16:9).



{ **4:3 Panscan** } – Select this for a full-height picture with both side trimmed.



{ **4:3 Letterbox** } – Select this for a 'wide screen' display with black bands on the upper and lower portions of the TV screen.



2) Press **OK** to confirm your selection.

Parental Rating Level

Some DVDs may have a parental level assigned to the complete disc or to certain scenes on the disc. This feature lets you set a playback limitation level.

1) Press **OK** to access this menu and you will be prompted to enter your four-digit pin code.

2) Use the numeric keypad 0-9 to enter your four-digit pin code.
 → When doing this for the first time, enter the default password '3308'.
 → The set rating level menu appears.

● If you forget your four-digit pin code, the default password is 3308.

3) Use **▲▼** keys to select the desired parental level, then move to **OK** in the menu and press **OK** on the remote control to confirm.

→ To disable parental controls and allow all discs to play, select { **Off** }.

● Press **▶** to access this menu and use **▲▼** keys to select one of the options.

Rating explanations

{ **Off** } – Parental control is not active.

{ **1. Kid Safe** } ~ { **2. G** } – Childsafe; acceptable for viewers of all ages.

{ **3. PG** } – Parental Guidance suggested.

{ **4. PG13** } – Unsuitable for children under age 13.

{ **5. PG R** } ~ { **6. R** } – Restricted; recommended that parents restrict children under 17 from viewing or allow to view only when supervised by a parent or adult guardian.

DVD System Menu Options (continued)

PLAYBACK settings (underlined options are the factory default settings)

Parental Rating Level

- { **7. NC 17** } – No children under age 17; not recommended viewing for children under age 17.
- { **8. Adult** } – Mature material; should be viewed only by adults due to graphic sexual material, violence or language.

DVDs that are rated higher than the level you have selected will not play unless you enter your four-digit pin code.

Helpful hints:

- VCD, SVCD, CDs have no level indication, so parental control has no effect on these type of discs. This also applies to most illegal DVDs.
- Some DVDs are not coded with a rating though the movie rating may be printed on the disc cover. The rating level feature does not prohibit play of such discs.

To change your password

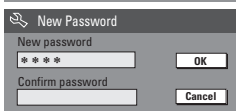

- 1) Select { **Parental Rating Level** } and press **OK**.
→ You will be prompted to enter your four-digit pin code.
- 2) Use the **numeric keypad 0-9** to enter your four-digit pin code and select **OK** in the menu and press **OK** on the remote control to confirm.
→ The set rating level menu appears.
- 3) Select **New** in the menu and press OK to access new password menu.
- 4) Use the **numeric keypad 0-9** to enter your new four-digit pin code, then press ▼ to select the next entry field and enter the same pin code a second time.
- 5) Select **OK** in the menu and press **OK** to confirm.
→ To abort the change, select **CANCEL** and press **OK**.

Digital Audio Output

Adjust the digital output setting only if you have connected other devices to the coaxial socket on the recorder.

- 1) Use ▲▼ keys to select one of the options.
 - { **All** } – Select this if you have used the COAXIAL socket on the recorder to connect to a stereo receiver that has a built-in multichannel decoder.
 - { **LPCM** } – Select this if the connected audio equipment is not capable of decoding multichannel audio. Dolby Digital and MPEG-2 multichannel signals are converted to PCM (Pulse Code Modulation).
- 2) Press **OK** to confirm your selection.

DVD System Menu Options (continued)

RECORD settings

Auto Chapter Marker	Insert chapter markers within a title during recording. This allows you access to specific points on the recording. See the chapter “Recording – RECORD settings”.
Default Recording Source	Define your preferred source of recording. The default source is selected when the recorder is switched on. See the chapter “Recording – RECORD settings”.
Default Recording Mode	Define your preferred mode of recording. See the chapter “Recording – RECORD settings”.

LANGUAGE settings

On-Screen Display Language	Select the menu language for this recorder on-screen display.
Default Disc Menu Language	Select the preferred disc menu language for DVD playback.
Default Subtitle Language	Select the preferred subtitle language for DVD playback.
Default Audio Language	Select the preferred audio language for DVD playback.
	<p><i>Helpful Hints:</i></p> <ul style="list-style-type: none"> – If the selected audio/subtitle language is not available on the disc, the disc’s default setting language will be used instead. – For some DVDs, the subtitle/audio language can only be changed via the DVD disc menu.

DVD System Menu Options (continued)

CHANNEL SETUP settings

Channel Search

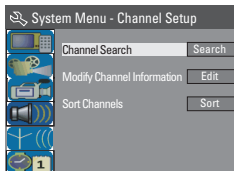

Automatically scan all the receivable analogue local TV channels and store these channels on the recorder.

- Use ▲▼ keys to highlight { **Channel Search** } and press **OK**.
 → The automatic TV channel search starts. This process may take several minutes. Once complete, the total number of channels found and stored appears on the TV.

Modify Channel Information

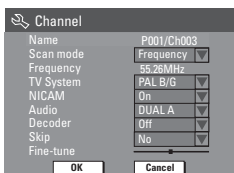

Adjust a stored TV channel to your preference, improve the reception and the sound quality of that TV channel.

- 1) Use ▲▼ keys to highlight { **Modify Channel Information** } and press **OK**.
 → The channel menu appears.
- 2) Use ▲▼ keys to select one of the options.

- { **Name** } – You can use the numeric keypad 0-9 to select the channel preset number which you wish to change.
 – Use ▲▼ keys to change alphabet/ number and use ◀▶ keys to select different entry fields, then press **OK** to confirm.
- { **Scan Mode** } – Select TV channel search mode based on channel allocation or frequency.
 – Use ▲▼ keys to select { **Frequency** }, { **Channel** } or { **S-Channel** } (Special Channel), then press **OK** to confirm.
- { **Frequency** } – Shows the frequency of the current TV channel.
 – If required, use ◀▶ keys to start the automatic frequency search and press **OK** to confirm.
- { **TV System** } – Set the TV system that produces the least distortion of picture and sound.
 – Use ▲▼ keys to select a suitable sound mode, then press **OK** to confirm. (See chapter “TV System Guide” at the back of this manual for more information).
- { **NICAM** } – Turn on or off the digital sound transmission system which improves the sound quality of the TV channel.
 – Use ▲▼ keys to select { **On** } or { **Off** }, then press **OK** to confirm.

DVD System Menu Options (continued)

CHANNEL SETUP settings (continued)

Modify Channel Information

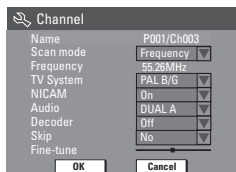

- { **Audio** } – For bilingual TV programmes, you can switch between stereo (original) and additional audio language.
– Use ▲▼ keys to select { **DUAL A** } or { **DUAL B** }, then press **OK** to confirm.
- { **Decoder** } – If you have connected the recorder with an external decoder, set it to { **On** } and press **OK** to confirm.
- { **Skip** } – Select this to set the channel to be skipped. The skipped channels can only be accessed by pressing the corresponding number key on the remote control.
– Use ▲▼ keys to choose { **Yes** } if you wish to skip this channel, then press **OK** to confirm.
- { **Fine-Tune** } – Select this to fine-tune the TV channel manually if the reception is poor.
– Use ◀▶ keys to adjust the frequency.

3) To confirm all settings, select and press **OK**.

Sort Channels

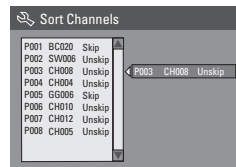

Rearrange all stored TV channels.

- 1) Use ▲▼ keys to highlight { **Sort Channels** } and press **OK**.
→ The list of TV channel programmes appears.
- 2) Use ▲▼ keys to highlight the channel you want to change and press **OK**.
→ The selected channel will move to the right side of the screen.
- 3) Use ▲▼ keys to shift the TV channel to the desired position and press **OK** again.
→ The selected channel will be inserted before the current position.
- 4) Repeat steps ②~③ until you have sorted all the TV channels you want.
- 5) Press **RETURN** on the remote control to go back to the previous menu.

DVD System Menu Options (continued)

CLOCK settings (underlined options are the factory default settings)

Date (dd/mm/yy) Use ▲▼ keys to change the number and use ◀▶ keys to select different entry fields, then press **OK** to confirm.

Time (hh:mm:ss) Use ▲▼ keys to change the number and use ◀▶ keys to select different entry fields, then press **OK** to confirm.

Date-Time Setting You can choose to enable/disable the automatic setting of date and time. This feature is dependent on your local broadcaster.

- 1) Use ▲▼ keys to select one of the options.
 - { Auto } – Select to activate automatic setting of date and time.
 - { Manual } – Select this to manually set the date and time.
- 2) Press **OK** to confirm your selection.

**Show DivX®
Registration code** Select to view the DivX® VOD (Video On Demand) registration code that allows you to rent and purchase videos using the DivX® VOD service. For more information, visit us at www.divx.com/vod.

- 1) Press ▶ to display the registration code.
- 2) Use the registration code to purchase or rent videos from DivX® VOD service at www.divx.com/vod. Follow the instructions and copy the video from your computer onto a CD-R/RW or recordable DVD disc for playback on this recorder.

Software Upgrade

Installing the latest software

The software installed in your recorder is continuously being refined for greater stability and compatibility of the set. Periodically, Philips will issue upgrades for the software which you copy onto a CD and install the software of your recorder.

Caution! Power supply must not be interrupted during upgrade!

- Visit Philips' website at 'www.philips.com/support' to check for the availability of the latest software upgrade.

Note: When checking for the latest software upgrade, please also check for any accompanying instructions on installing the software.

Picture/Display

- Aspect ratio: 4:3, 16:9
- D/A converter: 10 bit, 54 MHz
- A/D converter: 10 bit, 27 MHz

Sound

- D/A converter: 24 bit, 192 kHz
- A/D converter: 24 bit, 96 kHz
- Signal to noise ratio: 106
- Crosstalk (1kHz): 105 dB
- Dynamic Range (1kHz): 90 dB

Video Recording

- Recording system: PAL
- Compression formats: MPEG2
 - High Quality : HQ
 - Standard Play : SP
 - Extended Play : EP
 - Super Long Play : SLP
- Audio compression: Dolby Digital, PCM

Video Playback

- Disc playback media: CD, CD-R/-RW, DVD, DVD-Video, DVD+R/+RW, DVD-R/-RW SVCD, Video CD
- Compression formats: MPEG2, MPEG1, DivX®
- Video disc playback system: NTSC, PAL

Audio Playback

- Disc playback media: CD, CD-R/-RW, MP3-CD, MP3-DVD
- Compression formats: Dolby Digital, MP3, MPEG2 Multichannel, PCM
- MP3 bit rates: 32~256 kbps and VBR

Still Picture Playback

- Disc formats: DVD+R/+RW, DVD-R/-RW, Picture CD
- Picture compression formats: JPEG
- Picture enhancement: Rotate

Storage Media

- Recording media: DVD+R, DVD+RW, DVD-R, DVD-RW

Tuner/Reception/Transmission

- TV system: PAL
- Aerial Input: 75 Ohm coaxial (IEC75)

Connectivity

Rear Connections:

- SCART (2x)
- S-Video Out
- Video (CVBS) Out
- Audio left/right Out
- Digital audio out (coaxial)
- RF antenna in
- RF TV out
- Mains

Front Connections:

- i.LINK DV in (IEEE 1394 4-pin)
- Video In (CAM1)
- Audio left/right In

Convenience

- Programming/Timer Enhancements: Daily/Weekly, Repeat Programme, Manual Timer, One Touch Recording, SHOWVIEW®
- Programmable events: 8

Power

- Power supply: 220 – 230V; 50 Hz
- Consumption: 25 W (typical)
- Standby power consumption: < 3W

Cabinet

- Dimensions (W x H x D) : 360 x 43 x 322 mm
- Net Weight : 3 kg

Troubleshooting

WARNING

Under no circumstances should you try to repair the system yourself, as this will invalidate the warranty. Do not open the system as there is a risk of electric shock.

If a fault occurs, first check the points listed below before taking the system for repair. If you are unable to remedy a problem by following these hints, consult your dealer or Philips for help.

Problem (General)	Solution
No power.	<ul style="list-style-type: none"> – Press STANDBY-ON button on the front of the recorder to switch on the system. – Make sure the AC outlet has power.
Remote control does not work.	<ul style="list-style-type: none"> – Aim the remote control directly at the sensor on the front of the DVD recorder (not towards TV). – Remove any obstacles between the recorder and the remote control. Aim the remote control towards the set at different angles and/or distances. – Batteries are weak, replace the batteries. – Press REC SOURCE on the remote control to select an input source.
No picture.	<ul style="list-style-type: none"> – Switch on your TV and set to the correct Video In channel. Switch the TV channel until you see the DVD screen. Read chapter “Step 3 - Installation and Setup – Finding the correct viewing channel” for details. – Check the video connection between the recorder and the TV.
No sound.	<ul style="list-style-type: none"> – Check the audio connections, the red and white sockets. Read chapters “Step 1 : Basic Reorder Connections - Connecting the audio cables” for details. – Set the Digital output correctly, based on the equipment you connected to the recorder. Read chapter “DVD System Menu Options - PLAYBACK settings – Digital Audio Output” for details.
No TV signal received from the recorder.	<ul style="list-style-type: none"> – Have your antenna or cable TV signal checked. – Install the TV channel. Read chapter “Step 3: Installation and Setup - Setting your TV channel programmes” for details.
A TV channel installed during the DVD recorder's automatic TV channel search is fuzzy or distorted.	<ul style="list-style-type: none"> – Check the video connection between the DVD recorder and the TV. – You can further fine-tune the signal of the TV channel. Read chapter on “DVD System Menu Options – CHANNEL SETUP Settings” – Press CH + / – to search for the same TV channel which may have a clearer picture.
Unable to eject tray	<ul style="list-style-type: none"> – Exit from any on-screen menu until you see the Philips wallpaper – Press STOP to stop any playback or recording, then press EJECT on the set.

Troubleshooting (continued)

Problem (Playback)	Solution
Disc does not play.	<ul style="list-style-type: none">– Insert the disc with the label facing up.– Wrong region code. The DVD must be coded for ALL regions or Region 5 in order to be played back on this DVD recorder.– There is no recording on the disc or wrong disc type. Read chapter “Playback - Playable discs” for details.– Make sure the disc is not scratched or warped. Clean the disc or replace a new one.– Check if the disc is defective by trying another disc.
Distorted sound coming from a connected hi-fi system or amplifier.	<ul style="list-style-type: none">– Do not connect any cables from the recorder to the ‘Phono’ input of your amplifier.
Unable to play DivX® movies.	<ul style="list-style-type: none">– Check that the DivX® file is encoded according to the ‘Home Theatre Profile’ mode with DivX® encoder.– Check that the DivX® movie downloaded is a complete file.
The picture is distorted or black and white during playback.	<ul style="list-style-type: none">– The disc does not match with the TV colour system standard (PAL/NTSC).– The disc is dirty, clean the disc.– Sometimes a small amount of picture distortion may appear. This is not a malfunction.
A DVD±R/±RW recorded on this DVD recorder does not play on a DVD player.	<ul style="list-style-type: none">– If a recording is too short, it is possible that a DVD player cannot detect it. Please observe the following ‘minimum recording times’. Recording mode : { HQ } – 5 mins, { SP } – 10 mins, { EP } – 20 mins, { SLP } – 30 mins.– You have to finalise the DVD±R. Refer to chapter “Playing your recordings (DVD±R) on other DVD players” for details.
There is picture or sound interference with the TV reception.	<ul style="list-style-type: none">– Have your antenna or cable TV signal checked.– Fine-tune your TV channel. Read chapter “Step 3 : Installation and Setup - Setting your TV channel programmes” for details.
The message ‘UNKNOWN DISC’ appears.	<ul style="list-style-type: none">– This message may appear if you insert a disc that may have encountered one of the following:<ul style="list-style-type: none">– Error during recording: The title may be missing.– Error while changing the title/index picture: The original title/index picture may be visible.– Error while finalising or the disc has not been finalised.

Troubleshooting (continued)

English

Problem (Recording)	Solution
The wrong TV channel was decoded (recorded) after you programmed a recording using the SHOWVIEW® system.	<ol style="list-style-type: none">1) Enter the SHOWVIEW® programming number of the desired TV channel.2) Press OK to confirm.3) Check the channel number in the {Program #} input field. If this does not correspond to the desired TV channel, select this entry field and change the channel number.4) Press OK to confirm.
Picture is fuzzy and brightness varies when copying DVD Video discs or prerecorded video cassettes.	<ul style="list-style-type: none">– This happens if you try to copy DVDs or video cassettes that have been copy-protected. Even though the picture on the TV is fine, but the recording on the DVD recordable disc is faulty. This interference is unavoidable with copy-protected DVDs or video cassettes.– The DVD recordable disc has a limited recording lifetime, please change a new disc for recording.
Recordings are not occurring as scheduled. New recordings cannot be made.	<ul style="list-style-type: none">– The TV channel you want to record is not stored or you selected the wrong program number. Check the TV channels stored.– You have to reset the timer recording after adjusting the clock setting.– You cannot use the recorder to duplicate copy-protected materials (DVDs or video tapes) onto a DVD recordable disc.
The picture on my decoder appears to be distorted during recording.	<ul style="list-style-type: none">– If you are recording a programme from your decoder box, you can view the same programme by pressing TV/DVD on the recorder's remote control.

Frequently Asked Questions

What kind of disc should I use for recording?

You can record on both DVD±R and DVD±RW discs. They are compatible with DVD-Video players and DVD-ROM drives in computers.

What is the capacity of a DVD±R/±RW disc?

4.7GB, or equivalent to six CDs. You can store only one hour of recordings on a single disc at the highest quality (DVD standard) and about 6 hours recordings at the lowest quality (VHS standard).

What is the difference between DVD±R and DVD±RW?

DVD±R is “recordable” and DVD±RW is “rewritable”. With a DVD±R, you can record multiple sessions on the same disc, but when the disc is full, you cannot record any more on the disc. The DVD±RW allows you to record over the same disc repeatedly.

What is DV?

Using DV, also known as i.LINK, you can connect a DV-equipped camcorder to this recorder using a single DV cable for input and output of audio, video, data and control signals.

- This recorder is only compatible with DV-format (DVC-SD) camcorders. Digital satellite tuners and Digital VHS video recorders are not compatible.
- You cannot connect more than one DV camcorder at a time to this recorder.
- You cannot control this recorder from external equipment connected via the DV IN socket.

Can I copy a VHS tape or DVD from an external player?

Yes, but only if the VHS tape or DVD is not copy protected.

What are Titles and Chapters?

A DVD disc contains Titles and Chapters, which are similar to the Titles and Chapters of a book. A Title is often a complete movie and is broken down into Chapters, or individual scenes from the movies.

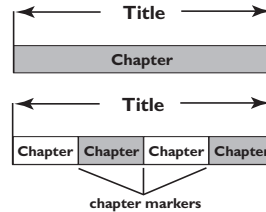

Programmes are recorded as a single title, it may consist of one chapter or a few chapters within a title, depending on the recording settings.

How do I set up Titles and Chapters?

The recorder automatically creates a new Title every time you start a new recording. You can then add Chapters to these recordings manually or have them automatically inserted at 5-minutes intervals.

What does “finalising” a disc do?

Finalising a disc locks the disc so it can no longer be used for recording. This is only required for DVD±R discs. It will then be compatible with virtually any DVD player. To remove a disc without finalising it, simply stop recording and eject the disc. You will still be able to record on the disc if there is storage space for more recordings.

How good is the quality of the recording?

There are a few quality levels to choose from, ranging from “HQ” - High Quality (1 hour mode) to “SLP” - Super Long Play (6 hours mode). Press the **REC MODE** key on the remote control to choose the quality level that best suits your purpose and the length of material.

Record Mode	Picture Quality	Maximum Recording Time per Disc
HQ	High quality	1 hour
SP	DVD quality-Standard Play	2 hours
EP	VHS quality-Extended Play	4 hours
SLP	VHS quality-Super Long Play	6 hours

Glossary

Analogue: Sound that has not been turned into numbers. Analogue sound varies, while digital sound has specific numerical values. These sockets send audio through two channels, the left and right.

Aspect ratio: The ratio of vertical and horizontal sizes of a displayed image. The horizontal vs. vertical ratio of conventional TVs is 4:3, and that of wide-screens is 16:9.

AUDIO OUT sockets: Red and white sockets on the back of the system that send audio to another system (TV, Stereo, etc).

Chapter: Sections of a picture or a music piece on a DVD that are smaller than titles. A title is composed of several chapters. Each chapter is assigned a chapter number enabling you to locate the chapter you want.

Digital: Sound that has been converted into numerical values. Digital sound is available when you use the DIGITAL AUDIO OUT COAXIAL. These sockets send audio through multiple channels, instead of just two channels as analogue does.

Disc menu: A screen display prepared for allowing selection of images, sounds, subtitles, multi-angles, etc recorded on a DVD.

DivX® 3.11/4.x/5.x/6: The DivX® code is a patent-pending, MPEG-4 based video compression technology, developed by DivX® Inc., that can shrink digital video to sizes small enough to be transported over the internet, while maintaining high visual quality.

Dolby Digital: A surround sound system developed by Dolby Laboratories containing up to six channels of digital audio (front left and right, surround left and right, centre and subwoofer).

Index Picture Screen: A screen that gives an overview of a DVD±RW or DVD±R. An Index Picture represents each recording.

JPEG: A very common digital still picture format. A still-picture data compression system proposed by the Joint Photographic Expert Group, which features small decrease in image quality in spite of its high compression ratio.

MP3: A file format with a sound data compression system. "MP3" is the abbreviation of Motion Picture Experts Group 1 (or MPEG-1) Audio Layer 3. By using the MP3 format, one CD-R or CD-RW can contain about 10 times more data than a regular CD.

MPEG: Motion Picture Experts Group. A collection of compression systems for digital audio and video.

Multichannel: DVDs are formatted to have each sound track constitute one sound field. Multichannel refers to a structure of sound tracks having three or more channels.

PBC: Playback Control. Refers to the signal recorded on video CDs or SVCDs for controlling playback. By using menu screens recorded on a Video CD or SVCD that supports PBC, you can enjoy interactive playback and searching.

PCM: Pulse Code Modulation. A digital audio encoding system.

Parental control: Limits disc play according to the age of the users or the limitation level in each country. The limitation varies from disc to disc; when it is activated, playback will be prohibited if the software's level is higher than the user-set level.

Region code: A system allowing discs to be played only in the region designated. This unit will only play discs that have compatible region codes. You can find the region code of your unit by looking on the product label. Some discs are compatible with more than one region (or ALL regions).

S-Video: Produces a clear picture by sending separate signals for the luminance and the colour. You can use S-Video only if your TV has an S-Video In socket.

Surround: A system for creating realistic three dimensional sound fields full of realism by arranging multiple speakers around the listener.

Title: The longest section of a movie or music feature on DVD. Each title is assigned a title number, enabling you to locate the title you want.

VIDEO OUT socket: Yellow socket on the back of the DVD system that sends the DVD picture video to a TV.

Display panel symbols/ messages

The following symbols/ messages may appear on your recorder display:

- 00:00:00
Multifunction display/ text line
 - Title/ track number
 - Total/ elapsed/remaining title/track time
 - Additional information regarding the disc
 - TV channel number or source of video
 - Clock (This is displayed in Standby mode).
 - TV programme title
- BLANK
There are no recordings on the disc in the tray.
- FULL
Disc is full. There is no storage space for new recordings.
- LOADING
Disc is being recognised by the recorder.
- MENU
The system setup menu, disc menu, title menu or timer menu display is on.
- NO DISC
No disc has been inserted. If a disc has been inserted, then it is possible that the disc cannot be read.
- OPEN
Disc tray is opening or opened.
- PHOTO
A picture disc has been inserted.
- STARTUP
The recorder has been turned on.
- REGION
When the DVD inserted is in a wrong region code as the recorder.
- STOP
When playback / recording is stopped.
- TOPMENU
The recorder is in TOP MENU mode.
- ⏸ TIMER
A timer recording has been programmed or is active.
- UPDATE
The recorder is writing to the disc.
- UNKNOWN
The recorder has encountered an error in handling the disc inserted.