



CD PORTABLE SYSTEM

**RD-N1
RD-N1W**

INSTRUCTIONS



MP3/WMA

Radio Data System (Europe only)

LVT2130-002B [J, C, B, US, A, UX]
0910TMMMDWMTS

©2010 Victor Company of Japan, Limited

Thank you for purchasing a JVC product.

CAUTION: Proper Ventilation
To avoid risk of electric shock and fire, and to prevent damage, locate the apparatus as follows:
1. Front: No obstructions and open spacing.
2. Sides/Top/Back: No obstructions should be placed in the areas indicated by the dimensions in the illustration.
3. Bottom: Place on the level surface. Maintain an adequate air path for ventilation by placing on a stand with a height of 10 cm or more.

Front view/Face

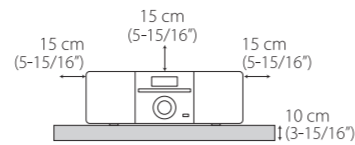

Side view/Côté

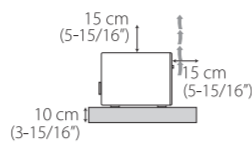

ATTENTION: Aération correcte
Pour prévenir tout risque de décharge électrique ou d'incendie et éviter toute détérioration, installez l'appareil de la manière suivante:
1. Avant: Bien dégagé de tout objet.
2. Flancs/ Dessus/ Arrière: Aucun obstacle ne doit être placé dans les zones indiquées par les dimensions dans l'illustration.
3. Dessous: Posez l'appareil sur une surface plane et horizontale. Veillez à ce que sa ventilation correcte puisse se faire en le plaçant sur un support d'au moins dix centimètres de hauteur.

Specifications

Amplifier section
Output Power: 6 W (3 W + 3 W) at 3 Ω (10% THD)
Audio Input: AUDIO IN: Stereo mini (ø 3.5 mm) 250 mV/47 kΩ USB MEMORY
Digital input:
Tuner
FM tuning range: 87.50 MHz – 108.00 MHz
Disc player
Dynamic range: 80 dB
Wow and flutter: Immeasurable
USB
USB specification: Compatible with USB 2.0 Full Speed
Compatible device: Mass storage class
Compatible system: FAT16, FAT32
Output power: DC 5 V === 500 mA

Supplied accessories
See "Supplied accessories" in "Getting started."
Design and specifications are subject to change without notice.

iPod
Output power: DC 5 V === 500 mA
General
Speaker type: Bass-Reflex type
Speaker unit: 9 cm (3-9/16 inches) x 2
Speaker impedance: 3 Ω
Power requirements:
For USA and Canadian models AC 120 V / 60 Hz
For European models AC 230 V / 50 Hz
For Australian models AC 240 V / 50 Hz
For other models AC 110 V – 127 V / 220 V – 240 V adjustable with voltage selector, 50/60 Hz
Power consumption: 35 W (at operation) 1.00 W or less (on standby)
Dimensions (approx.): 400 mm × 141 mm × 211 mm (15-3/4 inches x 5-9/16 inches x 8-5/16 inches) (W × H × D)
Mass (approx.): 3.3 kg (7.3 lbs)

For USA-California Only
This product contains a CR Coin Cell Lithium Battery which contains Perchlorate Material—special handling may apply.
See www.dtsc.ca.gov/hazardouswaste/perchlorate

- Microsoft and Windows Media are either registered trademarks or trademarks of Microsoft Corporation in the United States and/or other countries.
- iPod is a trademark of Apple Inc., registered in the U.S. and other countries.
- "Made for iPod" means that an electronic accessory has been designed to connect specifically to iPod and has been certified by the developer to meet Apple performance standards.
- Apple is not responsible for the operation of this device or its compliance with safety and regulatory standards.

Getting started

- Supplied accessories**
After unpacking, check to make sure that you have all the following items:
• Remote control (× 1)
• Lithium coin battery CR2025 (× 1)
– The battery has been installed in the remote control when shipped from the factory.
• FM antenna (× 1)
• AC plug adaptor (× 1) (Not supplied for USA, Canadian, European, Australian and Saudi Arabian models.)
If anything is missing, consult your dealer immediately.

- Prepare the remote control**
When you use the remote control for the first time, pull out the insulation sheet.

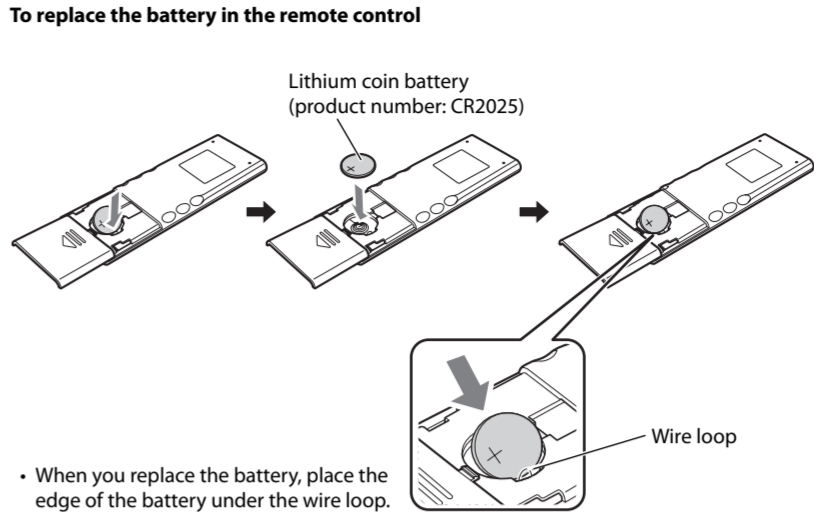

- NOTES:**
- Store the battery in a place where children cannot reach. If a child accidentally swallows the battery, consult a doctor immediately.
 - To prevent the battery from overheating, cracking, or starting a fire:
 - Do not recharge, short, disassemble or heat the battery or dispose of it in a fire.
 - Do not leave the battery with other metallic materials.
 - Wrap the battery with tape and insulate when throwing away or saving it.
 - Do not poke the battery with tweezers or similar tools.
 - Dispose of battery in the proper manner, according to federal, state, and local regulations.
 - The battery (battery pack or battery installed) shall not be exposed to excessive heat source such as sunshine, fire or the like.

CAUTION:
Danger of explosion if battery is incorrectly replaced. Replace only with the same or equivalent type.

- In this manual...**
- The remote control buttons are used for explaining the operations unless mentioned otherwise. However, if the System has the same or similar button names, they can also be used for the operations.
 - "File" and "track" are used interchangeably.
 - All the illustrations of the display used as examples are from the European models.

Connections

Do not connect the AC power cord until all other connections have been made.

- NOTES:**
- Make sure the antenna conductors do not touch any other terminals, connecting cords or the power cord. Also, keep the antennas away from metallic parts of the System, connecting cords, and the AC power cord. Otherwise, it could cause poor reception.

FM antenna (supplied): Extend it so that you can obtain the best reception.

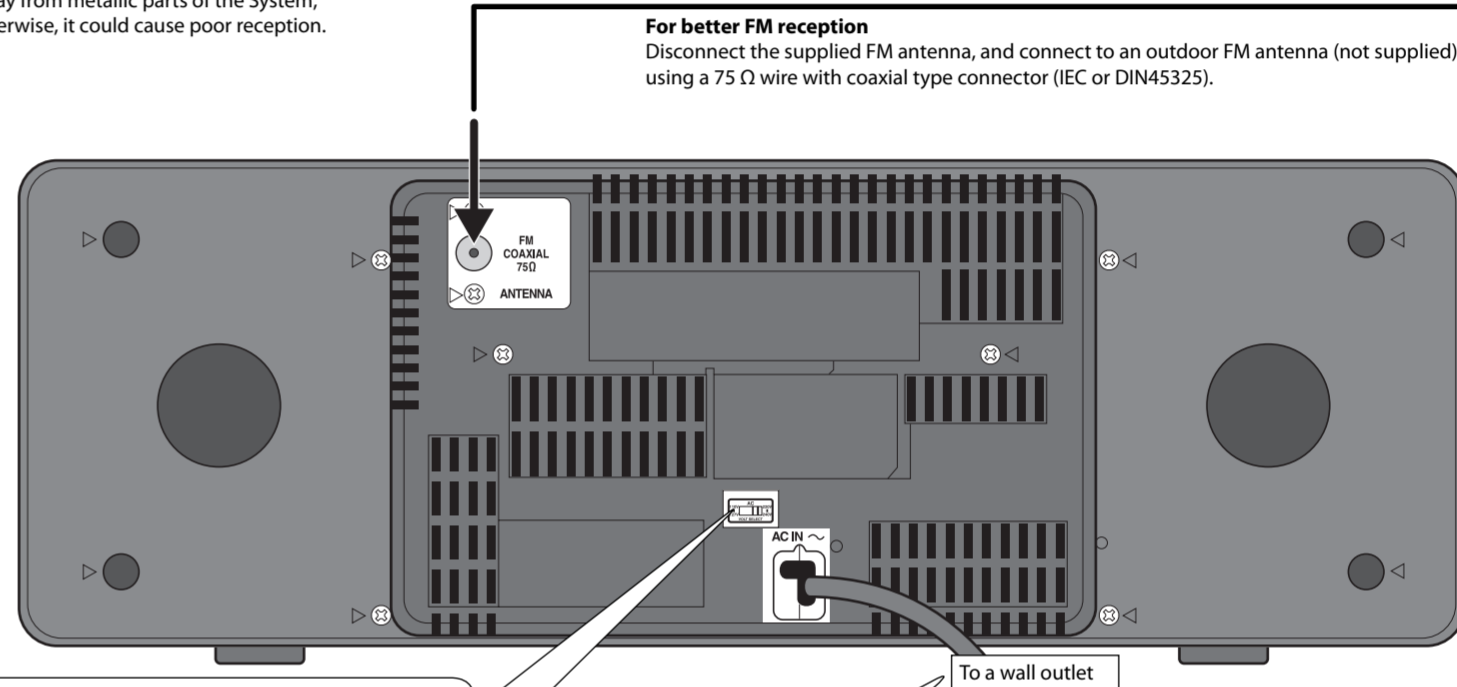

If the wall outlet does not match the AC plug, use the supplied AC plug adaptor. (Not supplied for USA, Canadian, European, Australian and Saudi Arabian models.)

Mains (AC) Line Instruction (Asia and Saudi Arabia only)

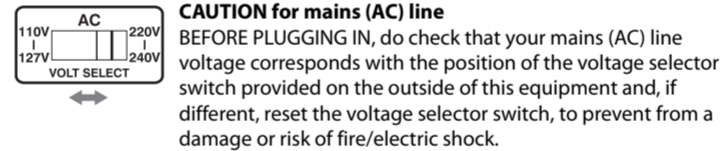

Sound and other adjustments

Initial settings

- Setting the clock**
You can set the clock only when the System is turned off (on standby).
1 **CLOCK** (Hold) → The clock display is flashing. If you have already set the clock before, press and hold **CLOCK** until the clock is flashing.
2 **Adjust the hour and minute.** → The time is displayed for a few seconds. If there is a power failure The clock loses its settings. You need to set the clock again.
- The clock may gain or lose 1 to 2 minutes per month. You may need to readjust the clock periodically.

- Timer**
Sleep Timer
You can set Sleep Timer only when the System is turned on.
1 **CLOCK** (Hold) → SLEEP 10
2 **Specify the time.**
SLEEP 10 → SLEEP 20 → SLEEP 30 → ... → OFF
• To check the remaining time until the System shuts off, press and hold **CLOCK**.

- Display settings**
Display information
To display ID3/WMA tag information During playback of MP3/WMA...
ID3 ON ↔ ID3 OFF
ID3/WMA tag information is displayed automatically as follows:
Group → File → Title
Album ← Artist

- Sound adjustments**
Fade muting
To drop the volume in a moment
• To restore the volume, press again or adjust the volume.
Hyper Bass Sound (HBS)
To reinforce the bass sound
HBS ↔ Canceled
- Sound Mode**
To select the sound mode suitable for your favorite music.
ROCK → POP → CLASSIC
JAZZ ← Canceled (No indication)

Precautions

- Notes on the power cord**
- When you go away for an extended period of time, remove the plug from the wall outlet.
 - When unplugging the System from the wall outlet, always pull the plug, not the power cord.
 - Do not handle the power cord with wet hands.
 - Disconnect the power cord before cleaning the System or moving the System.
 - Do not alter, twist or pull the power cord, or put anything heavy on it, which may cause fire, electric shock, or other accidents.
- Avoid moisture, water, dust, and high temperatures**
- Do not place the System in moist or dusty places.
 - If water gets inside the System, turn off the power and remove the plug from the wall outlet, then consult your dealer. Using the System in this state may cause a fire or electrical shock.
 - Do not expose the System to direct sunlight or place it near a heating device.

- Notes on installation**
- Select a place which is level, dry and neither too hot nor too cold—between 5°C and 35°C (41°F and 95°F).
 - Do not install the System in a place subject to vibrations.
 - Do not put heavy objects on the System.

- To prevent malfunction or damage to the System**
- Do not insert any metallic objects, such as wires, hairpins, coins, etc. into the System.
 - Do not block the vents.

There are no user-serviceable parts inside. If anything goes wrong, unplug the power cord and consult your dealer.

For customer use:
Enter below the Model No. and Serial No. which are located either on the rear, bottom or side of the cabinet. Retain this information for future reference.

Model No. _____

Serial No. _____

Compatible iPod models

iPod model	Audio
iPod nano	✓
iPod nano (2nd Generation)	✓
iPod nano (3rd Generation)	✓
iPod nano (4th Generation)	✓
iPod nano (5th Generation)	✓
iPod mini	✓
iPod mini (2nd Generation)	✓
iPod (4th Generation)	✓
iPod classic	✓
iPod photo (4th Generation)	✓
iPod video (5th Generation)	✓
iPod touch	✓
iPod touch (2nd Generation and Fall '09)	✓

If iPod does not play correctly, update iPod software to the latest version.
• For details about updating iPod, check on the Apple web site <<http://www.apple.com>>.

Maintenance

- To get the best performance of the System, keep your discs and the mechanism clean.
- Handling discs**
- Remove the disc from its case by holding it at the edge while pressing the center hole lightly.
 - Do not touch the shiny surface of the disc, or bend the disc.
 - Put the disc back in its case after use.
 - Be careful not to scratch the surface of the disc when placing it back in its case.
 - Avoid exposure to direct sunlight, temperature extremes, and moisture.

To clean the disc:
Wipe the disc with a soft cloth in a straight line from center to edge.

- Cleaning the System**
- Stains should be wiped off with a soft cloth. If the System is heavily stained, wipe it with a cloth soaked in water-diluted neutral detergent and wrung well, then wipe clean with a dry cloth.
 - Since the System may deteriorate in quality, become damaged or get its paint peeled off, be careful about the following:
 - DO NOT wipe it hard.
 - DO NOT wipe it with thinner or benzene.
 - DO NOT apply any volatile substances such as insecticides to it.
 - DO NOT allow any rubber or plastic to remain in contact for a long time.

Troubleshooting

- If you are having a problem with your System, check this list for a possible solution before calling for service.
- General**
- Power does not come on. → Power plug is not inserted securely. Plug it in securely.
 - Adjustments or settings are suddenly canceled before you finish. → There is a time limit. Start the procedure again.
 - Unable to operate the System from the remote control. → The path between the remote control and the remote sensor on the System is blocked. → The battery is exhausted.
 - No sound is heard. → Headphones are connected.

FM radio

- Hard to listen to broadcasts because of noise. → Antenna connection is incorrect or loose. → The FM antenna is not properly extended and positioned. → Electrostatic discharge from your body may cause noise. If this happens, turn the System off then on again.

- iPod**
- The iPod does not play, but "IPOD" appears on the display. → The iPod battery is low or exhausted. Charge the iPod battery.
- Disc/USB**
- The disc/USB mass storage class device does not play. → The disc is placed upside down. Place the disc with the label side facing up. → The disc is recorded using "packet writing (UDF file system)." It cannot be played. → The USB mass storage class device is not connected properly.
 - "NO SONG" appears on the display. → MP3/WMA files are not recorded on the disc or USB mass storage class device.
 - ID3 Tag on an MP3 file cannot be shown. → There are two types of ID3 Tag—Version 1 and Version 2. This System can only show ID3 Tag Version 1. → Playing order is determined when the groups and tracks are recorded. It depends on the writing application.
 - Groups and tracks are not played back as you expect.
 - The disc/USB mass storage class device sound is discontinuous. → The disc is scratched or dirty. → MP3/WMA files have not been properly recorded onto the USB mass storage class device.
 - Sound from the USB mass storage class device is interrupted. → Noise and static electricity may stop the sound. In this case, disconnect and connect the USB mass storage class device again after turning off the System.
 - The disc tray does not open or close. → The AC power cord is not plugged in. → Disc ejection is prohibited. "DISC LOCKED" appears (see "Prohibiting disc ejection" in "Disc/USB" on page 2).

- Recording**
- Unable to record onto a USB mass storage class device. → The capacity of the USB mass storage class device is full. → The USB mass storage class device is write-protected.
- If the System does not work correctly, disconnect the AC power cord from the wall outlet, wait for a while, then connect the cord again.
• JVC bears no responsibility for any loss of data in USB mass storage class device or iPod while using this System.

Basic operation

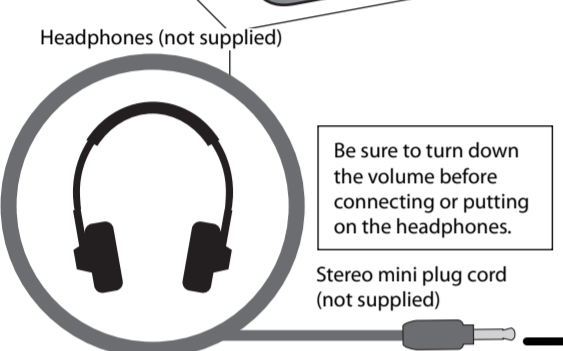
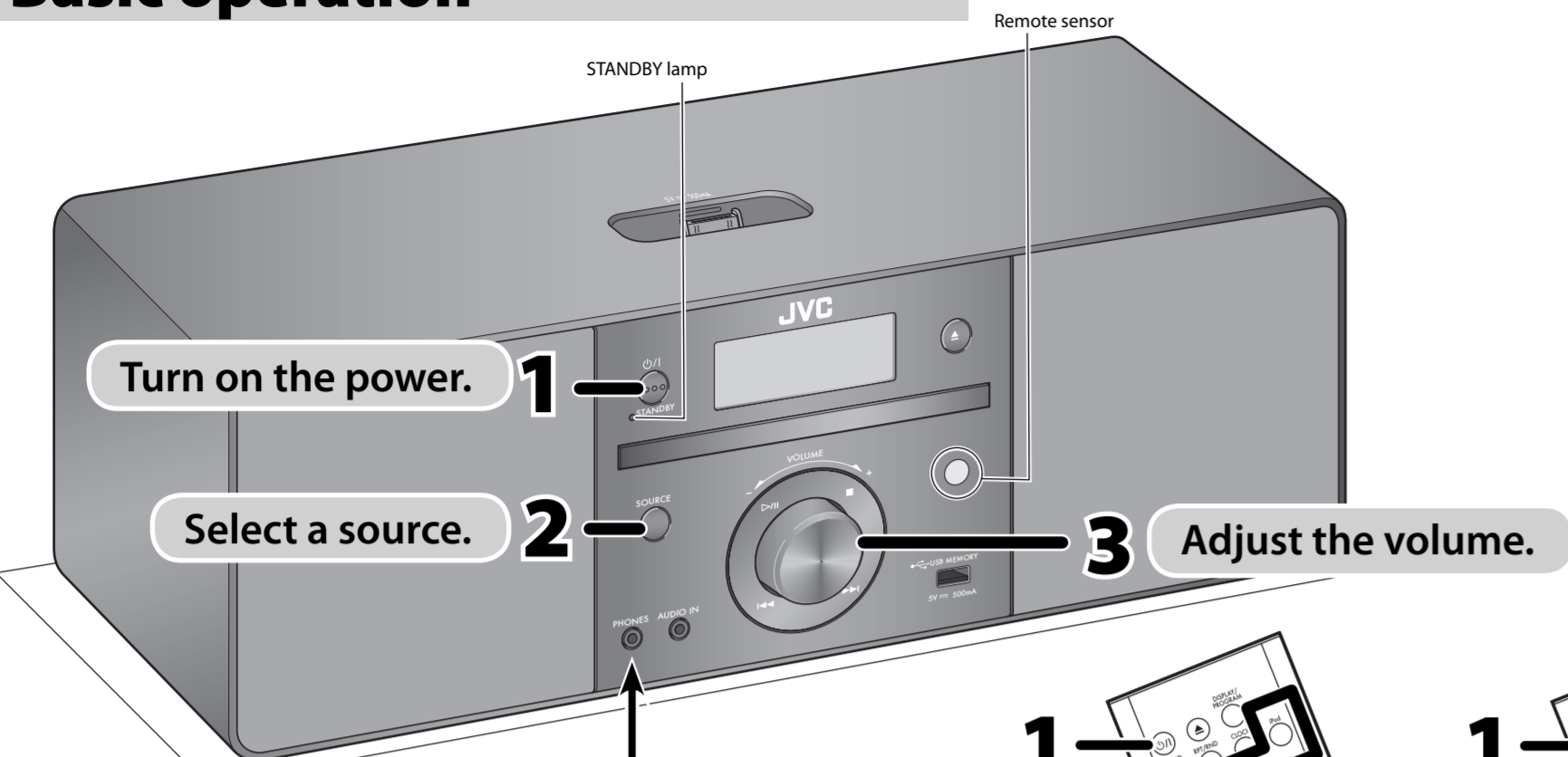

DO NOT turn off the System with the volume set to an extremely high level; otherwise, the sudden blast of sound may damage your hearing, speakers, and headphones when you turn on the System or start playback.

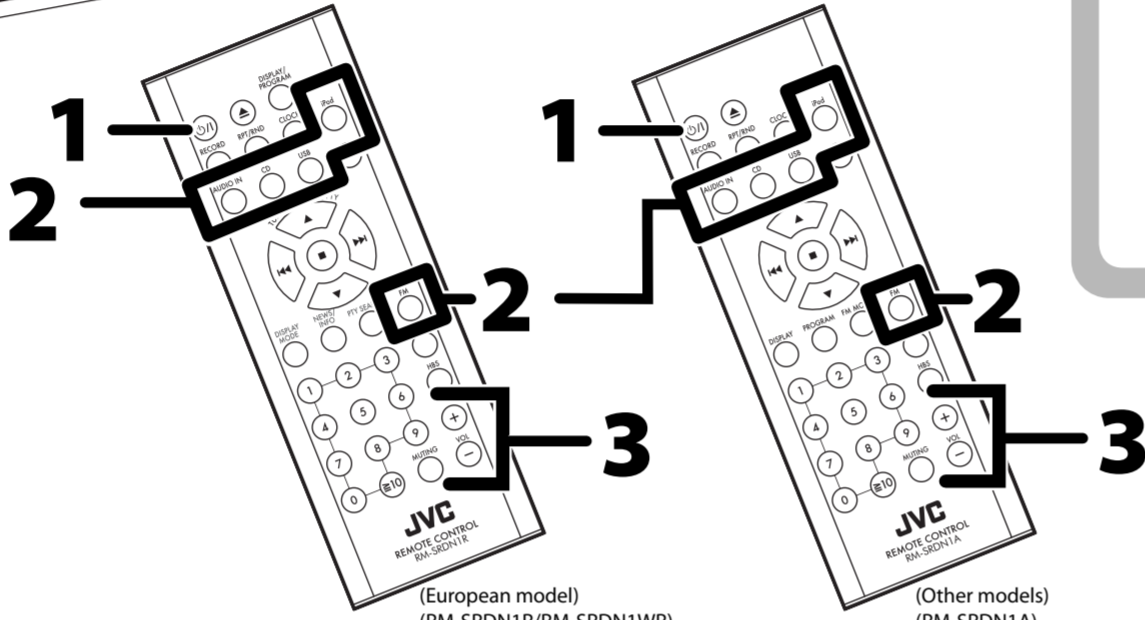

Searching for stations

1 **FM**

2 (Hold) (Hold)

The station search stops when a station of sufficient signal strength is found.

- To manually stop the search, press or .
- When you press or repeatedly, the frequency changes step by step.

Improving the reception

When an FM stereo broadcast is hard to listen...

(European model) (Other models) MONO MONO ST

- When the monaural mode (MONO) is activated, the reception is improved. However, the stereo effect is lost.
- When the stereo mode (ST) is activated, you can listen to the radio in stereo when a program is broadcast in stereo.

Presetting stations

You can preset up to 20 FM stations.

While listening to a target station...

1

2 Select a preset number.

3

To select a number, see "How to select a number using the remote control" in the bottom left of the page.

Tuning in to a preset station

- You can also use number buttons on the remote control.

Receiving FM stations with Radio Data System (Europe only)

Radio Data System allows FM stations to send an additional signal along with their regular program signals.

- If you want to know more about Radio Data System, visit <http://www.rds.org.uk>.

To display the Radio Data System information

PS (NO PS*) → PTY (NO PTY*) → RT (NO RT*)

Frequency (No-radio Data System signal)

* Displayed if related signals are not sent by a station.

PS (Program Service)	Commonly known station names.
PTY (Program Type)	Types of broadcast programs.
RT (Radio Text)	Text messages the station sends.

When the System finds the one you have selected, that station is tuned in.

- To stop searching, press **PTY SEARCH**.
- To search for another station, press **PTY SEARCH** while the indications are flashing.
- If no program is found, "NO FOUND" appears.

Switching temporarily to a program of your choice automatically (Europe only)

The Enhanced Other Networks function allows the System to switch temporarily to a preset FM station broadcasting a program of your choice (NEWS or INFO).

While listening to the FM station...

NEWS → INFO

← Canceled (No indication)



External device connection

Stereo mini plug cord (not supplied)

Playback operation

1

2 Start playback of the external device.



iPod connection

Dock adaptor (supplied with the iPod or sold separately)

Notes on iPod connection

- When detaching the dock adaptor from the dock, pull up the dock adaptor with your fingernail or sharp pointed tool using the slot.
- Be careful not to injure your fingertips or damage the terminal of the direct dock.
- DO NOT connect or disconnect the iPod when the System is turned on.
- Be sure to reduce the volume on the System to the minimum level before connecting iPod. Adjust the volume after starting playback.
- You cannot send any data to the iPod from the System.
- Do not carry the System with iPod connected. It might cause damage to the dock or you might drop the iPod.
- Do not touch or hit the iPod terminal pins or connector pins in the iPod dock directly. Doing so might cause damage to the connector pins.
- iPod is charged through the dock when the System is turned on.

Playback operations

* Information shown on the display differs depending on the type of the iPod.

To play back/pause iPod
Press .

To select a track
Press or .

To fast-forward a track
Press and hold .

To fast-reverse a track:
Press and hold .

To play back repeatedly
Press **RPT/RND** repeatedly.

To put iPod in sleep mode
Press and hold .



How to select a number using the remote control

Examples:

- To select number 5, press 5.
- To select number 20, press ± 10 , 2, then 0 (when "-" appears), or press ± 10 , 0, 2, then 0 (when "-" appears).
- To select number 125, press ± 10 , 1, 2, then 5.

Disc/USB connection

Label side

USB mass storage class device

Notes on USB mass storage class device connection

- Connect a USB mass storage class device when the System is turned off to prevent malfunction.
- Do not use a USB hub.
- When connecting with a USB cable, use a USB 2.0 cable whose length is less than 1 m (39-3/8 inches).
- The USB mass storage class device is charged through the USB MEMORY terminal when "USB" is selected as the source. (Some USB mass storage class devices may not be charged through the USB MEMORY terminal even if "USB" is selected as the source.)
- You cannot connect a computer to the USB MEMORY terminal of the System.
- Electrostatic shock at connecting a USB mass storage class device may cause abnormal playback of the device. In this case, disconnect the USB mass storage class device then reset the System and the USB mass storage class device.
- While playing back or recording a file onto a USB mass storage class device, do not disconnect the device. Doing so may cause malfunction on both the System and the device.

Prohibiting disc ejection

You can lock the disc tray so that no one can eject the loaded disc.

While the disc tray is closed... (On the main unit)

and (hold for 5 seconds at the same time)

DISC LOCKED ↔ DISC UNLOCKED

- When you lock the disc tray, "DISC LOCKED" is scrolled on the display. "DISC UNLOCKED" is scrolled on the display when you unlock it.

Playback operations

To open the disc tray
Press .

To play back/pause a disc or USB mass storage class device
Press .

To select a track
Press or .

To fast-forward a track
Press and hold .

To fast-reverse a track
Press and hold .

To select a group (MP3/WMA only)
Press or .

To stop playback
Press .

Repeat Play

During playback...

→ REPEAT1 → REPEAT

← Canceled (No indication) ← REPEAT GROUP (MP3/WMA only) ←

REPEAT 1	Repeats the current track.
REPEAT	Repeats all tracks.
REPEAT GROUP	Repeats all tracks in the current group (MP3/WMA only).

Random Play

1 Select a source and stop playback.

OR

2

→ REPEAT1 → REPEAT

← Canceled (No indication) ← REPEAT GROUP (MP3/WMA only) ←

Playback starts in a random order. Random Play ends when all tracks have been played.

- You cannot select a track with the number buttons during Random Play.

Program Play

1 Select a source and stop playback.

OR

2

3 Select a track number (up to 32 tracks).

For audio CD:

For MP3/WMA:

(1) Select a group.

(2) Select a track.

4

- To erase the entire program, press repeatedly.

Recording operations

Before you start recording

- It should be noted that it may be unlawful to re-record pre-recorded tapes, records, or discs without the consent of the owner of copyright for the sound or video recording, broadcast or cable program and for any literary, dramatic, musical, or artistic work embodied therein.
- The use of the files recorded on a USB device with this System, except for personal use, is prohibited. Transferring or selling the files you recorded violates the copyright law and may subject you to civil and criminal penalties for copyright infringement.
- The volume and sound adjustments (see page 1) do not affect recordings.
- Random Play and Repeat Mode are canceled during recording.
- Tracks which are recorded onto a USB mass storage class device will be converted into MP3 format (at a sampling rate of 44.1 kHz and bit rate of 128 kbps.)

Recording from a Disc

You can record tracks from an Audio CD to a USB mass storage class device.

Before recording...

Connect a recordable USB mass storage class device to the USB MEMORY () terminal.

1 Select CD as a source and stop playback.

2 Start recording.

(twice)

Erasing a track

You can erase tracks on the USB mass storage class device.

- Once the track is erased, you cannot resume it.

Before erasing...

Connect a recordable USB mass storage class device to the USB MEMORY () terminal.

1 Select USB as a source and start playback.

2 Select a track you want to erase.

3 Erase the track.

(twice)